



"Rite in the Rain"

ALL-WEATHER
LEVEL

Notebook No. 311

Zacpetén
Str. 55
Structure 606 b
Don's original research
Excavation

Notes

- Tim Augh -
- 1995 -



Recyclable

"Rite in the Rain" - A unique All-Weather Writing paper created to shed water and enhance the written image. It is widely used throughout the world for recording critical field data in all kinds of weather.

Available in a variety of standard and custom printed case-bound field books, loose leaf, spiral and stapled notebooks, multi-copy sets and computer papers.

"Rite in the Rain" All-Weather Writing Papers are also available in a wide selection of rolls and sheets for printing and photocopying.

a product of
J. L. DARLING CORPORATION
TACOMA, WA 98421-3696 USA



Name _____
Address _____
Phone _____
Project _____

Yellow Polyethylene Protective Slipcovers (Item #31) are available for this style of notebook. Helps protect your notebook from wear & tear. Contact your dealer or the J. L. Darling Corporation.

Str. S6

- Level 01 - brown laminar wood small limestone (<10cm) - calcareous
- Level 02 - collapse
- Level 03 - grey silty clay
- Level 04 - floor outside of structure
- Level 05 - grey brown to grey food wood limestone (medium sized inclusions)
- Level 06 - dm Fea 01 only collapse/brown level. Medium sized limestone with bones
- Level 07 - dm Fea 01 only collapse/brown with eastern part of side stone
- X = unexcavated level
- 1414 = level not encountered in this unit
- Level 08 - dm Unit 17 a feature of reddish brown soil located in a disturbed area of the stairway
- Level 09 - dm Unit 18 a layer of grey to grey brown soil at the base of the platform wall (probably an eroded surface)

* See page 10*

Zacpatan Str. 55 July 13, 1995

We actually began yesterday, but which would involve clearing and laying in the base of the grid system.

Structure 55 is part of Group A and may be only part of a larger structure, but we know

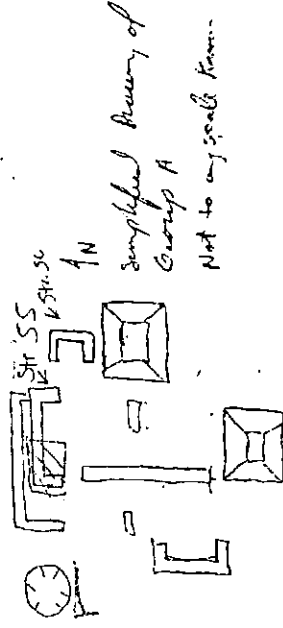

We began the day by furnishing the grid we began yesterday.

This excavation will differ from that of Str. 168 at Cahalum because it has made all of my doubts the exact same level to avoid the confusion that we encounter in those excavations.

I will have, refer to the units in B13 under group because that method seemed to work rather well. Again, all units and groups (units 1A and groups 3A-E) will be referred to by their NE corner

Level 01

July 13, 1995 Group 109, 203

I expected this excavation to be the same as Cahalum with the effort level being a top of collapse which would be on top of the floors, benches etc. However, quickly, in unit 107, 203 we hit plaster on top of the bench. There were stones in this level (01), but not enough to call it collapse.

At any rate Level 01 is a thin stucco layer with small limestone inclusions. I expect that this level will rest on top of brick the structure and collapse. I think that this structure may be somewhat like well preserved like Str. 168 of Cahalum.

I have decided to go ahead and excavate the collapse of Group 109, 203 right after the stucco since some of the stucco is on the floor. See page 6.

107	199	107
201	202	203
105	105	105
201	203	203
107	107	107
201	202	203

Group Elevation

32	27	35
34	12	35
38	20	48

Group

52	39	40
37	35	33
40	40	62

Group 106, 203 July 13, 1995

This portion of level 01 is on top of the west wall and western bench in the middle of the wall/bench. Note that below level 01, part of the plaster of the bench surfaces was recovered at 62 BS in 109 203, but it was very fragmented and only in a small part in the SW corner.

Level 01

106	106	104
201	202	203
105	105	105
201	202	203
104	104	104
201	202	203

Opening Depths

50	36	50
60	48	58
66	55	61

Closing Depths

55	50	60
70	80	62
80	57	62

Group 103, 203 July 13, 1995 Level 01

This portion of level 01 is at the southern end of the western wall/bench and is on top of both of these structures.

103	103	103
201	202	203
102	102	102
201	202	203
101	101	101
201	202	203

Opening Depths

84	52	55
87	55	58
103	90	100

Closing Depths

89	61	68
99	66	75
113	100	112

Group 109, 203 Level 02 T1
7/13/95

107	109	109
201	202	203
108	106	106
201	202	203
107	107	107
201	202	203

Dr. Wang, I'd know that 109, 201 level 01 embedded at 52 cm bd. The point is, this was a base point at the collapse level, right? Above this, then exactly open level level 02 just after I excavated level 01 rather than writing until we clean the whole structure for two reasons.

32	37	
37	35	33
40		None

First of all, we uncovered plaster below level 01 in some of the units; Stefan, Chris, and I was already exposed. Second, I want to maximize the number of units completely exposed and we need to begin on day 1 (on day 2)

52	53	
47	49	47
52		None

Well, we are excavating plaster below level 02 in units 109, 201 and 108, 201... This material is outside of our structure and must be part of the C-stage to the west of this structure.

Group 109, 206 Level 01 TP
7/13/95

109	109	109
204	205	206
101	108	108
204	205	206
107	107	107
204	205	206

This material is located on top of the north wall and bench. The northwest corner of this group is located 2+ meters east of the northwest corner of the structure.

17	16	16
30	34	28
49	46	54

Note that in 107, 206, the south half of the wall lateral with the plaster floor of the structure and in the northern part there was full and intricate staves of the bench but no plaster surface was present. I expect that the other 107 units with the same and will note if otherwise.

18	72	22
41	36	36
91	91	91

7/13/95
Group 106, 206 Level 01 TP

The group is not located in a wall - bench but is just east of the west bench and south of the north bench

106, 206 terminated at ballast and

the floor appears to support crest tube for growth. This was not true as we encountered floor (plastic) in 106, 204 and 104, 204, but these crests are adjacent to the edge of the bench.

However most of the units terminated with ballast including 106, 206; 105, 206; 105, 205 and 104, 205 and an most seem what is going on in 104, 206 and then may be tumble here.

106	106	106
204	205	206
105	105	105
204	205	206
104	104	104
204	205	206

Opening	Depth
67	75 83
X	93 91
87	93 97

Opening	Depth
91	92 95
X	92 104
100	98 105

General Notes 7/13/95

Sta 55 of Zappeta is different in both construction and deposition than structure 188 of Cambrian. End of all the walls of Zappeta structure 55 are constructed with rows of facing stones

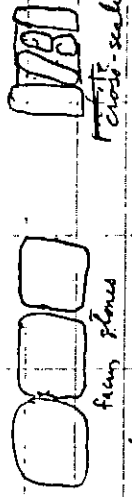

while Cambrian is composed of laid stone with a rubble core



Which is better you ask? Well... although I am intrigued by Zappeta, Cambrian's 55, 188 is definitely better constructed than Zappeta's 55. This leads to a second point - there is hardly any collapse at Zappeta - I thought there was some - normally on the outside of the structure in question. Actually, hardly any - no too strong of a statement. Let's just say - as will be demonstrated by the depth of bed 02 at back of pit in some areas - that the walls of Sta 55 were not much higher than what remains of them. This is further supported by the fact that the construction method used - Zappeta could not have supported a wall that is 30' high.

of also now which that word of Cambrian collapse level (bed 02) was a P.M. column - see Camb. p. 54

General Notes 7/14/95

Well... I didn't really say what we were going to do yesterday so... We have dug in a 9x12m grid on 181 meter units and 3x3m groups of units on top of the western half of Structure SS.

Structure SS is a C-shaped structure which appears to be the culminated hall in a Postclassic temple assembly. The structure is 24 meters long and about 8-9 meters wide which exhibits the platform. Behind Structure SS is another structure which is also C-shaped.

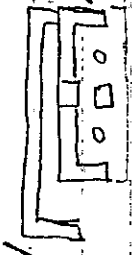

We do not know the relationship of these two structures and probably will not even after the excavation as I will not excavate the inner northern structure (though we have picked up its floor along the northern and western wall of structure SS).

The purpose of our excavation here is to examine half of the culminated hall in regard to its construction and disposition in relation to compare it to other such structures.

Note that our grid is 90° east of north and the structure appears as the grid to be oriented about the same (at least in the grid to match the structure).

Group 109, 209 Lead 01 JF
 This group is located on top of the north wall of bench

109	109	109
207	208	209
109	108	108
207	208	209
107	107	107
207	209	209

Opening Depths		
9	5	9
35	29	7
52	53	40

Closing Depths		
19	20	10
X	31	26
X	64	X
	98	

Bury 109, 212 Level 01. TP

109	109	109
210	211	212
108	108	108
210	211	212
107	109	107
210	211	212

Opening Panel		
8	0	10
18	23	34
64	56	59

Closing Panels		
10	7	12
18	X	34
60	X	53
96	X	87

Group 109, 206 Level 02. TP

July 14, 1995

This group of emb. nests on top of the mud wall and bench. Note that the 107N emb. hatched out at

the base of level 01. An emb. 108, 206 was excavated level 02, but cannot exceed level 02 because of "the rules". However, we caught part of the bench surface (plastered) in 108, 206 at 46 b2

109	109	109
204	205	206
108	108	108
204	205	206
107	107	107
204	205	206

Opening		
18	22	22
None	36	26
None	X	None

Closing		
48	X	X
None	45	44
None	X	None

Group 103, 206 Level 01 TP

July 15, 1995

This group is east of the west bench
 in an area that appears disturbed along
 the south wall of the unit. Units
 101, 201 and 101, 205 seem particularly
 disturbed (probably a fire fall)
 It appears that there is really
 subtle here in the front of the
 structure - see page 20:

103	103	103
204	205	206
103	102	102
204	205	206
101	101	101
204	205	206

80	83	90
75	98	96
124	123	110

102	100	99
100	114	114
142	130	127

Group 106, 203 Level 02

July 24, 1995

This is collapse on the wall
 east of the west of the wall. In the
 most part this - say, ...
 refers to the west wall. This
 level included material to
 the west of the west wall
 on top of the west bench
 The 205 units did not include
 any collapse as the debris layer
 (level 01) terminated at floor
 in ballast.

106	106	106
201	202	203
105	105	105
201	202	203
104	104	104
201	202	203

Opening		
55	50	66
70	48	62
80	57	62

Closing		
59	59	59
67	67	67
100	67	100

Group 106, 203 level 03

July 24, 1995

Shows a gray silty clay with transition unconsolidated which ties to the center of the 2nd tier of our favorite west well... I don't

know if this is full or washed, but it is very soft soil so I really don't think that it is full. This

is some character in it (sample taken) so the gray color may have something to do with ash included with the material

I have interpreted this level as a layer of garbage because of the waxy appearance of the soil

106	106	106
201	202	203
105	105	105
101	102	103
104	104	104
201	202	203

Opening	more	more
	more	more
100	100	100

Closing	N	N
	N	N
103	N	N

Group 106, 212 Level 01

July 24, 1995

This gray is on top of what appears to be an altar in the center of the structure July 26, 1995

is a the most part ash spreads were rather dull. The 106 N and 212 F units ended with ballast while the rest ended with the shims - collapse

from this structure. This structure is quite disturbed by roots. I have difficulty defining the northern corner of the

shim as this portion appears to be collapse (?). Note that the antipast were recessed in the excavation of 105, 210 level 01;

however, that (as with most of the units associated with the shims) simply involved clean leaves and a little soil from between articulated stones and timble.

106	106	106
210	211	212
105	105	105
210	211	212
104	104	104
210	211	212

Opening	82	80	78
	69	81	81
	65	65	85

Closing	97	90	73
	75	71	94
	72	70	97

Group 106, 209 Level 01 ATP

July 24, 1995
This ~~gang~~ gang to the south of the main
court bench. Sorry. I knew
I should see into this gang is
also part to the west of the
altar in the middle of the
structure.

106	106	106
207	208	209
105	105	105
207	208	209
104	104	104
207	208	209

Opening

84	80	85
93	90	92
97	100	90

Closing

93	96	96
106	97	103
100	105	102

Group 103, 209 Level 01 TP

July 24, 1995
The first wall of the structure
means the "south wall" very early in
101 N units. An additional "wall"
was encountered that runs through
the 102 N units (at least in
this group), but was added in
unit 102, 208

103	103	103
207	208	209
102	102	102
207	208	209
101	101	101
207	208	209

93	93	88
94	93	94
112	115	130

100	105	105
107	103	109
108	104	105
140	147	163

General Notes July 24, 1995 TP

It would now appear that there is at least one and probably two step-like tiers in the front of St. SS.

One of the steps runs through the 103N units while the other runs through the 102N units.

There was a problem that caused a pit of floor appeared in 102, 205 at 114 bs as opposed to 102 bs in 103, 204 and

July 25, 1995

Extremely wet today... almost delirious... expect mistakes...

July 26, 1995

Interlocking note: The outer tier along the outer edge of the west wall is 97 cm bs and the interior floor is usually 96 cm bs. Maybe this part was constructed first, then the bench and walls were added. Sounds pretty reasonable. See page 25.

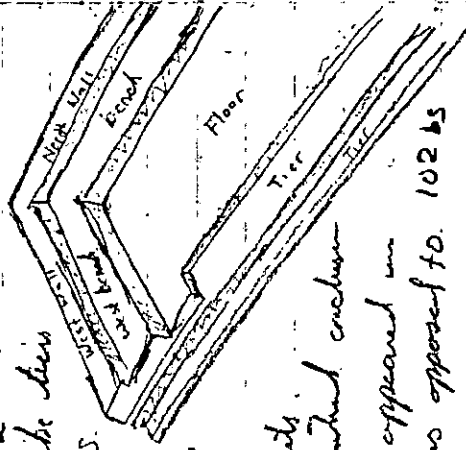

Group 109, 209 Level 02 TP

July 27, 1995

It has collapsed along the length with North that level did not expand. Two units in rows. How rather than alternate because there was a tier there - besides I need to compensate for my earlier indulgence and the narrowed corner (see group 109, 209)

109	109	109
207	208	209
108	108	108
207	207	207
107	107	107
207	207	209

11	20	10
X	31	X
X	41	X
X	51	X

51	10	X
X	41	X
X	31	X
X	20	X

Group 106, 212 Level 02 TP

July 25, 1995

This is collapse surrounding the shrine "shrine 'altan'" in

the middle of the structure July 26, 1995 (190 m. from group, 100 m. from 104, 209) we encountered

quite a bit of collapse which could have been a part of the

See shrine which was destroyed Anyway, we encountered a couple

of shrines with red designs painted on their colored

shards. This is worth noting because there are the only

one shrines so far which appear to be in a semi-prime

context with the exception of the unexcavated other ones

are with red painted designs in front 102, 201 to the west of the

west wall adjacent to the ledge Note that the shrine is horrible

mainly because of large roots from a big tree in group 103, 212. All of 196, 212 ended with

shrine, Ballast; floor (a patch in 105, 210) or note

106	106	106
210	211	212
105	105	105
210	211	212
104	104	104
210	211	212

Opening

97	90	93
90	79	94
135	79	94
130		97

Closing

106	106
210	211
105	105
210	211
104	104
210	211

Group 103, 203 Level 02 TP

July 25, 1995

with Remmy collapse from the side of the wall, we encountered a small

group of incense shades in 101, 201. It's strange because there are two

represented only a few shades from each This concentration was bugged as level 04

and some were mugged. The wall of west wall is

interesting because it is composed of large stones, between which are smaller stones. There is

a lower wooden step or platform when the wall

is on top of this. It is possible that the incense were placed on this

step; however, incense shades were only found in 101, 201 so.

We ended the level west of the wall when we hit floor outside

Ballast. East of the wall, we stopped at the bench surface or bench

fall

103	103	103
201	202	203
102	102	102
201	202	203
101	101	101
201	202	203

Opening

89	61	68
99	66	75
113	100	90
		115

Closing

X		
125	72	92
127	103	110
	103	110
	103	110



Group 109, 212 Level 02 TP

July 27, 1995

After 107 the removal of collapse which was present only in the 109N and 108N units. The

109N units rested on top of the north wall and to the north of that wall. The plaster surface to the north of the north wall was very fragmentary in these areas when it started it all because of heavy root disturbance. The 108N

units rested on part of the north wall and a portion of the bench to the south of the wall. For the most part, the plaster surface only existed within 20 cm of the north wall as the rest was eroded exposing ballast and sometime (toward to south) large fill stones. The bench portions of the 107N units were composed entirely of large fill stones while plaster floor existed adjacent to the bench wall.

109	109	109
210	211	212
109	109	109
210	211	212
107	107	107
210	211	212

Opening

10	12
18	34
none	none

Closing

43	42
37	39
none	none

Group 103, 212 Level 01

July 26, 1995

After group landed the south edge of the shrine and the 101N units lie in the top of the south wall. The unit (a) at least most of the are a problem because a large tree roots in the middle of the group (that why 102, 211 were not planned).

At any rate, these units all terminated at ballast a disturbed ballast. The 101N units also included a portion of the south wall as well as a part to the south of the south wall which reached several feet.

103	103	103
210	211	212
102	102	102
210	211	212
101	101	101
210	211	212

Opening

81	82	87
94		97
124	101	101

Closing above shrine

95	91	100
107		97
126	107	95
155	138	118

Struct. SS. Unit 17 TP

July 26, 1995

called unit 17 to match the rest of my test units, this is a 2.5 x 2.5 meter unit placed on the south part of the structure to connect the south platform wall and as possible stairway. The northeast corner of the unit is at 100, 211. I guess I could have called the unit 100, 211 but I want to distinguish it from the other units because it is so large. Why am I using such a large unit. First of all because I need to cover a large area. Second, 1.8 m would be encumbering on the slope and with all the trees. Finally, we are dealing with collapse only here, not a complete part of the structure. So I don't think there is a need for such a unit (let's hope the ceiling!). Note: this is a 2.5 x 2.5 because it fits (there are trees).

Level 01

Beginning NE 120; SE 222; SW 222; NW 155; 6/19/91. This is the layer of beams covering the collapse where should be against the south wall of the platform. This shows layers very thin, but it does appear that a stairway exists in the

northeast corner of the unit. We started level 01 when we hit a grey brown grey soil (level 10) the western 1 meter of the unit and tumble (2) the rest of the unit. See the plan view (base of level 01) Level 02

Level 02 is the area across as it always is - collapse. We were down on two walls, each running east to west. The mortar wall was higher than the south wall - see the plan view, but...

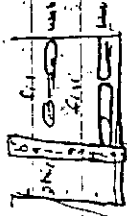

There were extremely thin about 1 cm thick scale of the platform. They would be fine, but... not that in unit 18, there was only 1 wall supporting the floor. So... maybe we missed up in unit 18 (instead of 2 masonry blocks), then as something different going on there. Perhaps the stairway is lined by three steps rather than one (I actually 3 steps onto the W. May is a dirt from but we need to excavate more to verify this. See page 35

Str. SS Unit 18 TP

July 26, 1995

Beginning NE 138 SE 262 SW 255 NW 147 CW 200

This is a second test pit, a 2x3 with the long axis N/S and the northeast corner say 100, 202. The purpose of the unit is to look at the side of this platform and to estimate the amount of collapse on the side of this platform.

Level 01

Beginning NE 138 SE 262 SW 255 NW 147 CW 200

Closing NE 145 SE 270 SW 262 NW 153 CW 212

Level 01 was, as always, the same every time. There was really nothing interesting about this material. We found a few nice Shand's but what would we expect from such a dry unit.

Level 02

Beginning NE 145 SE 270 SW 262 NW 153 CW 212

Closing NE 151 SE 277 SW 278 NW 163 CW 225

This is, as always, the collapse level. Now we see the platform. The checked unit was below the

collapse level because collapse just is not that interesting. Note, however, that we collected a mega domoid of shaly including some unconsolidated shales.

See page 37

Energy 106 207 Level 02

106	104	106
207	208	209
105	105	105
208	208	208
104	104	104
207	208	207

Opening

93	96	96
106	97	103
100	105	102

106	104	106
207	208	209
105	105	105
208	208	208
104	104	104
207	208	207

Energy 106, 206 Level 02

106	106	106
204	205	206
105	105	105
204	205	206
104	104	104
204	205	206

Opening

N	N	N
X	N	N
N	N	105

Closing

N	N	N
X	N	N
N	N	106

Group 103, 201 Level 02 TP

July 27, 1995

The only unit associated here was 101, 206 which began at 127 and ended at 130. This is located on the SW corner of what appears to be an interior platform (about 2-10 cm). See the plan view for details. Actually when appears to be the corner of the foundation.

Fea 01 TP

7/27/95

This is the same structure described in 106, 202. We are going to clean it and work out to see what is inside. The stone has been heavily disturbed by roots from a tree just to the south.

We will excavate in two sections

Level 06 in the section to the

west and Level 07 is a smaller section to the east.

Level 06

Beginning 74 BS

Closing 105 (north half) 118 (south half)

This was somewhat of a disappointment there was really not that much in this part. The thing will fall with collapse and roots (beginning). The entire area was surrounded by a stone enclosure which was not removed. We stopped when we were a little bit lower than the floor instead of Fea 01.

Level 07

Beginning 75 Closing 103

I am still not sure whether this is a part of Fea 1 or actually part of it.

Fea 1	N
Level 07	
Level 06	
	S

See the plan view for a better drawing

Sanbury letter. I think it is just another
 adobe collapse. I think the form is
 more likely because there was no floor
 (plaster level). This is a level. However, I
 think that this was an addition to the
 altar. At any rate, the eastern wall of
 the western side of the floor (level 06)
 clearly separates level 06 & 07. We dug
 a little into the fill (20 cm) to make
 sure we found the edge of the platform.

Note - It is possible that 104,209 also
 contained a part of floor 1 because
 there was a lot of collapse in the
 area. It is not more in the surrounding
 area. It is more a part of the
 feature it was nearby destroyed.

St. SS Unit 17 TP Level 05

July 28, 1995

Level 05 covered the stairway.

This material was a grey to grey
 brown soil (grey zone) or are approached
 the stain - probably from long distance
 plaster). There were six or seven
 stains, each about 20 cm wide, and
 10 cm high. We are on top of only the
 eastern 80 cm of the stairway, but of
 extent about 150-170 cm
 wide.

There are brackets on both sides
 of opening what it upper part is vertically
 raised - see the plan. Note that the
 center of the stain is disturbed and there is
 a deposit of reddish brown soil in this area.
 The brackets are possibly removed.
 If I have time, I will excavate it.

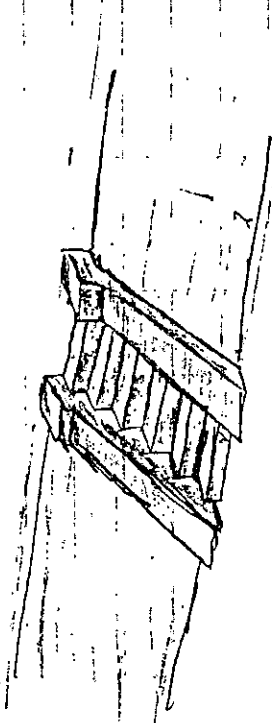

Zacpet Unit 17

Level 08

Beginning 210 bd

This is the reddest brown sand which forms a feature in the disturbed area of the stairway. This material was perforated and sealed.

at 220 bd. We took a sand sample of this material, all included a stone, and I think that it is possible that the color originated from this stone as the sand around it was in the deepest part. At any rate, we continued excavating into the fill of the stair unit. 152 bd when we hit larger fill stone and seemed to be below the level of the plaza floor.

Unit 18

Level 09

This is material under the collapse layer only to the south of the platform wall. It is a gray to grey brown sand with small limestone inclusions. I think that it will be the disarticulated plaza floor. We began at 275 bd. There were some interesting ceramics in the material, but nothing more. We closed out when we hit another wall running parallel with the original wall and the base of the side of the platform at 308 bd.

