

June 4, 2014

- Jessica 4000 - 4249
- Elsa 4250 - 4499
- Evelyn 4500 - 4999
- Darling 5000 - 5249
- Daybi 5250 - 5499
- Wil 5500 - 5749
- Vicky 5750 - ~~5800~~ 5899
- Tim ~~6000~~ ~~6100~~ 5900 - 5999
- Adolfo 6000 - 6249
- Miguel 6250 - 6499

  
 This notebook belongs to

1x1	1.41
2x2	2.83
3x3	4.24
1x2	2.24

Arrived last night and preparing to go see Justin at Macanche. My calculator is that he is at Latitude  $16^{\circ} 38' 31''$  N and Longitude  $89^{\circ} 36' 54''$  W for a magnetic declination of  $0^{\circ} 43' 59''$  E.

June 9, 2014

do the field at Nixon-Chichi. Justin is back at Macanche (with permission to map Muralla de Leon). Note to self - socks, shirts, pants.

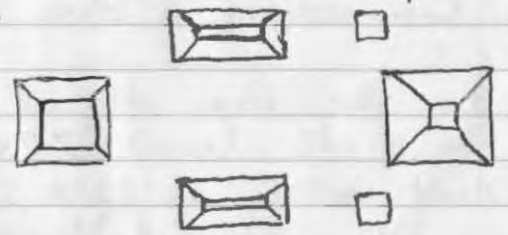

We are in the central group trying to map in the long low platform to the east of the main groups. We stayed three hours then went back to the lab (the mapping guys stayed).

People (Field)	Lab
x Daybi 1	Miriam
Will 1	Sheily
x Vicky 2x2	Marielena
x Darling 1	Cindy
E Miguel 1	Martita
x Elsa 2	Carolina
x Jessica 1	
x Evelyn 2	

3  
June 16, 14

Visited the site in the morning to fix a minor error. Things seem to be going well. Quick note to self: the major focus is to simply define the grid. Secondly is to define variation in the gridded and evidence of Teotihuacan.

July 1, 2014

Al Fin! We're diggin'  
On site for excavation. We currently have four units in progress and one laid out.

Evelyn is on the west side of Str. AA1 (the possible E-Group). She is in excavation group 4002, 4221 a 3x3m block. I had hope she would be more on the western edge but she is on the building itself. This is fine if not preferable.

Elsa is below the SE corner of what I am currently calling Str. Z2, but I am uncertain of the number. She is in a corridor at <sup>49</sup>4133, 3923. This is a 3x3m excavation.

Jessica is to the south of Elsa (also in a corridor) near an unnamed platform. She is at 3834 4124. This is a 3x3m excavation.

7/1/14 97590  
89 76.5  
81 77

4

Darling is in an aquada to the west of Structure Z1. He is doing a 2x2 which is at 4014, 3924. We hope to find evidence of water storage or ritual in this area. The datum is 9.145.945.

7/2/14

In Section Y, Darling continues his excavation in the aquada. He is finding more ceramics than the others, but they are eroded from above.

In Section Z, Elsa (at the base of the southeast corner of Z2) is beginning Level 2. Jessica continues L1 in her block at the southeast corner of Section JJ. Neither is finding many artifacts of any sort.

The guys continue to map in the southern part of the site. They are mapping to many points, but it is more of a guess. I will likely move Daybi to an excavation next week leaving Wil to continue mapping.

I took a brief walk after lunch and found that there is a series of low points that could be aquadas or could be sunken patios. I am uncertain of this point.

7/3/14

5

In the field - In the area of AA1/1, we are preparing for two additional units, one about 20 m to the west and the other on the eastern edge of the building.

Note that in ~~4202~~ 4202, 4221 on AA1/1, Evelyn recovered what appears to be part of a Postclassic image censor. If we find more, we may have evidence of Postclassic ritual in the ceremonial core.

At the base of Z2, Elsa is in Level 2. The artifact frequency has increased a little. She seems happy.

At the SE corner of Group JJ, Jessica continues in Level 1. The artifact frequency is still low.

In Section Y aquada, Darling continues. He is removing L3, which is a gray brown soil with ~~medium~~ small sized limestones. Level 4 has more stones and many are medium sized.



## Datums

	3720	<sup>3920</sup> 4136	4133		
• Elsa	3921,	4136		146.922	2
• Jessica	3834,	4124		145.87	2
• Darling	4014,	3924		145.945	1
• Daybe	3828,	4232		145.768	1
• Evelyn	4002,	4221		148.499	1
• Evelyn	3991,	4246		149.925	
• Tim	3999.5,	4198		146.598	
• Adolfo	3766,	4534		144.005	
• Miguel	4052,	4403		151.567	
• Elsa 2	3835,	4025		150.236	

do the field by boat. In AA1, 4002, 4221 Evelyn found an obsidian side notch point. It is very clear that there is Postclassic use of this area.

We did not bring the total station so Daybe started work on the west side of Sector LL (the south west, to be exact). ~~There was a lot of work done there but it was not recorded.~~

Jessica is in Level 2 and is recovering a <sup>relatively</sup> moderate amount of ceramics. L2 is this area is likely older eroded soil.

Darling continues in the aguada (Aguada 4) He is plowing through collapse (Level 4) onto another level of collapse (Level 5). The ceramic frequency is moderate (relatively high).

Elsa is ~~done~~ done with L1 and has begun L2 in Z2. She will continue searching for a surface.

7/9/14

in the field on a nice Wednesday.

Checking Elsa's corans

NE 3920, 4136

NW 3920, 11, 4133

SE 3917, 4136

SW 3917, 4133

there was a small error here made by the surveyors. She will correct it.

dn 3828, 4232 (Daybi) at the base of L2



we are finding what appear to be crude foundations of hard limestone. Below this we see traces of another construction that is at least partially composed of soft limestone.

dn 3920, 4136 (Elsa), we are at the base of L4 is two units and appear to be on an old surface.

dn 3834, 4124 (Jessica), she appears to have



a platform composed of cobbles at the base of L3 (about 30 cm bs) Que bueno!

dm 4014, 3924, Darling still has something odd going on in the western side of his unit. The stones are larger in that area and there is a line running roughly north-south.



Recall that we found what looked like a wall in this area earlier. However, I am not sure what this is. It could be <sup>larger</sup> stones that y-lled into the center of the aqueduct. I don't know.

dm 4002, 4221, Evelyn began removing the soft limestone collapse in search of walls and found a nice plaster floor in the eastern part of the block. Note that we can see vague outlines of a possible wall in the southern part of the unit though it could be collapse.

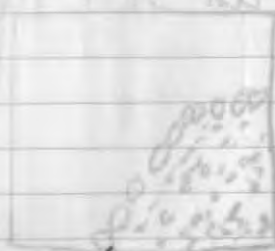
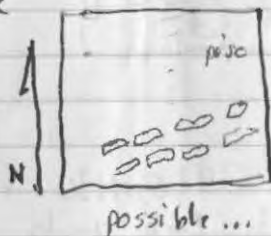

7/11/19

Back out on Friday after spending a day doing lab work and investigating the canals on Lake Petenitil.

dm 4002, 4221, Evelyn continues to follow the floor. <sup>(re-examined)</sup> On the east side of 4000, 4221 the plaster surface appears to be muddled and drops (to the east). This muddled area is on the platform - not on the edge - so we are uncertain what is going on.

dm 3920, 4136, Elsa is in Level 5. I think ~~there~~ there may be a frequent floor on top of this but I am uncertain.

dm 3834, 4124, Jessica has found a nice wall of blocks (soft limestone). Below the cobble surface to the west, she is uncovering a second wall of hard limestone rubble.





dm 4014, 3924, Darling is in Level 8. The unit is confusing as she has large rocks in the western 70 cm of the unit and small stones to the east (in a matrix of 10YR 4/2 soil). I will have him divide the unit in the next level.



dm 3928, 4232, Daybi has a wall running north/south

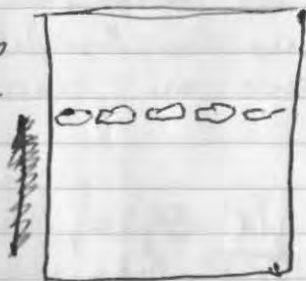

7/15/14

In the field - I closed Evelyn's excavation and she will be in the city a few days for the symposia. Nothing new has occurred since Friday though Daybi's unit is becoming quite complicated. He seems to be on the corner of a platform. There may be a wall in the western part of the unit as well.

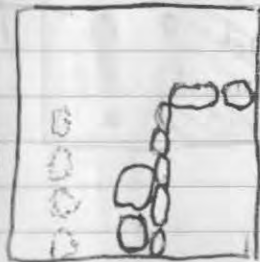

7/15/14

In Elsas block, she found the base of Level 5, where she hit material with more fragments of caliza (maybe an old floor). I think she has more eroded soil than Yessica so I think she will find similar deposits (to Yessica's) in a few days.

7/16/14

I decided to put in a couple of 50x50's. I don't recall any numbers at the moment so I will start at #90, why sondcos? This is the best way to find the <sup>distribution of</sup> Postclassic occupation.

Sondco #90

50x50 cm

40 cm deep

Lotz NS909

3721.43, 4564.67, 139.74

This sondco revealed 15 cm of huirus (very dark gray brown silty clay) followed by a fill of dark to very dark gray brown soil with small limestone inclusions. Artifacts occurred in a low to moderate frequency with sherds, chert, obsidian, and pomace present. Note that this unit occurred on a platform that currently has no name.

3834  
4124

7/15/14

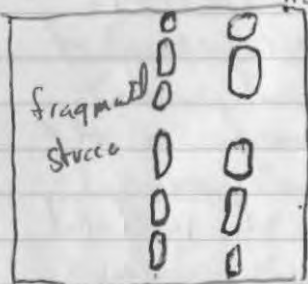

at around 8060 on 65,  
 Jessica still has the two  
 walls and a nice fragmental  
 floor to the west. She  
 has fewer artifacts because  
 she is removing the  
 cobble pavement, which logically  
 has fewer artifacts.

	M	T	W	TH	F	M (28)	W (13)
Donis	X	X	X	X	✓	✓	- ✓
Jose	-	-	-	-	-	-	-
Oscar	X	X	-	X	✓	✓ W	✓
Joson	X	X	X	X	✓	✓	- ✓
Victor	X	X	X	X	✓	✓	- ✓
Ronald	X	X	X	X	✓	✓ Y	✓
Delmo	X	X	X	X	✓	✓ Y	✓
Santi	X	X	X	X	✓	✓ D	✓
Alex	-	-	-	X	✓	✓ A	✓
Manolo	-	-	-	X	✓	✓	-
Gabriel					⊙	10 ✓	- ✓
Juan Papa (Christian)					⊙	" ✓	- ✓
<del>Christina</del>					⊙		

7/16/14

do the field after a poor night's sleep - too  
 much stress with so many needy oranges.  
 Tranquility will be here soon enough. It started  
 in the southeast portion of Vergara's land where  
 we are laying in an excavation on a building  
 that is yet unnamed. The 3x3 is located  
 at 3766, 4534.

With Elsa, she has a fragmental floor at the  
 base of L. In the southern  
 part of the west, there is an  
 odd rectangle of stone with  
 no floor inside. We will label  
 it as a floor. We are  
 also no longer excavating the  
 NE-corner of the 3x3



With Jessica on 3834, 4124. She is working  
 to the west of the nice caliza "wall" and has  
 found a floor. It is at a different level than  
 the floor to the east. I think it may be

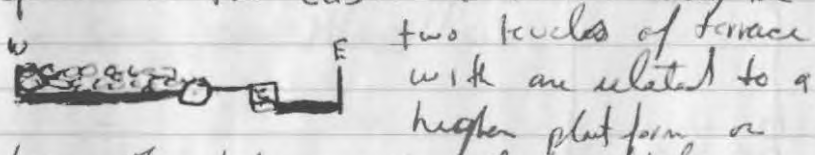

Structure. The later version of the higher  
 structure is composed of cobbles. The floor  
 below this is confusing, but undoubtedly  
 relates to an earlier structure.



7/17/14

So in the morning (a little late starting btw) out with Adolfo at 3766, 4534. He will begin excavation today. We on Adolfo's I.

7/18/14

Evelyn now has a nice black wall running north to south with a floor to the east. She is only about 30 cm bs.

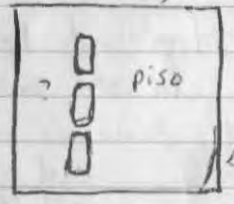

Note that Evelyn also opened at 3991, 4246

Note that ~~Justin is~~ Justin is on top of Structure BB1 with the other total station. He is shooting prismless to the east. This initially failed as he was only able to shoot a few points. So we moved to the southern edge of the Vergara's land. we were just to get some good shots.

In 3766, 4534, Adolfo is removing Level 1. He has rough traces of lines of stones to the west and to the south.

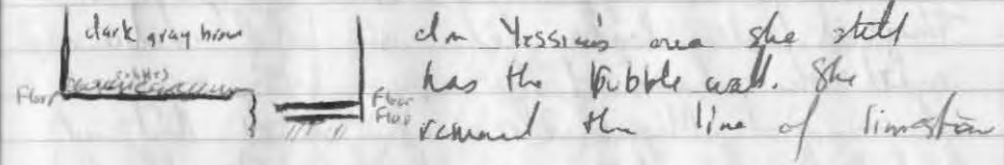
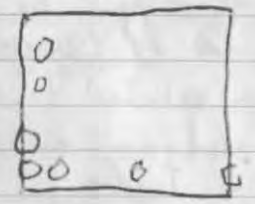

In Yossini's area she still has the rubble wall. She removed the line of limestone blocks that rested on the upper floor to the east. She removed that floor at Level 7a. We used "7a" as we dug a little deeper against the rubble wall which goes deeper than the next floor (in the eastern side of the unit. the next floor to the east seems to only occur in the middle 3rd of the eastern portion of the excavation.

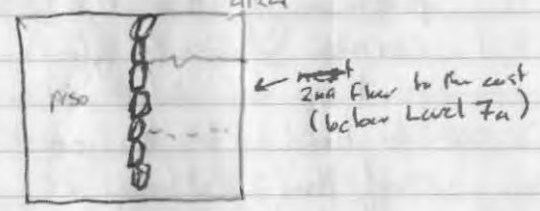

In Darling's area, he is excavating the Preclassic period midden. This midden seems to sit on a row of large stones that may be some sort of wall.



7/22/14

Yesterday I mapped up the sculpture at Teyasit. It looks like an old chert cap with the head of Hunapu. We mapped it in and Miguel drew it. Note that it had already been moved, but Osvaldo Gomez wanted us to map it in where it was.

At Nixtun-Chich' today and there is a bit of complexity. In Jessica's unit,

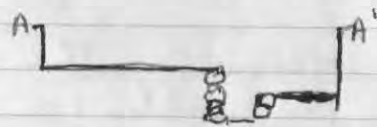
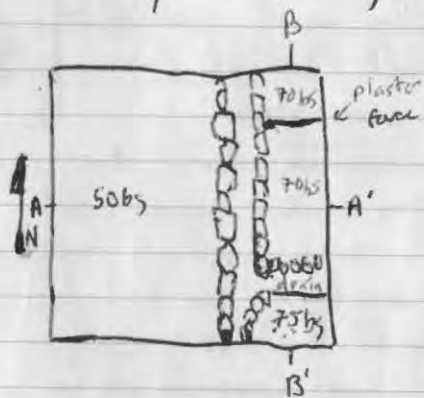

On the eastern side of the unit, Jessica has what looks like a old platform in the NE corner and another low platform is built adjacent to this. To the west of this platform is what appears to be a ditch between these low platforms and the high platform to the west. To the south of the low platform is another drain running e/w and to the south of this drain is another low platform.

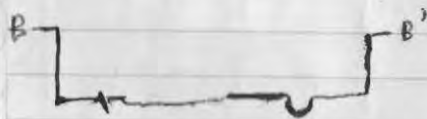

7/22/14



At the base of L13 in Darling's excavation, he has a line of <sup>large</sup> stones running north/south. The high frequency of large corner sheds, pannels, and obsidian

blades continues. He will obviously have a few thousand sheds in this area. He is about 1.2 m below surface.

7/23/14

As noted, we ~~are more excavating~~ <sup>already excavated</sup> Level 7 in the eastern part of 3934, 4124. However, the n/s ditch feature appeared much earlier we saw it at the base of Level 3.

We checked station 12900 from ~~26~~ 26400 and got 4050.626, 434.936, 157.344. There was a 5cm difference between this measurement and that of 12900 from Est #1. I suspected that we would have 3-4cm of error. I think that Station 1 has shifted a little.

In 4014, 3924 (Darling) seems to "almost" be at the base of the basero. The basero is on both sides of ~~these~~ the line of large limestone that is some sort of a wall. He is at the base of L14

7/23/14

dm 3828, 4282, (Deybi), is working in the northern meter (3 1x1m units) in order to observe what is beneath this mass.

dm 3766, 4534 (Adolfo) is removing L2. Given that the purpose of this unit is to encounter Postclassic deposits, we will stop the excavation of most of the area at the base of L2. After drawing and photographing, we will shift to a 1x1 m unit.

dm 4052, 4403, Miguel is removing Level 1. He is in a small indentation — a sort of dead end road on the north side of Sector BB. He is on the east side of this possible access point. His job is to search for Postclassic use of this area as well as to discern the function of this side platform (adjunct platform?).

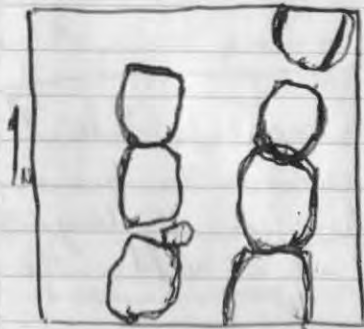

dm 4014, 3924, Darling is at the base of level 14 and now has two lines of large stones. I have no idea what their function was but I imagine that they lined an aqueduct. Of course, we have no evidence (yet) that this fort contained water.

7/24/14

dm 4014, 3924, Darling continues to remove large sherds and is leaning up for a photo. He found half of a nice quality greenstone head. This suggests that this "basurero" may in fact be a ceremonial deposit though I would like to find more before I make a final interpretation.

dm 3828, 4232, Deybi has found lajas lying flat to west of his platform. He also has a <sup>of blocks</sup> stone surface on the terrace that cuts (N/S) across the center of the unit. To the east of this is platform fill without an observable surface. Note that the lajas are below level 6 in this area (west). We are still removing this material in the SW corner of the excavation. It is possible that



this is the surface of the "road." If the lajas cover all three of the western units, we will open another excavation block to the west. It seems that the middle area (with plaster) was once covered by a layer of stones (or more than one layer). So the area had been modified.

Adolfo continues to remove L2 (it is a little slow this week). He has Vicky drawing the base of L2. Once he completes the excavation of drawing, he will shift to a 1x1 and go to bedrock.



7/24/14

dm 4052, 4403, Miguel is almost finished with Level 1. He is coming down on a level of soil (gray brown) with limestone inclusions.

7/25/14

dm 3834, 4124, Yessica needs to widen her excavation to the east to examine what she is going on there. She will open 3833, 4125 and 3832, 4125 to begin with, and we may also extend a meter to the north. We are extending to observe the form of the possible ditch.

dm 3921, 4136, Elsa is at bedrock in the 8 units that she is still excavating. The bedrock ranges from one meter to about a meter and a half below surface. It was definitely modified in several places.

dm 4014, 3924, Darling is digging L15 to the west of the second row of large stones (running north/south). He is still finding large sherds.

7/25/14

dm 3829, 4232, Deybi has found that the black flooring continued to the south. We will open a 2 x 3 m area to the west.

Way out of 3766, 4534, Adolfo has finished L2.



He photographed and drew the cobble platform. He is now going to excavate a 1 x 1 at 3766, 4533. He has begun Level 3 (platform fill) in that unit.

At 4052, 4403, Miguel has finished L1 and has begun L2 (initial collapse).

7/28/14

Back out on Monday. Evelyn and Deybi are in the city (coming back tomorrow) and I sent Mike to Tayasal to work on the drawing of the sculpted chultun lid. So I have a lot of people (since Elsa is drawing).

So I started the excavation in the two blocks about 20 m west of AA1A. Note that we will excavate 2 x 5 m with the NE corner at 3999.5, 4199. It is 2 m wide (E/W) and 5 m long (N/S). I currently have 6 people on it so I assume that we will zoom through L1 and L2.

7/28/14

At 3766, 4534 Adolfo is excavating L4 (more fill) in L3, he had a moderate amount of artifacts (certainly more than L1 and L2), but there were likely fill sherds & lithics. At any rate, we will have a better sample. In L3, he did have a Poxcawan tripod support so this level was Postclassic. This indicates that the low platform was at least in use during the Postclassic and likely constructed at that time — though the larger mound upon which this cobble platform was constructed was likely built earlier. He also has a fragment of bone that appears to have been painted red.

At 4014, 3924, Darling has finished L15 and will now move on to Level 16. Note that Level 16 will only occur west of the western row of large limestone rubble. I will leave these in place as they are too dangerous to move at this depth. Before the end of the day, he encountered what appears to be a ceasar sherd (spike appliques).

At 3834, 4124, Jessica (as noted) widened her excavation 1 m to the east. We were hopefully learn a little more about this ~~and~~ construction in this area. However,

7/28/14

I should note that these 3x3 m excavations make digging test units more difficult as they reveal more of the true complexity of what we are excavating. So, they are more accurate but much slower (not just because of their size) ... the old "when in doubt rip it out" saying does not work here. There is certainly doubt, but there is too much info to proceed so recklessly.

In 3921, 4136, Elsa continues drawing with Vicky. She will likely finish today and will start a new unit tomorrow. I think she will move to west (on the south side of Sector 2).

In 3999.5, 4198, I took my 10 units down to the base of L1 (new houses) and completed some of L2 (old houses) as I have 6 workers. It is a very nice day as there is overcast and a nice breeze. Nevertheless, artifact frequencies are very low.

Notes:

The sculpted chultun lid from Tagast ranges from 17-26 cm but tends to be around 22 cm.

7/29/14

One note, — I will not open 3999.5, 4198. Evelyn and Daybi are back so they can take the people. I hope that we can make progress on the western extension of 3828, 4232 today.

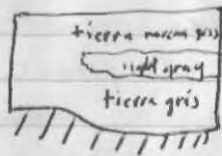

West profile



east profile

Elsa is about to fall her unit. Note that the stone feature that we recovered was empty and was covered with a stucco surface that "kind of" mimicked the form of bedrock on the western side of the unit. We still do not know what this feature is and now that the unit is closed, it is unlikely that we ever will. Nevertheless, it seems to me that the road was built on bedrock. It also seems that it was reconstructed to be flat later in its use.

Darling is still excavating L17 to the west of the second row of stones. I think he is changing levels too frequently but that is fine. He found a human phalange so I wonder if there could be a burial here. However, we are not finding articulated remains. There are fewer sherds in L17 (or at least they are not as large).

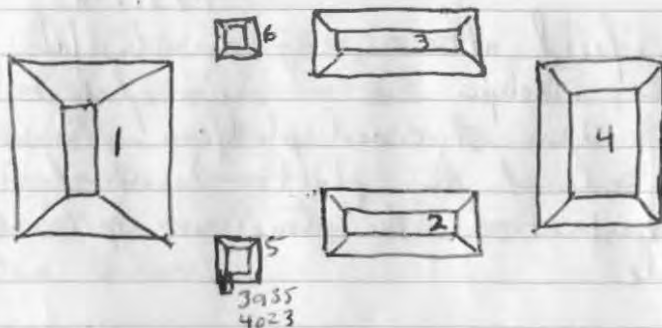
Sector ~~Z~~ ZPoorly drawn Sector Z  
3935, 4023

dm 3766, 4534, Adolfo's test encountered an east-west wall in Level 5. I think it is a platform with fill to the south and a surface to the north, but we will excavate more to see.



Elsa put in a 2x4 (N/S long) at 3935, 4023. She will excavate a 1x4 part of this as she is running out of time. She will do the eastern (3935 units).



7/31/14

Back in the field after a day in the lab  
 dm 3991, 4222, Evelyn has a map of large  
 stones against her stuccoed platform of around  
 floor (east side of this platform) which is  
 obvious reconstruction. The stones are primarily  
 large rubble.

(or actually 3828, 4229)

dm 3829, 4232, Dayhi is finding that the  
 row of blocks is pretty much a row and  
 ends there. It is possible that this row  
 lined the western edge of the platform.  
 What we want to know is the type of  
 surface he has to the west of these  
 blocks.

dm 3854, 4124, Jessica has extended to  
 the east and has reached the base of  
 Level 5. She has a floor in most of the  
 but on the NE corner there  
 seems to be a feature (Fea 1)



no scale

7/31/14

dm Group 3766, 4534, Unit 3766, 4533  
 Adolfo is in Level 6B about 1m b.s. He  
 now has what appear to be a wall in the  
 western 20cm of the unit. We will see. I expect  
 that he will hit bedrock by Monday, but  
 who knows.

dm 3991, 4246, Evelyn has the western edge  
 of AA 1/1 (at least the final construction).  
 It is composed of two terraces

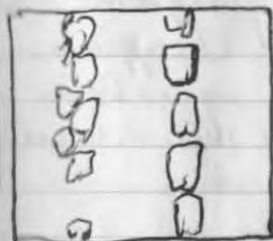

The edge of the platform is better  
 defined in the lower terrace.  
 We will continue to define  
 these features

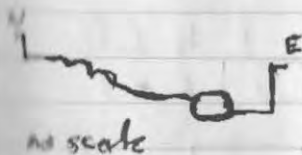

dm 3935, 4025, Elsa is in L2 in her 1x4m  
 area.

7/31/14

clm 4014, 3924, Darling is currently in L19.

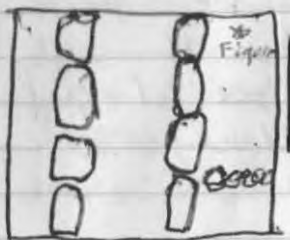

no scale

They have what appeared to be a small well running e/w to the west of the western row of large stones. Note that yesterday, he found a white clay figurine in L17a.

4013, 3923. The figurine appears to be an Olmecoid Middle Preclassic figurine. The head and legs and arms of the figurine are missing (AKA a torso) and it appears to have "kill" holes in it, of an uncertain of the date of Level 17 as these object seems to have been reused.

clm 3828, 4232, Deybi continued to follow the block "surface" but it turned out that

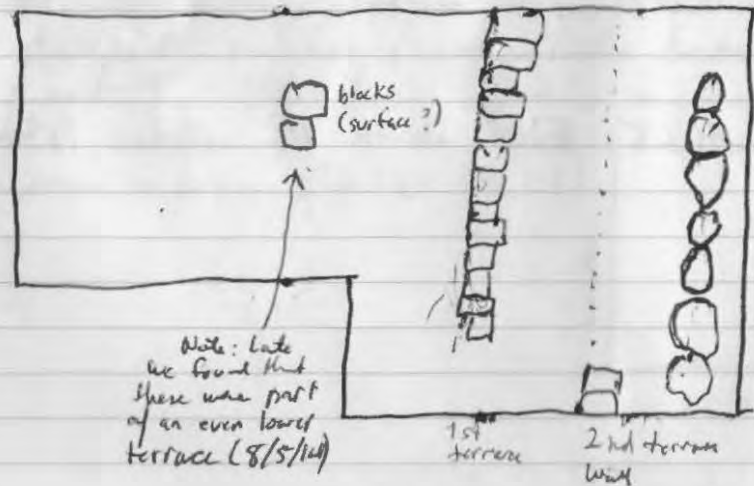
3828  
4232no drawn,  
but excavated1st  
terrace2nd terrace  
westNote: Later  
we found that  
these were part  
of an even lower  
terrace (8/5/14)

7/31/14

something else was going on. This (the line of blocks) seems to be the platform edge and it is odd. The blocks extend over a wall beneath them. It is an odd configuration as we would expect it to not support much weight. We have not found the base of the wall supporting these stones.



clm 3834, 4124, Jessica's extension has brought up more questions and answered little. One might recall that there was a vertical stuccoed surface in Unit 3834, 4125. She now has a similar surface running north/south in the eastern extension (this was the western edge of Fea 1, but it does continue).

8/1/14

Today I worked on my area again. Level 2 (old humus) is going deep and they took it a little too deep in 3997.5, 4198. They excavated a little into Level 3, which is a dark gray soil with small limestone inclusions.

clm 3828, 4232, Deybi has found that the second terrace wall continues in his extension to the south. We will need to further investigate this to the north.

8/1/14

clm 3999.5 4198 we have encountered bedrock

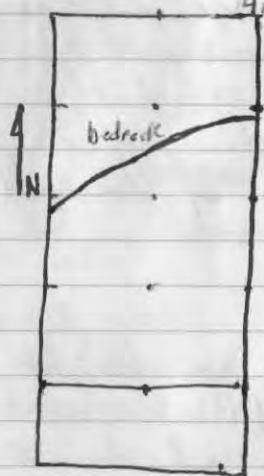

at the base of L2 (ca 35cm below surface). I assume that we are in a sascabua or another type of mine. However, it is suspicious that this feature rests along the ceremonial cores "axis" (or seems to). Based on the surface, I estimate that this feature is about 8m wide and roughly oval shaped. This

is very reminiscent of Ixlu's apparent sascabua to the east of the main temple. Of course, the time of this feature's use is as yet uncertain.

8/4/14 <sup>33</sup>

clm 3766, 4534, Aldofo is about to hit Level 9 at about 170cm below surface. Level 9 is a tan brown soil below rubble and soil fill (Level 8). This unit is interesting but the walls are too soft

clm 3828, 4232, Deybi is clearing up in preparation to excavate the lower part of the terrace wall (that is the first terrace). Note that there are a couple of blocks ca. 5m from this wall that are suspicious, but we will proceed with caution. He found a Middle Preclassic figurine in Level 5, against the lower terrace wall.

clm 3935, 4025, Elsa has left for Guatemala and Vicky will take over. She is still removing some of level 2, which seems to be an old humus layer. She

clm 4014, 3924 Dasting has begun his extension to the west. It is a 1x2 (c/w) beginning at 4014, 3925. I am adding this to allow them to better investigate the contacts of this feature. I want to leave the two north-south rows of stones in place leaving only a small area to excavate. This extension will ~~remove~~ search for more lines of stones (if any exist) and allow a ~~large~~ space to search for deep materials.





We removed the large stones in the Southeast corner of the 4002, 4221 extension (in Unit 3999, 4222) which we have named Feature 1. Note that this is above the old ~~oval~~ oval Fea which I assume will be called "Fea 2". Recall that "Fea 2"

includes two large stones surrounded by smaller stones.

Unit 3991, 4246, Evelyn is finding that her low walls of very soft limestone (some with the consistency of soil) - the east face of Str. AA1 - are built upon a ballast of sticky black clay. This seems similar to that described of Tayanah (by me) and at Seibal (Tourtellot). Not only does it anchor stones, but it also serves as a base for plaster (as noted, plaster is sometimes placed directly on soil and one of those soils is the sticky black clay).

Unit 3766, 4539, Adolfo is at the base of Level 10 (a plaster floor). He has another floor beneath this floor as well as some caliza blocks. The second floor will be excavated as Level 11 and the blocks as Level 12.

Note that Level 10 occurred at around 175 cm bs and Level 11 at around 195 cm bs. The blocks are part of an old wall or may cover a Fea.



Unit 3828, 4232, Payhi has found that some of the blocks to the west of the lower terrace form an even lower terrace. So Level 5 west of the "Lower terrace" dates the "Lower Lower Terrace" (a la gran...). However I will give this Fea a different designation later given that we used the same level to excavate

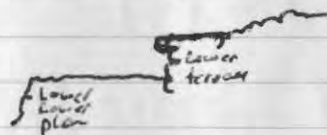

located to the west of the lower, lower terrace. The better line is that we will need to work hard to change these designations once we understand what is going on.

8/5/14

So in 3766, 4534 Adolfo found a small "pavement" of shreds in the south east corner of his unit adjacent to and east of Level 12 (the limestone block floor in the southwest corner).

Vessica has spent the day in 3834, 4124 drawing, taking photos and thinking. It is certain that Levels and Units fail here. It is simply too complex and the notes will be the only designation with value (in the large sense, the levels work by 1x1m unit).

8/6/14

It rained really nice yesterday. We spent the morning repairing the damage. It was a busy day that I spent running from place to place.

8/7/14

at 3834, 4124, Yessie is removing Level 9 (the extension in the eastern part of the unit). Recall that it is in the 4125 east line. It is a ~~step~~ low wall of one to two + courses. We are removing this extension to

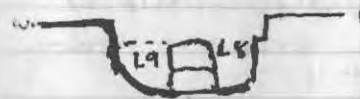

better understand the "trench" in which it lies. Recall that the platform to the west of this low wall (Level 9) is coated by stucco on the top and sides. The side plaster surface curves down to the east and seems to run under Level 9. Further note that L8 was another extension to the east of L9.

In 3935, 4025, Vicky has a nice wall running east west in unit 3934, 4025. She is exposing the wall as she removes Level 5. She will search for the base or piso. I assume that we have the platform edge of Sector Z.

In 4014, 3924 (ext) Darling continues the 5x2m extension and is now in L7. He is about 60 cm (est) below surface. The artefact content is moderate.

3828, 4232

In ~~3828, 4232~~ Dayli continues his excavation of Level 7 which lies only to the west

8/7/14

of the lower lower terrace wall. He  
 they found a very nice plaster surface ~~to~~  
 below Level 7 that of a fairly certain,  
 that we finally have the corridor surface.  
 I will extend it with a 1x2 extension  
 to the west to get a better view of  
 this surface. Day bi began the extension today.  
 The floor is about 1.1 m below surface.

On 4002, 4221, Evelyn has excavated  
 Fea 1, the ~~at~~ circular fea and after about  
 1.2 m she hit a burned floor. In other  
 words, she found no cache as we expected  
 She is now putting in a 2x2 m extension  
 to the west (the northeast corner is at  
~~3999~~ 4001, 4218. We need to get this  
 area cracking again!

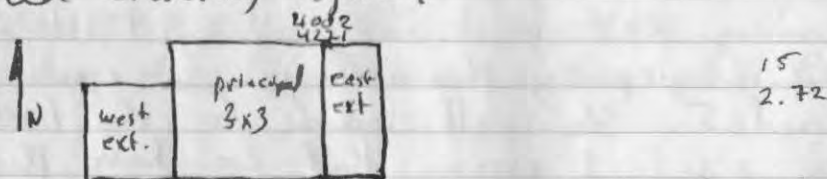

She also opened a test unit (1x2) at 4002  
 4222. This will cut into the wall forming the  
 low platform, but it is already poorly preserved  
 in this area. We soon found that the floor  
 to the east of the low  
 platform.



8/7/14

My (3999.5, 4198) little experiment seems to  
 be failing. We are not going to find a  
 huge basuro in this excavation, but we did find  
 a few large sherds in Level 5 indicating that  
 it may have very briefly served such a function.

On 3766, 4534, Adolfo hit a nice plaster  
 floor (Level 16) at 2.72 cm BD. This floor is  
 below the blocks in the southern portion of the  
 unit (separated by a little soil fill). This floor  
 covers the entire unit.

On 3834, 4124, Jessie removed the low  
 wall. The floor did indeed rest under Level  
 7 and we found that the face of Level 9  
 was also once covered by plaster. At the  
 base of the wall was a remaining portion of  
 this plaster face.

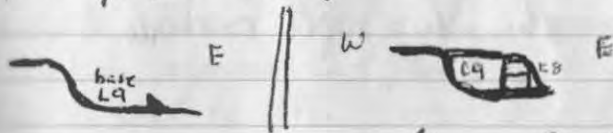

So, we have partially solved this "mystery"  
 unit we are going to excavate part of the  
 platform to the west of Level 9. We will  
 begin with the floor on top of this platform  
 (Level 5).



In 4002, 4221, things have become complicated for Evelyn. She removed part of L9 in her

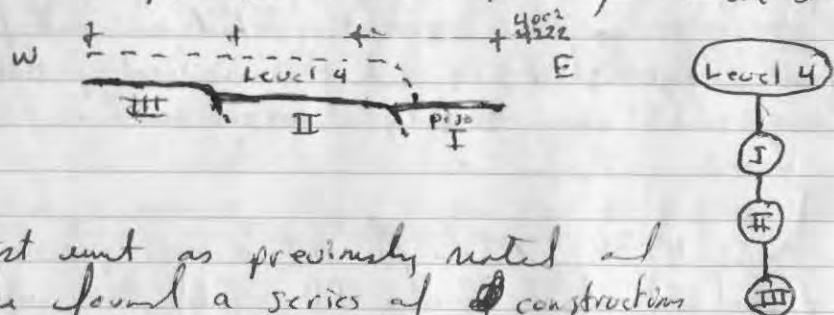

test unit as previously noted and she found a series of constructions and reconstructions (identified with Roman numerals)

8/8/14  
 In 4014, 3924, Darling is at the base of L9 and has a layer of medium sized limestones in a matrix of gray brown soil. He believes he has a row of stones and will draw the layer. I am doubtful, but that is fine. It is best to record as much as possible. After this he will continue downward.

In 4002, 4221, Evelyn is drawing the series of floors/surfaces in her 4002, 4222 test unit. She has also begun her western extension at 4001, 4218 (which is currently a 1x2 (n/s), but we may excavate another 1x2 to the west

Unit 3999.5, 4198, my little 2x5 m excavation, 20m east of Str. AA1/i is now done. I only took it to bedrock in the northern group (9 units). This area was largely nothing. I guess the ceramics will date the sealing of a borrow pit and that is about it. On the other hand, it may show that some borrow pits were open well this even served as a ceremonial center. We will see.

Deybi (in 3828, 4232) has a "lower, lower, lower terrace" that ~~rested~~ The wall of the fourth terrace rested 1.45m from the 3rd terrace. Recall that Deybi was following the floor that rested at the base of the third terrace. This floor suddenly ended with the edge of the fourth terrace. Note that the soil adjacent to the west side of the fourth terrace looks the same as that that rested above the floor, but we will designate the soil to the west of the 4th terrace as Level 8.

In 3935, 4025, Vicky found a floor in front of the wall that runs east to west in 3934, 4025. The wall continues deeper than the floor so she will designate the floor as Level 7.

1617 (paint) 18  
 clm 3766, 4534 Adolfo went through two floors (Level 16 and 17) and is on top of a third (Level 18). Level 18 is painted red on the surface and Level 17 also has some preserved portions of red paint. We did not find ~~any~~ any on Level 16, but it may have eroded. This floor almost looks like blocks so I am



going to have him excavate with extra care. Note that Level 18 began at 2.97-2.99 on B.D.

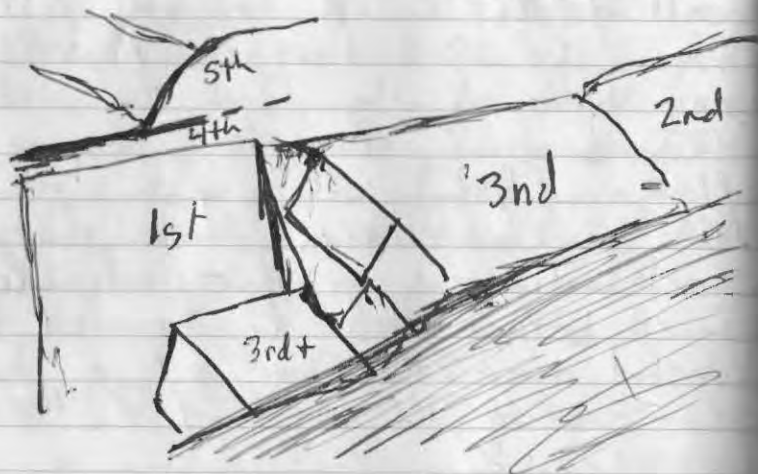

Tim Rugh 3rd Grade 8 years old

clm 4002, 4221 Evelyn's extension has some odd series of constructions with a stopped platform edge (1st) running east-west. A second platform was built against the 1st. A 3rd was built against the 1st and 2nd (crossing north-south). A

lower surface (3rd+) may have been built against the 1st and 3rd. All this was covered by a floor (4th) which was then capped by another stopped platform (5th). Note that the 5th is the surface beneath Level 3.

8/11/14

I was supposed to stay in the lab today, but I woke up at 4:30 with desire for the field so my plan was reset. I will be in the lab tomorrow... probably...

clm 3834, 4124, Yessica is removing Level 5 (the upper part of the platform east of Level 9 in order to better understand this construction and to get below it.) She will also open a 1x2 m (n/s) in the NW corner of her excavation at 3834, 4122.

clm 4002, 4221, Evelyn continues in her extension to the west, but will also extend to the northeast.

clm 3828, 4232, Deyhi continues to remove L's to the west of the Lower Lower Terrace.

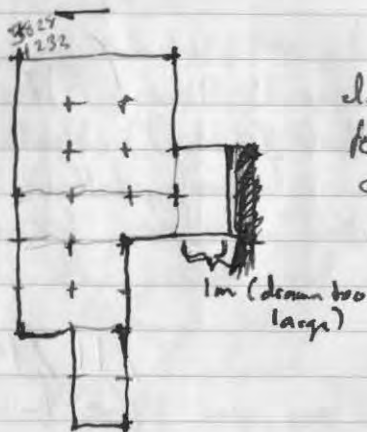

In the horrid sketch to the left I have drawn Daybi's current units, we will likely extend the 3827E line, 3 m to the west.

In 3834, 4124, Yessica is now below L5 in the area west of L9. She will now distinguish Level Forward 7h.



Back in 3828, 4232, the "lower lower lower" terrace appears to be composed of bedrock. So either we are below the surface of the corridor or the bedrock forms flat surfaces. It is also possible that both options were true at different points in time.

8/11/14

Adolfo began excavation L19b to the east of the red floor and after about 65 cm he hit human bone. I believe that the head may be to the north but I am uncertain. I believe that the steel concentration (Feq 1) was the origin of this burial pit. The pit differentially cuts through Levels 16, ~~17~~, and 18 (red floor) as well as the fill below the floor.

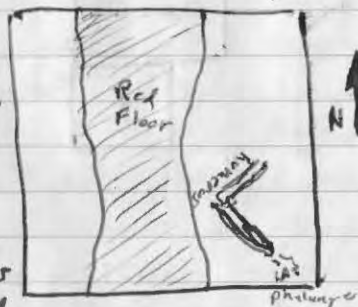

In 3935, 4025, we have a second terrace. She has one floor below the first terrace that is at the base of this wall. This floor is L6 and the fill beneath the floor is L7. Note that the second terrace wall is about a meter lower than the first.

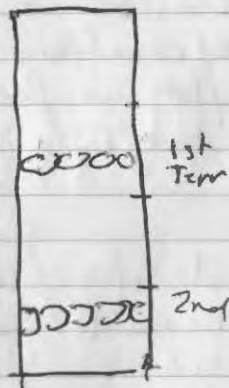

In 4014, 3924 west extension, Darling is in L13 and is rapidly approaching the level of large shards.



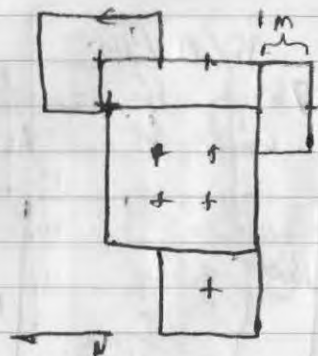

This is another crude sketch  
but of Evelyn's area for some  
calculations I am making.

8/12/14

I am in the lab today, but in 4002, 4221  
Evelyn, in her new extension on the FIE corner  
has found a floor at the base of Level 2.  
We did not find this elsewhere, but it is  
certain that this floor or its fill is related to  
constructions encountered in other parts of the  
excavations (to be seen). I assume that this  
floor is Postclassic and related to the Postclassic  
materials that we are finding in 4002, 4221.

8/13/14

In the field today - given that Evelyn will  
begin the lab, I took over 3991, 4246  
where we will excavate Level 1 in an extension  
to the east (IX2) and another to the west  
(IX2). The purpose is to examine the top  
of HAI (hence the western extension) and the  
very base of the platform (hence the eastern  
extension). There is significant Postclassic  
use of this area which is of importance

to the current project - note that yesterday we  
found what appear to be the Postclassic  
construction partially responsible for some of the  
refuse found in the area. However, I believe  
that these same joints are placed well enough  
that we will also learn about earlier  
deposits. I am now trying to target better  
with success. One issue that plagues me  
is the lack of Postclassic burials. I assume  
this will just require time to discern, but it  
is a major discrepancy (also present at  
Zacpeten).

3

don 3834, 4124, Jessica is working on  
two IX2a units that she will continue.  
One (L/W) is located at 3834, 4125. <sup>The other</sup>  
3834, 4122 and is oriented n/s. We  
will not excavate other parts of the  
pit. This will leave the south platform  
untested. It is possible but  
we will test it (but we are  
running out of time). Recall the  
little channel between the  
north and south platforms.



Note that in 3834, 4122 below the  
platform floor, which we called Level  
12, we encountered a high concentration of  
shells.

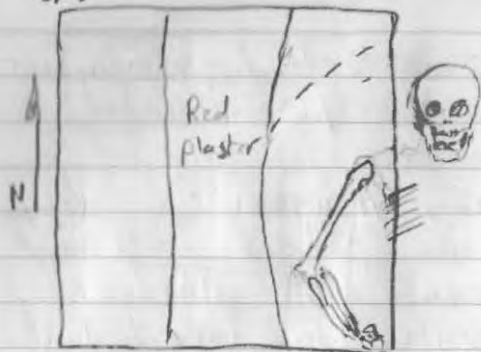

Poor sketch of  
Burial 1 in  
3766, 4534

Adelle is making progress in 3766, 4534, Burial #1. The remains are fairly well preserved though the skull was fragmented. A small primate skull was found in the region of the right hand. It seems to me that they are finding a lot of fish bones here. The skull is very fragmented.

dm 4014, 3924, Darling is in L16 in his extension. He is now in the layers with heavy sherd deposits. Note that it is becoming clear that we do have lines of stone (at least one) running east to west.

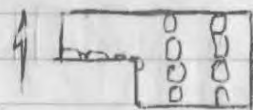

becoming clear that we do have lines of stone (at least one) running east to west.

now assume that this depression held some sort of construction, the function of which escape me. V

8/14/14

dm 3828, 4232 Jessica continues in back units (1x2 tests). dm 3834, 4125



All in (r55) than the door

This is a crude cross section at the 3834 N line. Note that Jessica removed the wall (L10) and found that the floor to the east did not face in a much L10 so L10 was built on the floor and then was coated with L12.

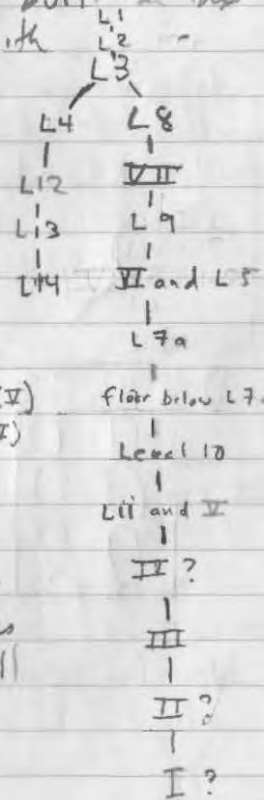
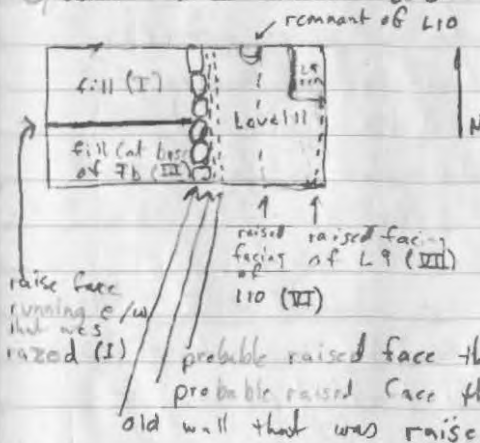

OK I think I understand this now. I am still vague on I and II as it is uncertain how the wall relates to the razed face and its fill.

Now, besides this, Jessica had a floor (L12) in the other test unit (3834, 4122) at below

The floor was a heavy sand fill (L13) that rested upon a nice burned floor (L14).

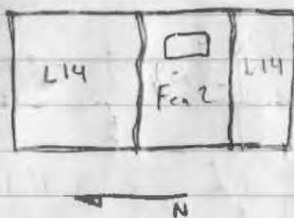

So, she now has a fea that cut through L14 (the burned floor), but was below L13.



Vicky is defining the lower terrace wall at least part of it up against the wall tablero in form. (vaguely!)



Again, this is just a portion of the wall.



So in Parling's area, we have two small walls running e/w. One of large stones and the other of medium sized stones. Both are low (ca 30 cm) than the lower of the two n/s walls

to the east. The medium sized stones are about 15 cm lower than the larger stones and I wonder if it is an extension. I have no idea why there are constructions in this depression! At any rate the ceramic concentration was much lower here but there was still a high concentration of large shell

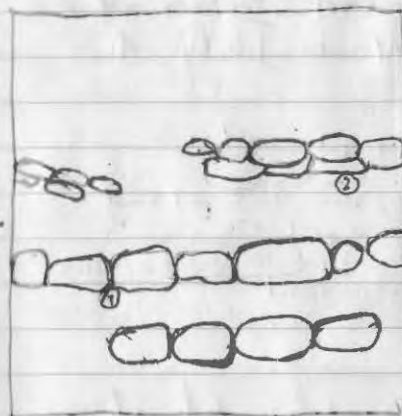

dm 399, 424 (a)

I took two small samples of black clay from two of the three terrace walls that appeared at the base of levels 4 and 6. Note that the walls do not yet have level numbers since this clay that lies beneath the stucco do not have numbers either. Note that

this clay is holding the stones in place. Note that elsewhere, this material serves as a base for plaster surfaces.

Sample #1 Lotc: N4671

Sample #2 Lotc: N4672

Note - these samples were taken from under the soft limestone blocks/rubble - not in front of it.

dm 3834, 4124, Jessica excavated Level 11, a floor and recall that this floor ran up the side of the platform to the west. Below this is another floor that has stucco up to cover this wall.

Note: now that I take a look at this, it seems that the stucco covering L9 also has two constructions.



8/15/14

In 3828, 4232, Deybi shows bedrock surface at the base of the rock "face". It is likely the

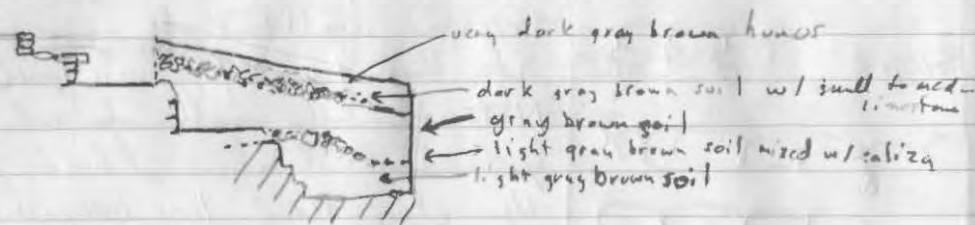

was at one time the platform edge, but it seems that it was later filled to form another edge.

Fca 3	Level 20
	(piso)
	3.2880

In 3766, 4534, Adolfo is on top of Level 20, the plaster floor that lay beneath Pasgo 2/Buig 1. It seems that Adolfo also has a

cut on the west side. This cut began at least in L18 and of suspect that it also cut L17, but not Level 16.

In 3828, 4232 Deybi continues cleaning up bedrock west of the platform and has found that in one section, they were cutting at a limestone block. This means that the original grid cut originally served as a quarry.

In her 3834, 4122 test, Jessica completed Fca 2 after about 20 cm when she hit a plaster floor. She has not named it yet but it is the 2nd plaster floor visible in the western part of the unit.

Durling continues in the west extension of 4014, 3924. (recall this is a 1x2). He is in Level 18 and continues downward.

Sondeo # 91

50x50 cm

40 cm deep

34

Lotc NS910

3733.46, 4594.40

139.61

We placed this sondeo on the platform to the east of Sondeo #90. We seemed to place this unit directly on top of ~~the~~ a wall composed of large limestone rubble.

Besides the wall in the initial level (0-15 cm) we put a nice fill layer (15-40) of ~~the~~ medium sized limestone in dark gray brown soil.

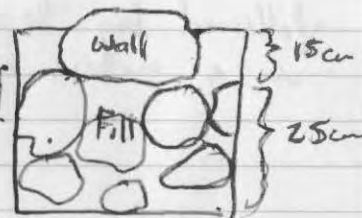

Note that the initial layer was a dark gray brown humus surrounding the wall (which ran east to west).

The unit ended when we hit a gray soil with caliza inclusions.

Artifacts content was malacate and included sherds, pedernal, shell, and obsidian.

55

Sondes # 92

50x50 cm

40 cm deep

Lots: N5911

3783.74, 4497.80

142.274

This unit is located about 40 m northwest of Adolfo's block. We are just better testing the area for Postclassic refuse. The unit had 10 cm of very dark gray brown humus followed by 30 cm of small to medium sized limestones in a matrix of dark gray brown soil (fill).

sondes # ~~92~~ 93

50x50 cm

40 cm deep

Lots: N5912

3679.84, 4566.38, 135.2

I placed this unit about 70 m south of Adolfo. It seems about 70 m from the shoreline as well. We had a deep (24 cm) level of humus (dark gray brown soil) followed by <sup>very</sup> small limestones in a matrix of dark gray brown soil. We had a moderately <sup>high</sup> quantity of artifacts.



8/15/14 56

Sketch Thoughts. 3834, 4124

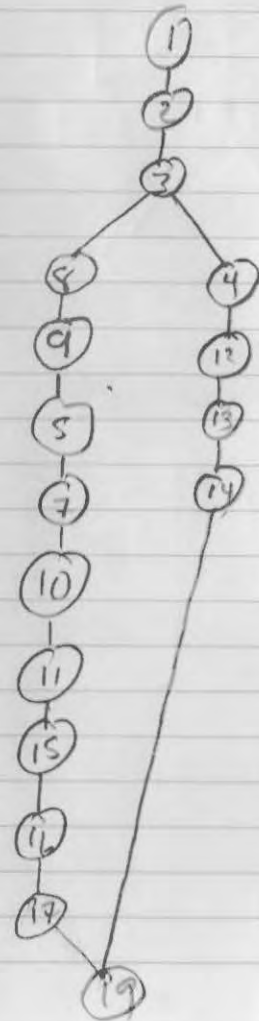
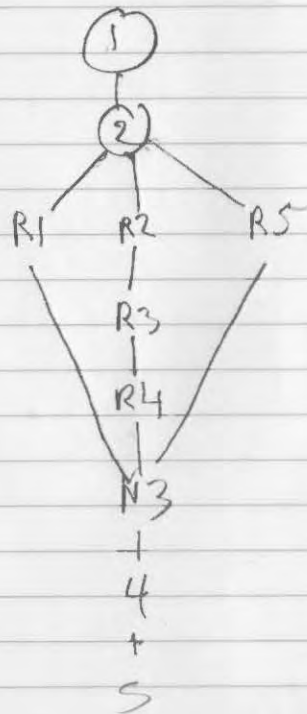
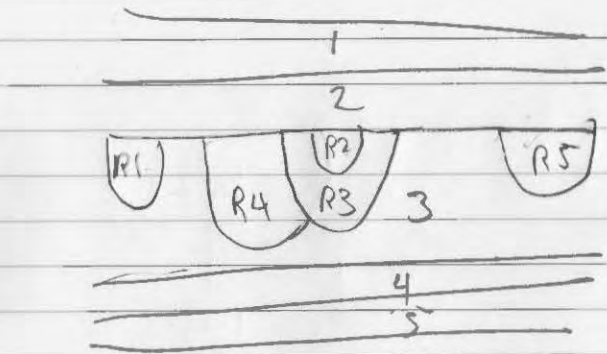

Sketched Thoughts  
3834, 4124 sketches

8/6/14 57

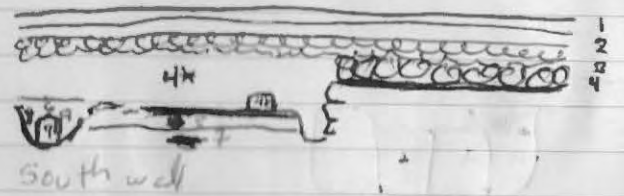
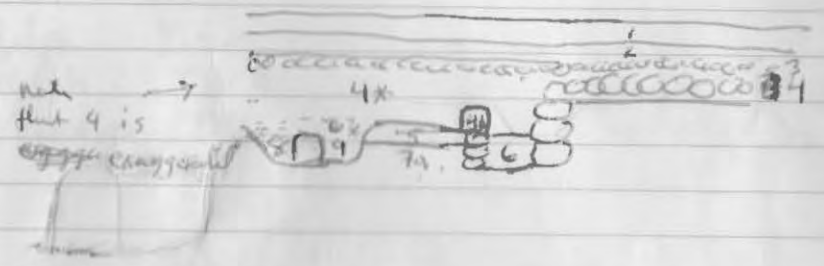
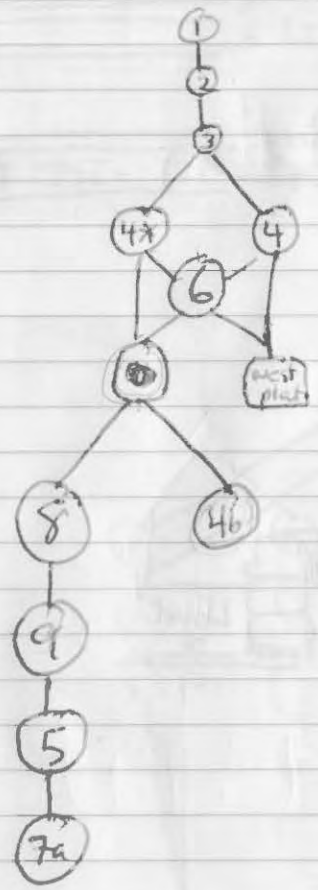

- 1 - humus v d gb
- 2 v d gb with <sup>tiny</sup> small limestone
- 3 d gb with small limestone
- 4 cobble surface
- 4\* gb

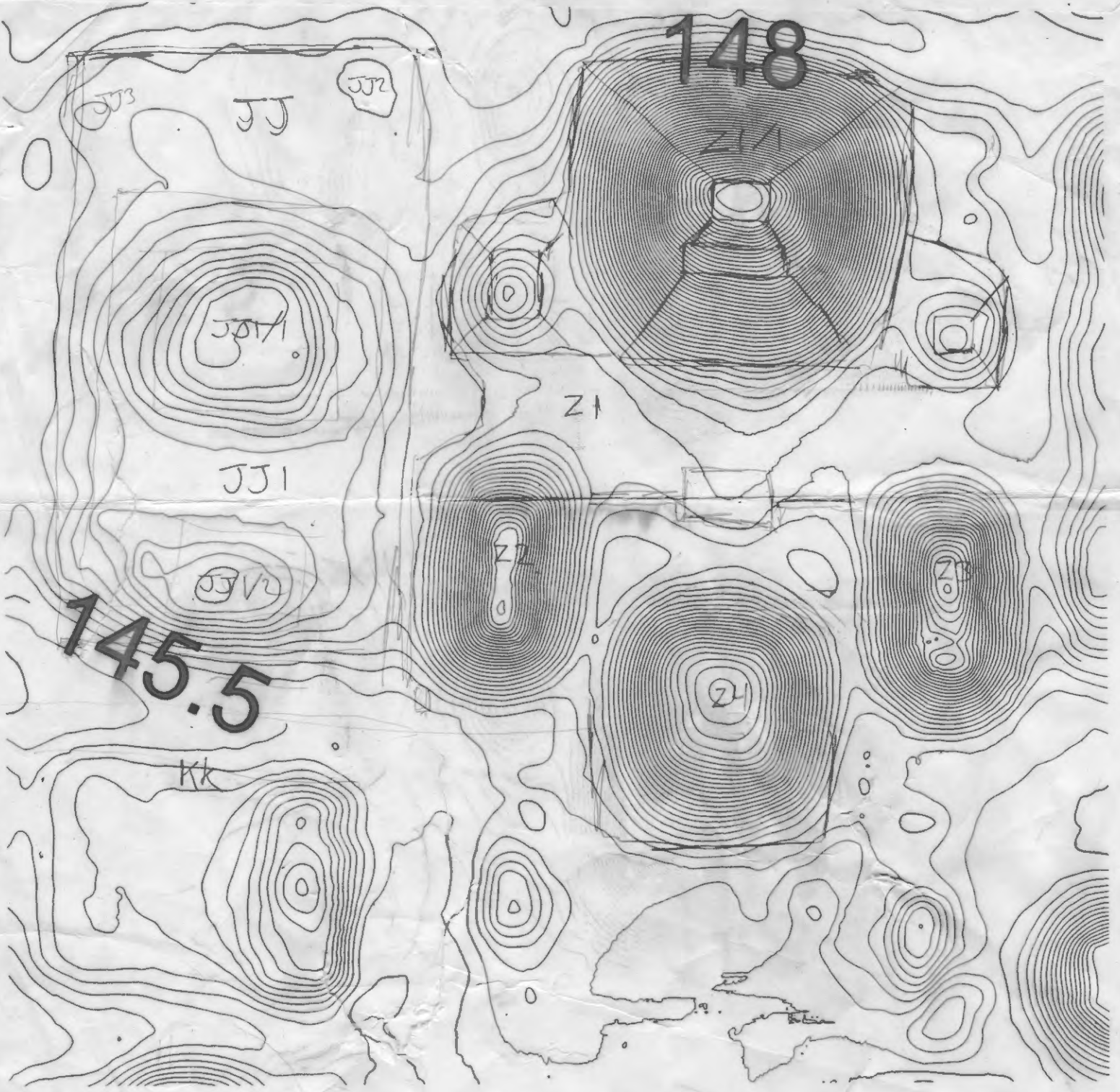



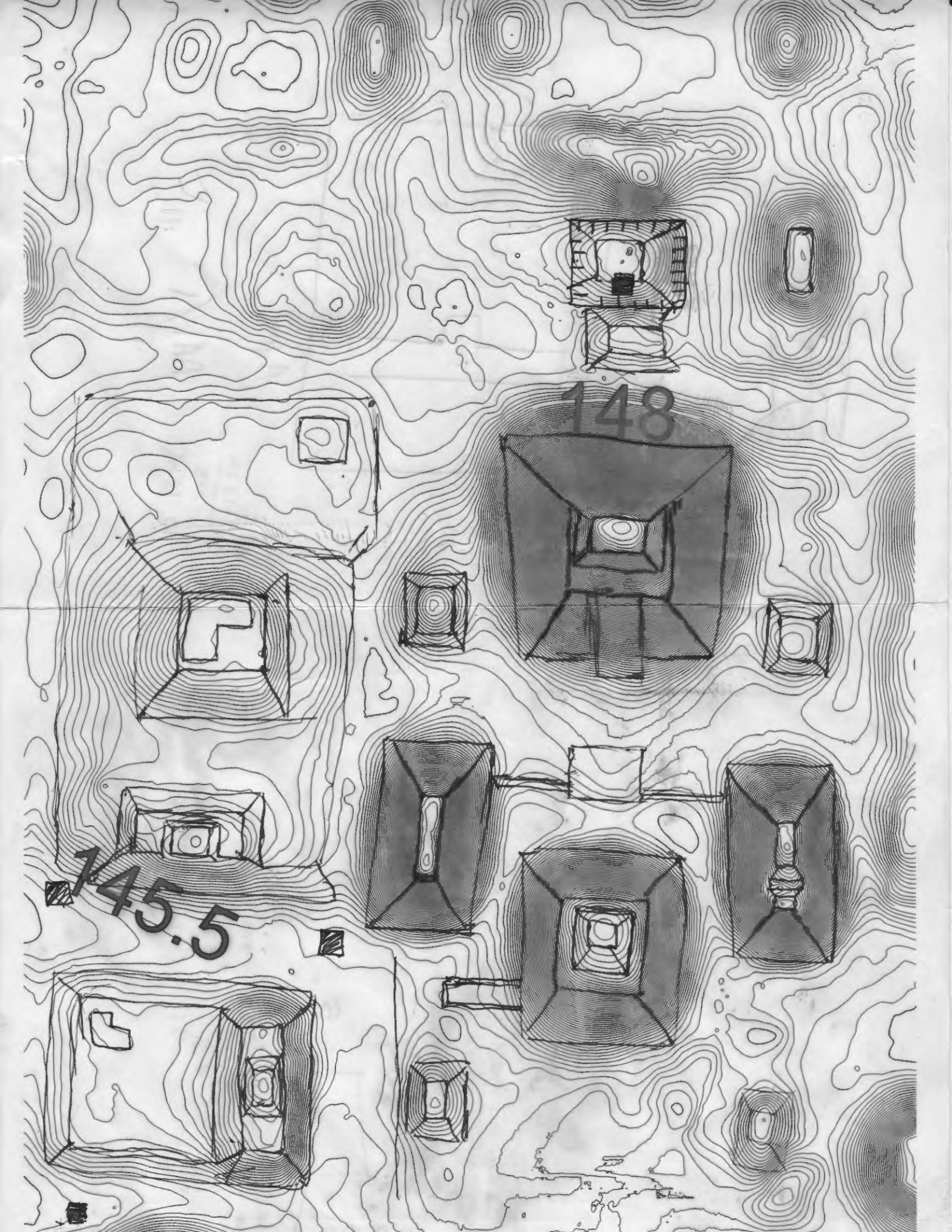

148

145.5

Aug 17, 2014

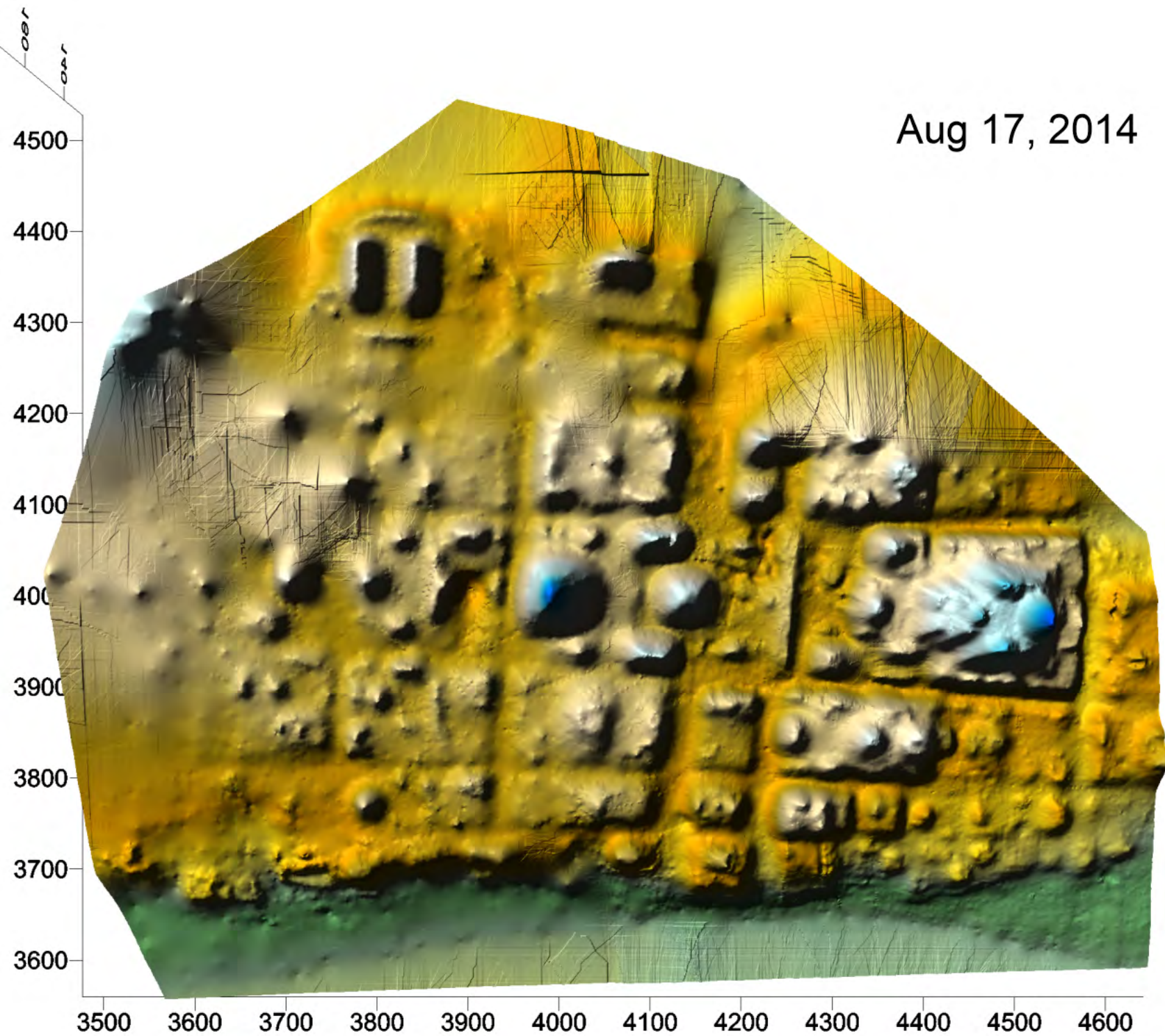



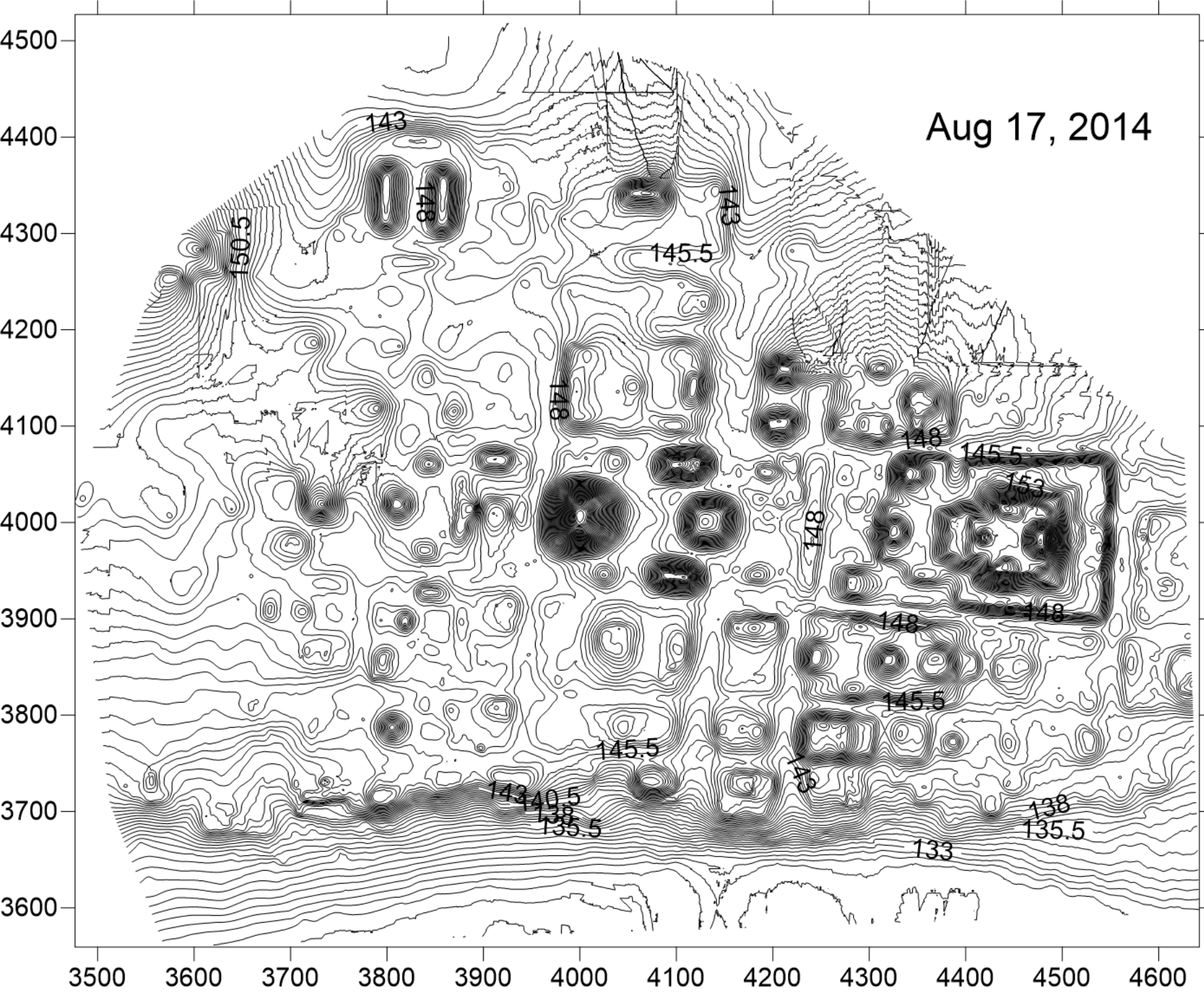



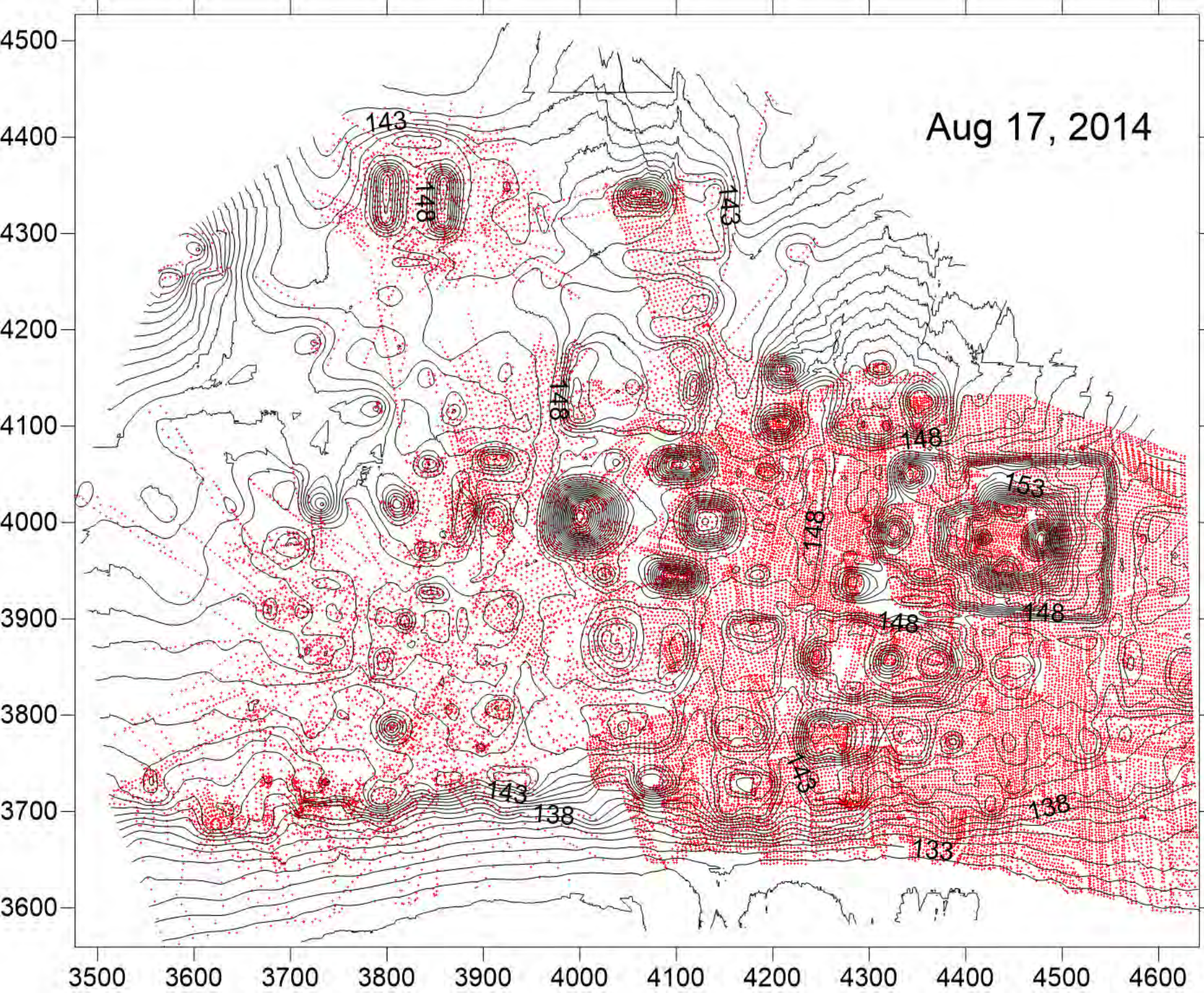



Aug 17, 2014

