

PROYECTO MAYA
 SITIO AGR. ZACPE
 OPERACION Z-602
 MURO B Y MURO D
 ESCALA 1:10
 22/2/79
 BC

0 10 20 cm

Note: The ceramic were logged as Z-602-1B and the boxes as Z-602-1A

ZACPETEN
ESTR 602
PERFIL ESTE-OESTE
SOBRE ESCALINATA 1ERA.
ESCALA 1:10
BC
29/4/97

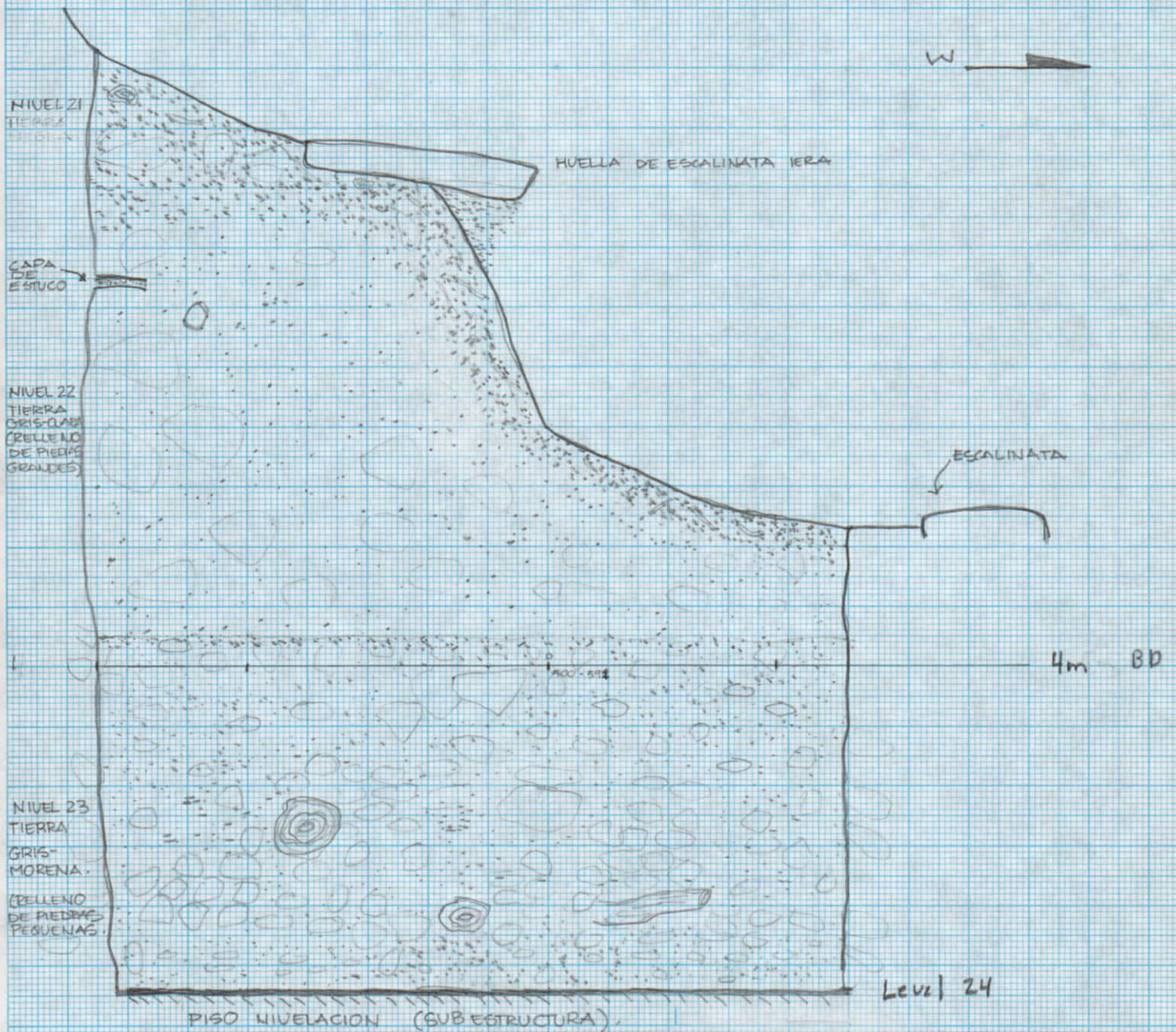

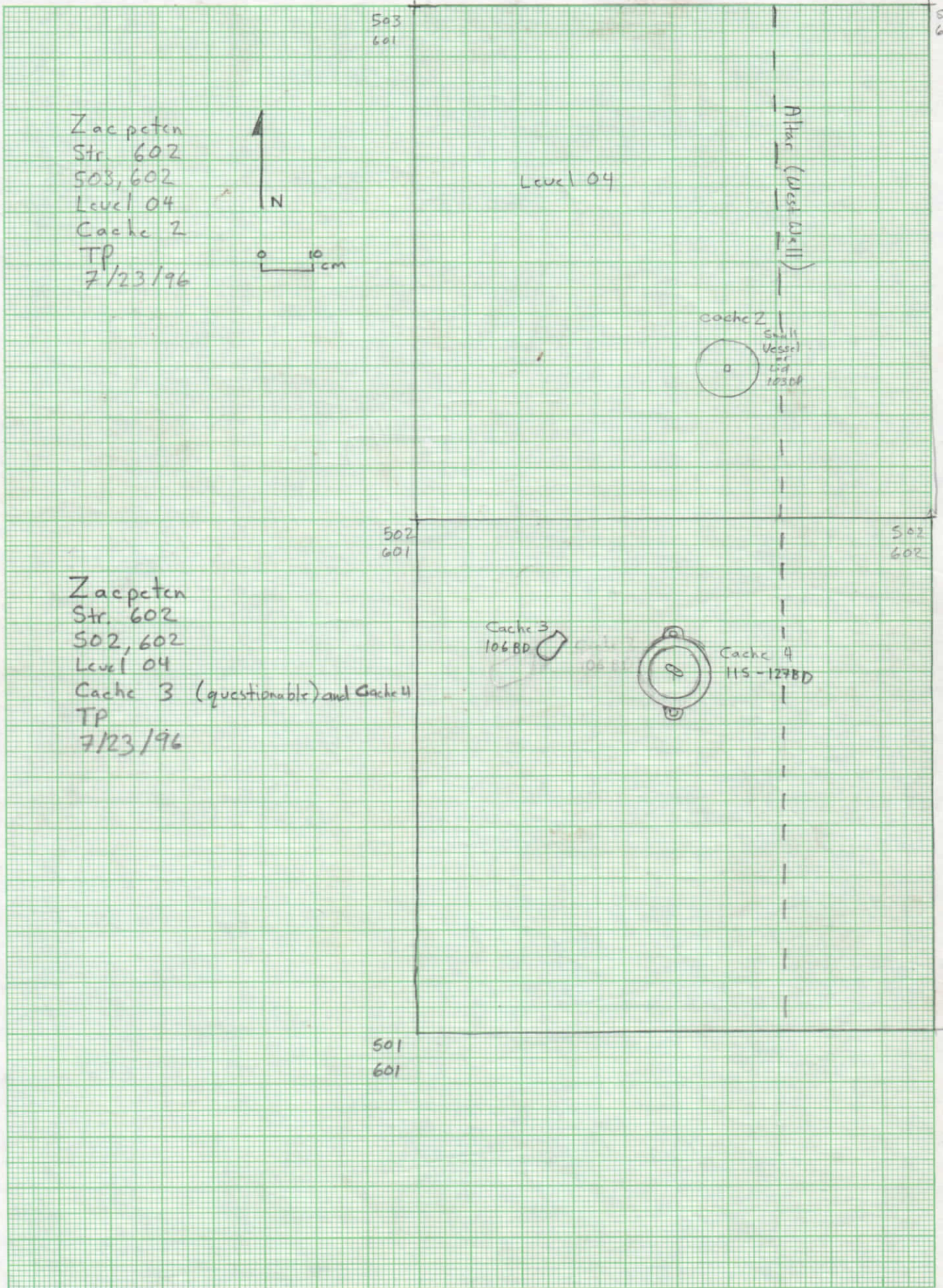

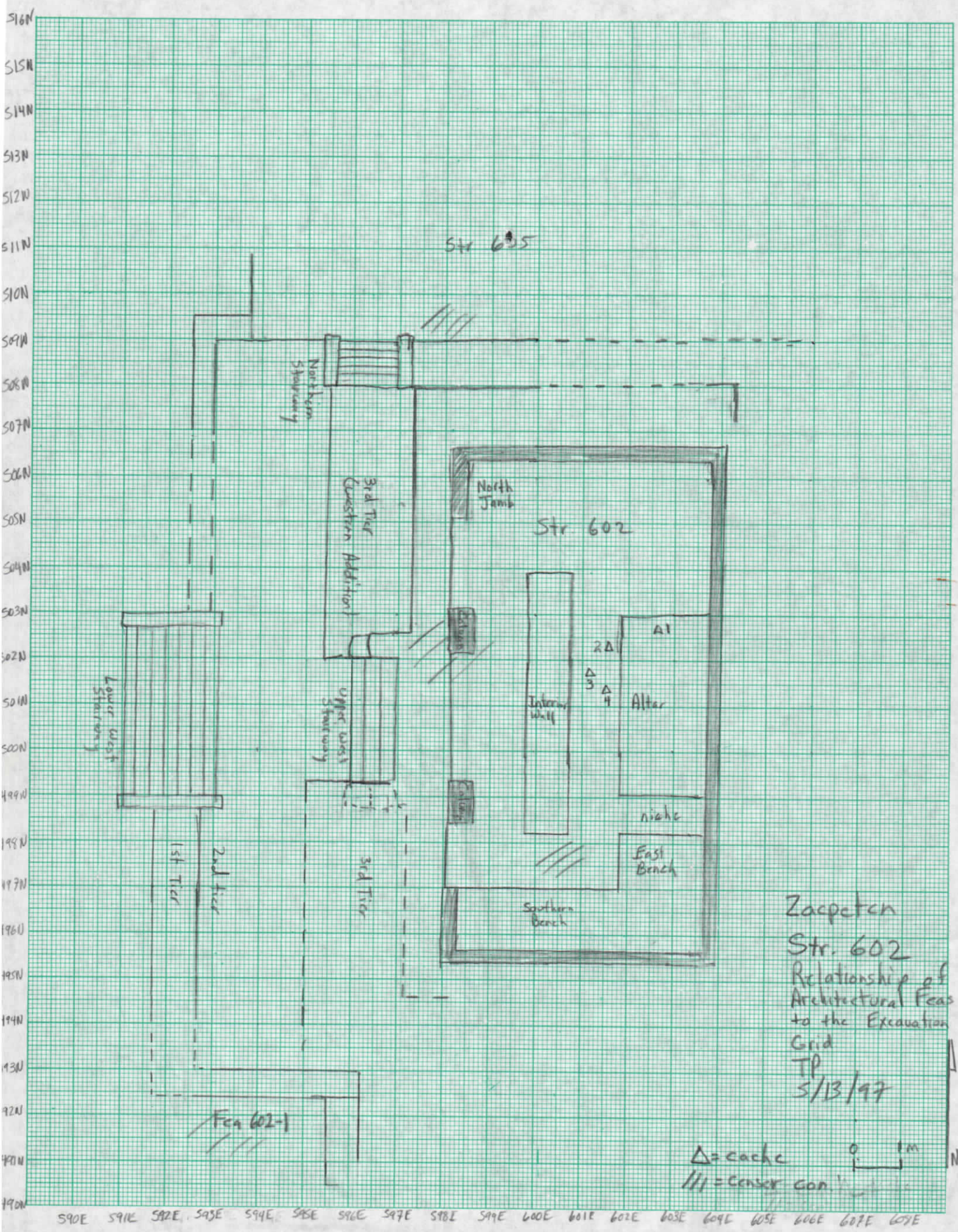

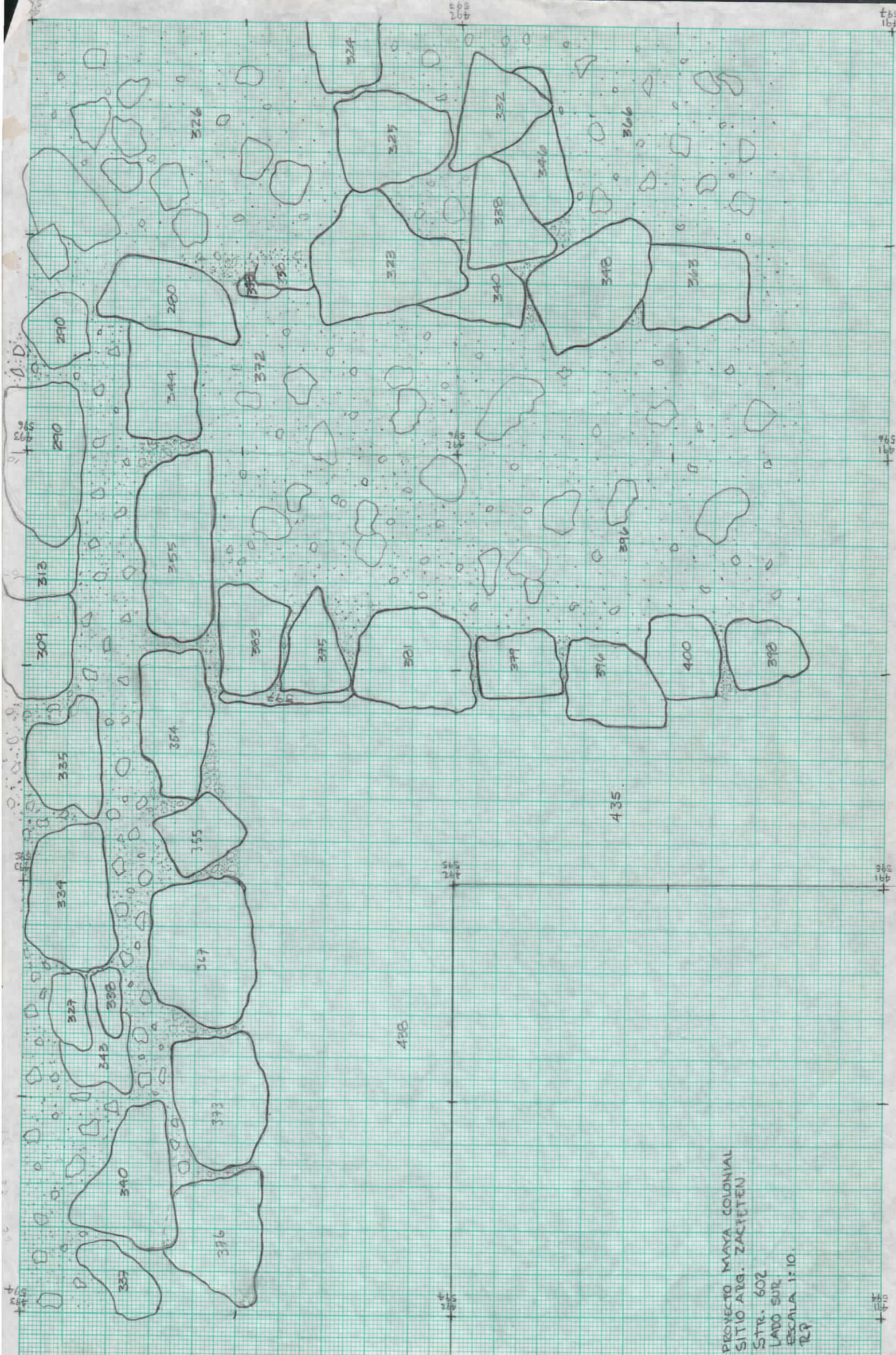

492
592

493
592

493
592

492
593

493
593

494
593

492
594

493
594

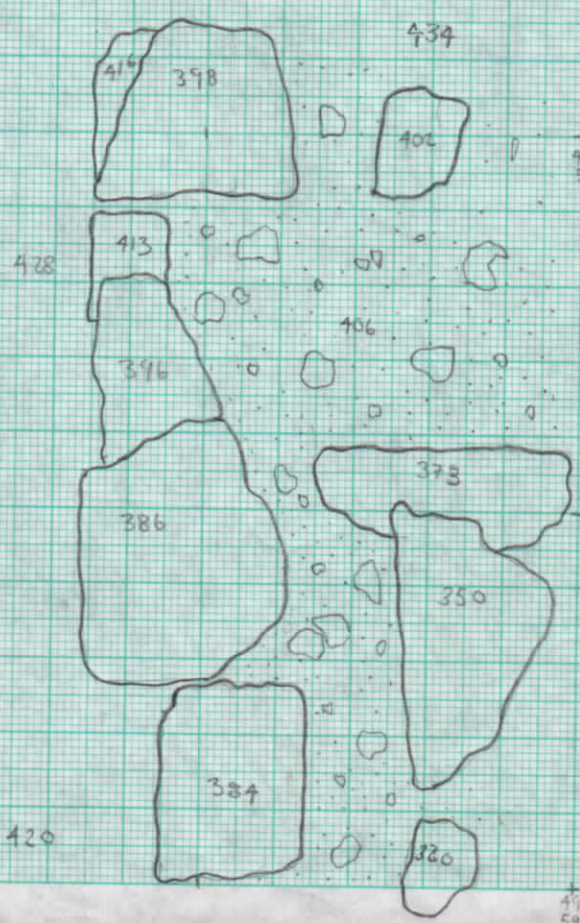

PROYECTO MAYA COLONIAL
 SITIO ARQ. ZACPETEN
 STR. 602
 ESQUINA SUROESTE
 ESCALA 1:10
 R.P.

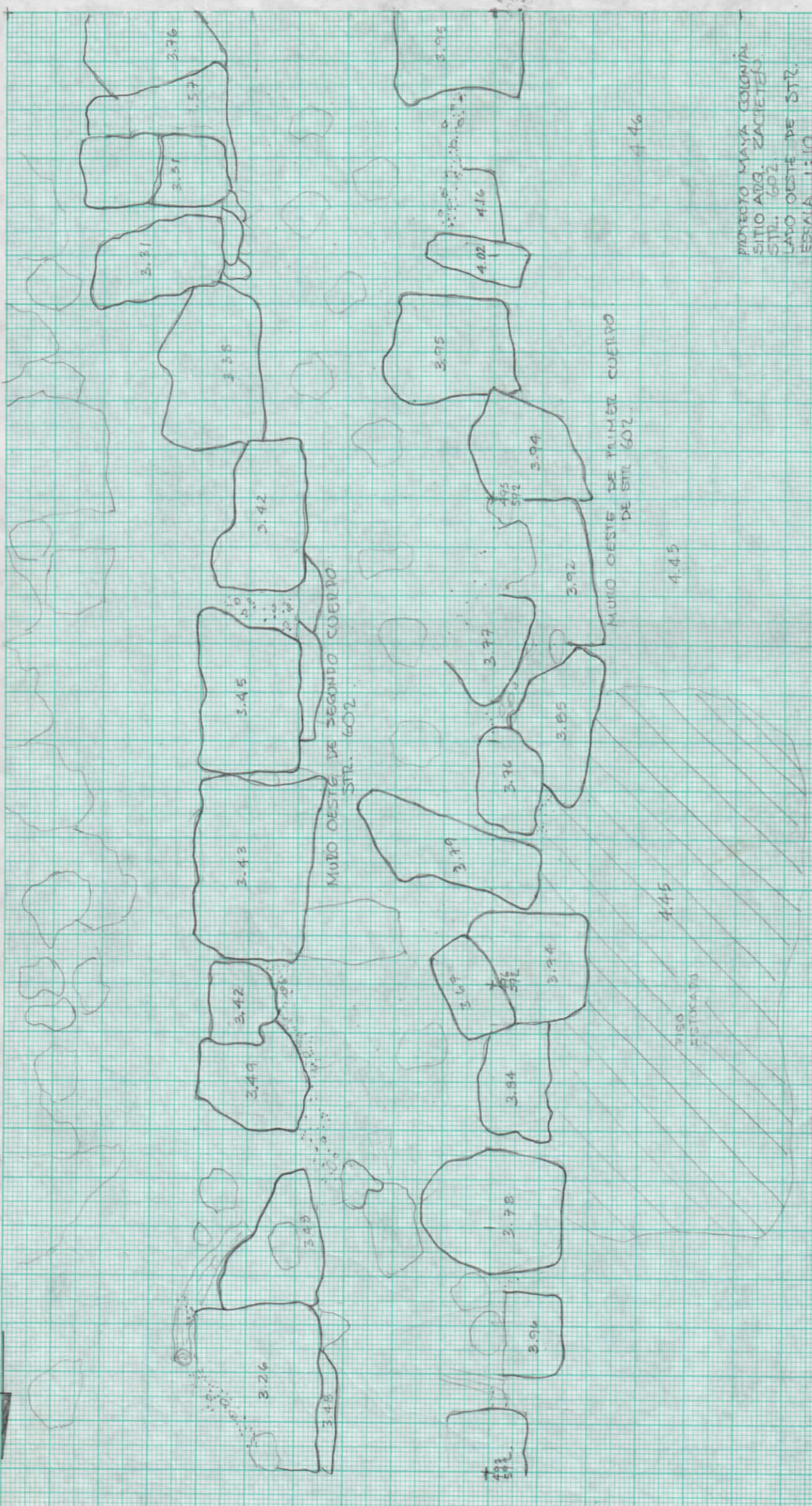

PROYECTO MAYA COLONIAL
 SITIO ADG. ZACATECO
 STR. 602
 LADO OESTE DE STR.
 R.S.
 15/3/97

491
592



PROYECTO MAYA COLONIAL
SITIO ATO. ZACATECA
SITE: 602
ESQUINA SURESTE (E10072)
Escala: 1:10
15/3/97

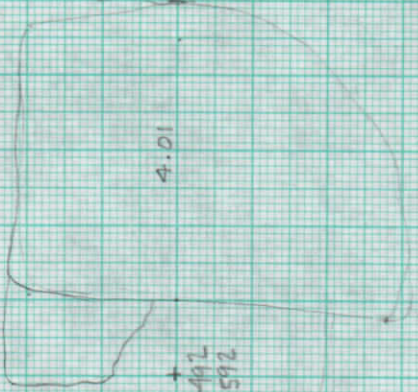
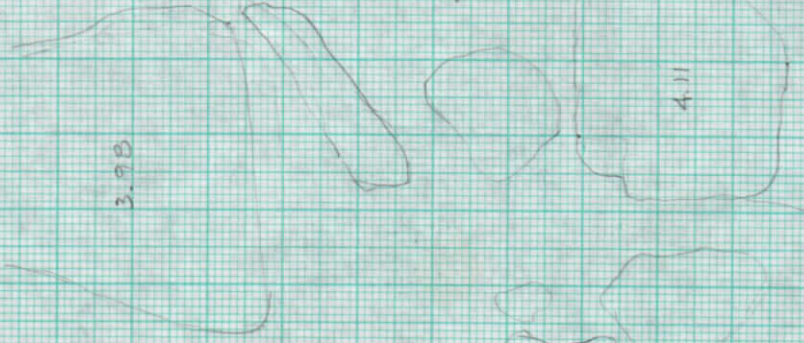
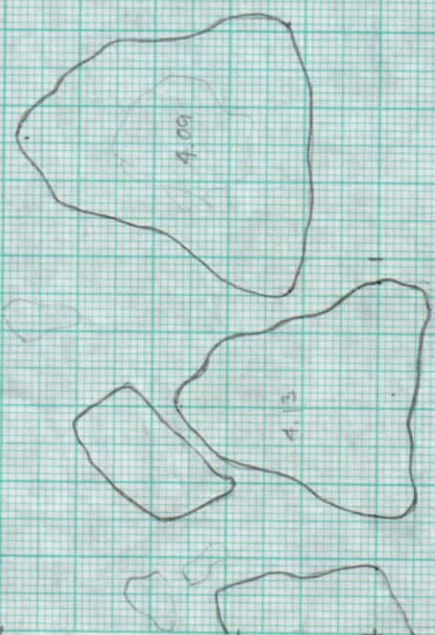
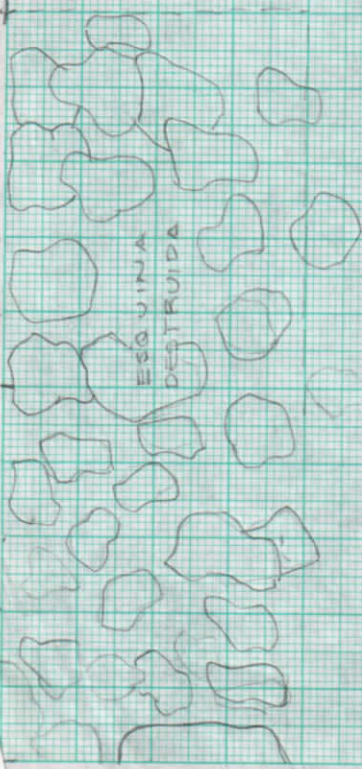

4.45

421

4.11

427

491
592

492
592

491
592

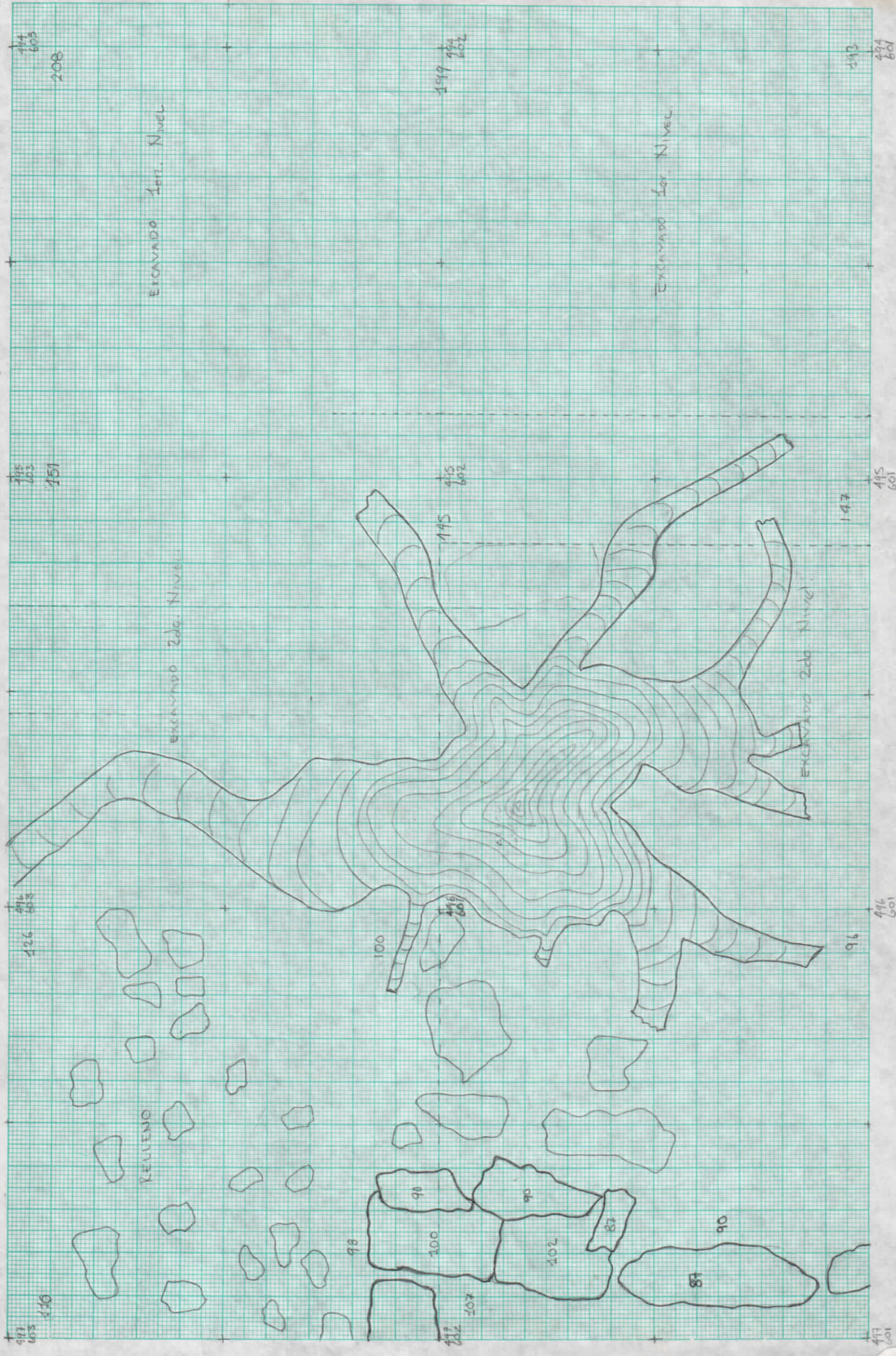

EXCAVADO 1er. NIVEL

EXCAVADO 2do. NIVEL

EXCAVADO 1er. NIVEL

EXCAVADO 2do. NIVEL

RELLENO

110

126

151

108

98

90

90

87

87

90

100

100

102

107

100

145

199

96

147

143

493

496

495

494

493

496

495

494



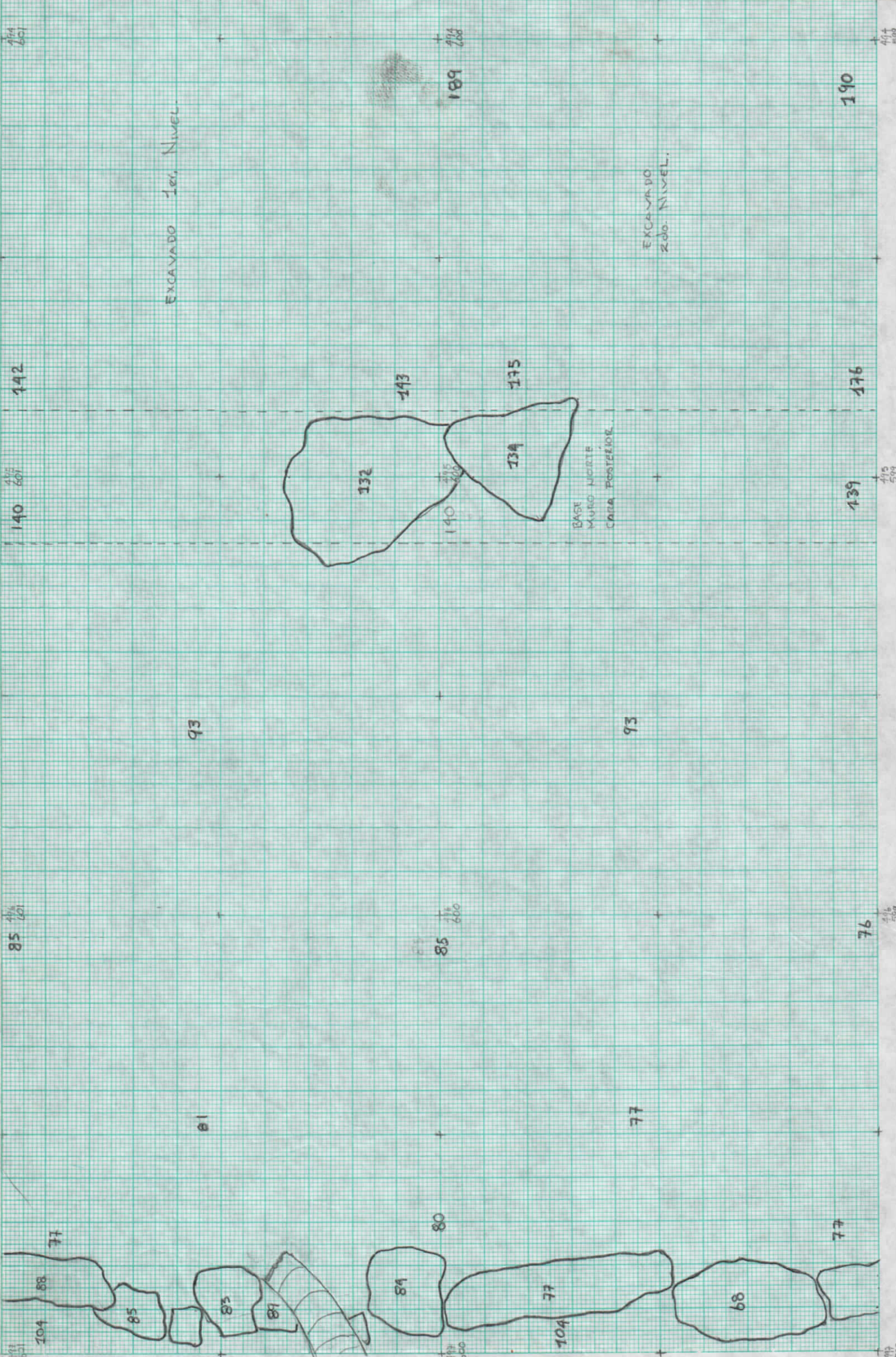

EXCAVADO 1er. Nivel.

EXCAVADO 2do. Nivel.

BASE MURD. NORTE
CASA POSTERIOR.

174
601

189
288

494
509

142

140

143

135

190

176

139

415
574

93

93

85

85

76

416
574

81

77

104

104

417
574

88

85

83

81

84

77

68

77

ESTRUCTURA 602
PARTE FRONTAL.
ESCALA 1:10

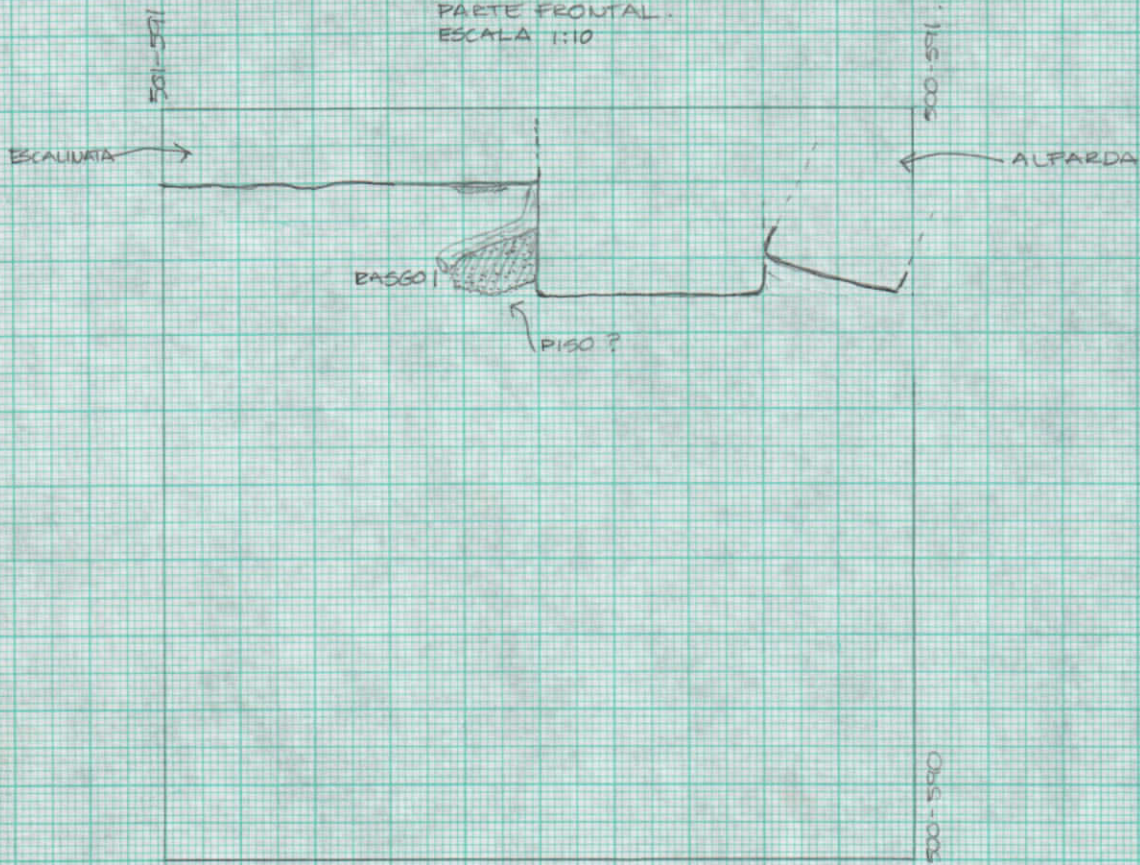

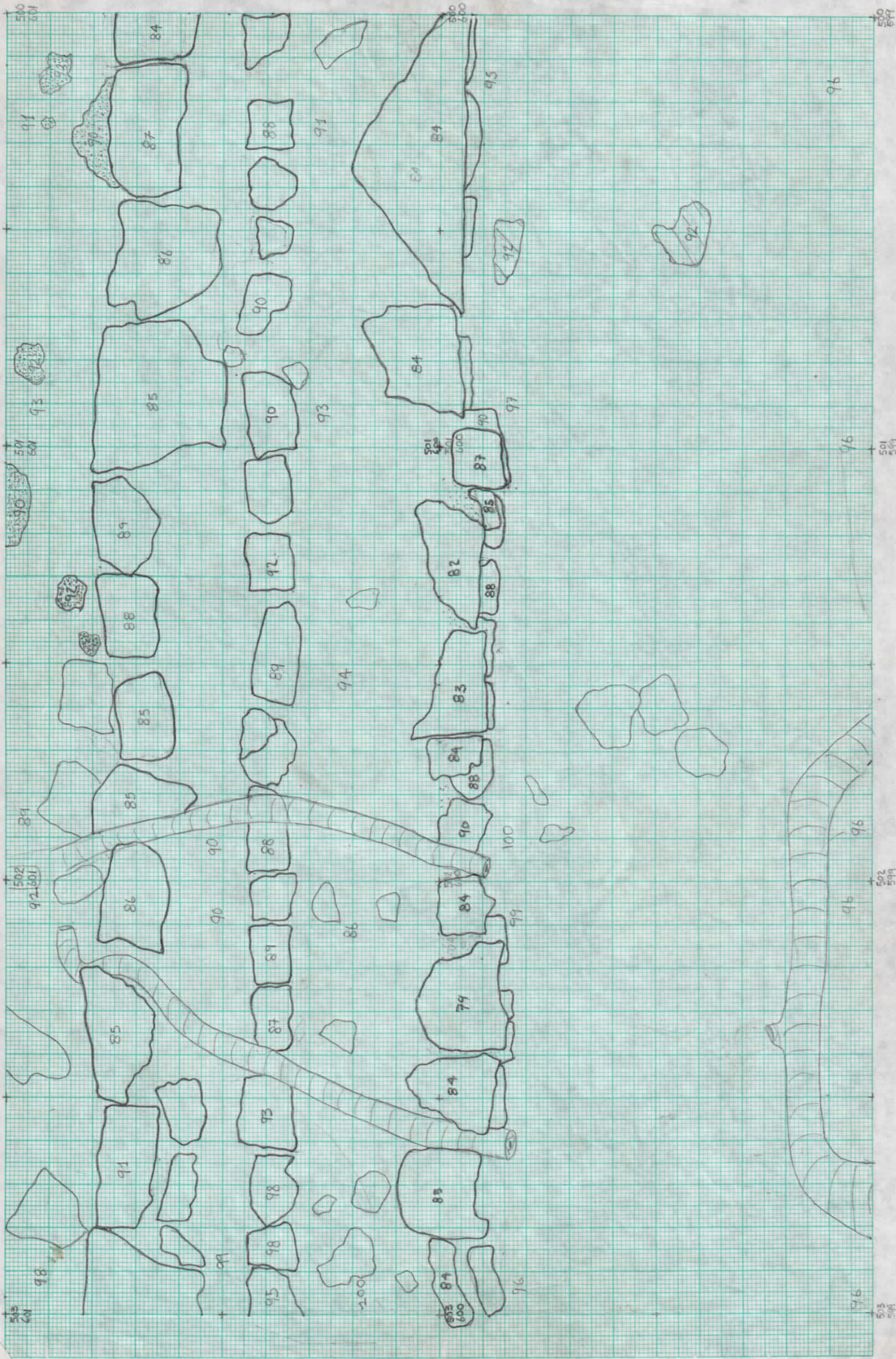

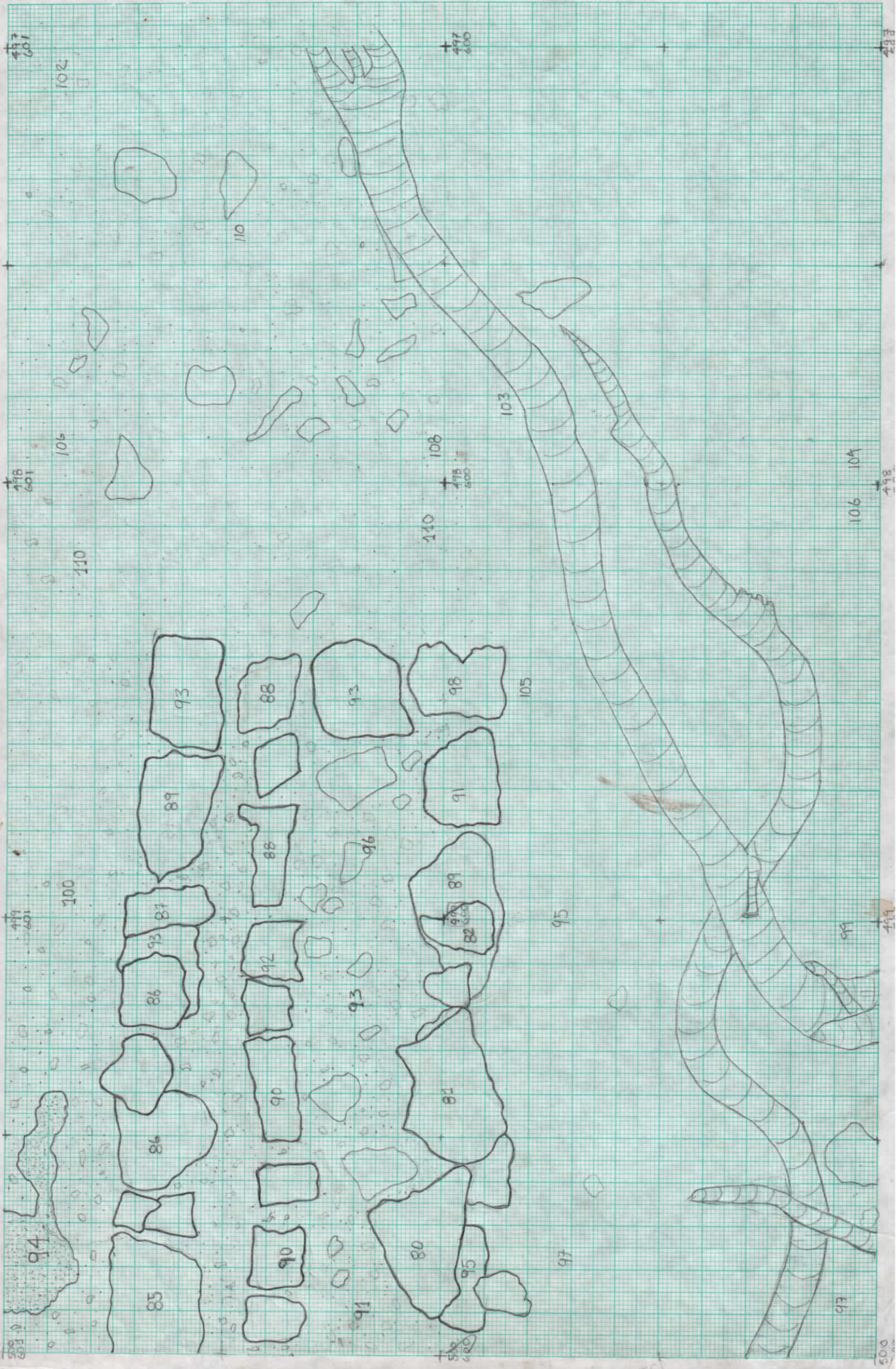

510
503
296

302
510
502

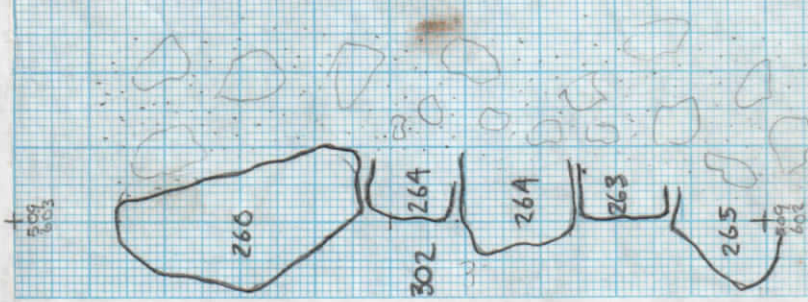

NO FUE EXCAVADO.

508
503

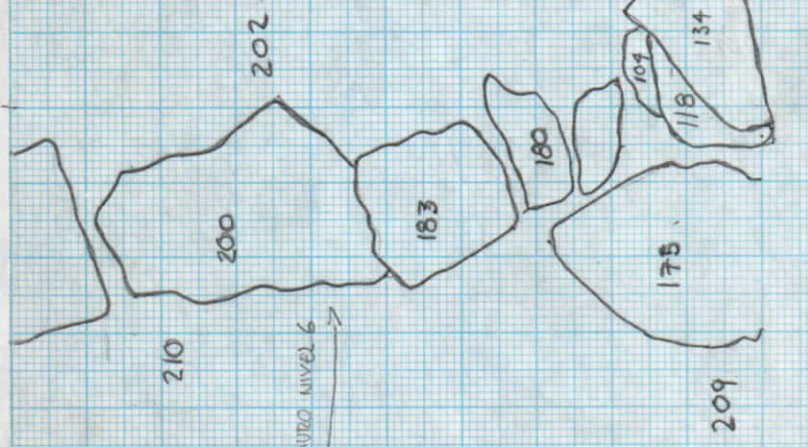

NO FUE EXCAVADO.

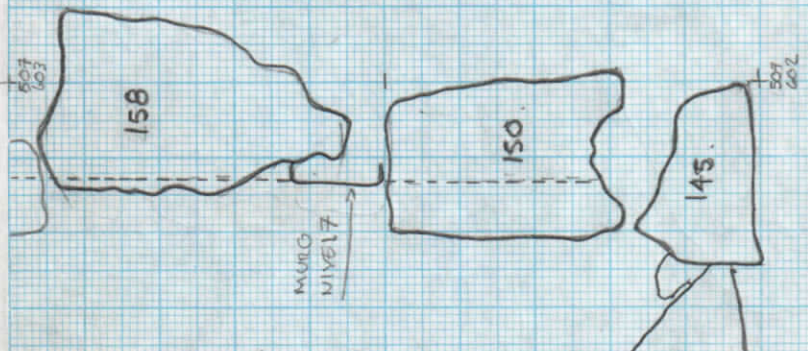

NO FUE EXCAVADO.

ESTOS TUBOS NO FUERON EXCAVADOS.

$$\frac{134}{12} = 11.166$$

506
503

502
502

502
501

507
502

508
501

509
502