

### Conversion of the Structure 605 1995 Grid to the 1996-1997 Group A Grid

Lote	Estructura.	1995 North	1995 East	Nivel.	New North	New East
4440	605	101	201	1	512.25	600.55
4492	605	101	201	2	512.25	600.55
4510	605	101	201	3	512.25	600.55
4437	605	101	202	1	512.2	601.55
4475	605	101	202	2	512.2	601.55
4438	605	101	203	1	512.15	602.55
4470	605	101	203	2	512.15	602.55
4442	605	101	204	1	512.1	603.55
4474	605	101	204	2	512.1	603.55
4436	605	101	205	1	512.05	604.55
4479	605	101	205	2	512.05	604.55
4427	605	101	206	1	512	605.55
4516	605	101	206	2	512	605.55
4455	605	102	201	1	513.25	600.6
4460	605	102	202	1	513.2	601.6
4494	605	102	202	2	513.2	601.6
4495	605	102	203	2	513.15	602.6
4433	605	102	204	1	513.1	603.6
4481	605	102	204	2	513.1	603.6
4443	605	102	205	1	513.05	604.6
4483	605	102	205	2	513.05	604.6
4434	605	102	206	1	513	605.6
4497	605	102	206	2	513	605.6
4445	605	103	201	1	514.25	600.65
4445	605	103	201	1	514.25	600.65
4466	605	103	202	1	514.2	601.65
4480	605	103	202	2	514.2	601.65
4464	605	103	203	1	514.15	602.65
4488	605	103	203	2	514.15	602.65
4439	605	103	204	1	514.1	603.65
4459	605	103	204	1	514.1	603.65
4457	605	103	205	1	514.05	604.65
4478	605	103	205	2	514.05	604.65
4435	605	103	206	1	514	605.65
4498	605	103	206	2	514	605.65
4454	605	104	201	1	515.25	600.7
4468	605	104	202	1	515.2	601.7
4482	605	104	202	2	515.2	601.7
4473	605	104	203	1	515.15	602.7
4477	605	104	203	2	515.15	602.7
4465	605	104	204	1	515.1	603.7
4486	605	104	204	2	515.1	603.7
4463	605	104	205	1	515.05	604.7
4496	605	104	205	2	515.05	604.7
4505	605	104	206	2	515	605.7
4469	605	105	202	1	516.2	601.75
?	605	105	202	2	516.2	601.75

4451	605	105	203	1	516.15	602.75
4472	605	105	203	2	516.15	602.75
4504	605	105	204	2	516.1	603.75
4452	605	105	205	1	516.05	604.75
4461	605	105	205	1	516.05	604.75
4503	605	105	205	2	516.05	604.75
4456	605	105	206	1	516	605.75
4507	605	105	206	2	516	605.75
4462	605	106	201	1	517.25	600.8
4476	605	106	202	1	517.2	601.8
4524	605	106	202	2	517.2	601.8
4467	605	106	203	1	517.15	602.8
4485	605	106	203	2	517.15	602.8
4446	605	106	204	1	517.1	603.8
4487	605	106	204	2	517.1	603.8
4450	605	106	205	1	517.05	604.8
4458	605	106	206	1	517	605.8
4484	605	106	206	2	517	605.8
4500	605	107	201	1	518.25	600.85
4520	605	107	201	2	518.25	600.85
4517	605	107	202	1	518.2	601.85
4512	605	107	203	2	518.15	602.85
4515	605	107	203	1	518.15	602.85
4493	605	107	204	1	518.1	603.85
4511	605	107	204	2	518.1	603.85
4489	605	107	205	1	518.05	604.85
4506	605	107	205	2	518.05	604.85
4491	605	107	206	1	518	605.85
4514	605	107	206	2	518	605.85
4509	605	108	201	1	519.25	600.9
4522	605	108	201	2	519.25	600.9
4490	605	108	202	1	519.2	601.9
4521	605	108	202	2	519.2	601.9
4499	605	108	203	1	519.15	602.9
4518	605	108	204	1	519.1	603.9
4526	605	108	204	2	519.1	603.9
4501	605	108	205	1	519.05	604.9
4508	605	108	205	2	519.05	604.9
4525	605	108	205	2	519.05	604.9
4502	605	108	206	1	519	605.9
4519	605	108	206	2	519	605.9

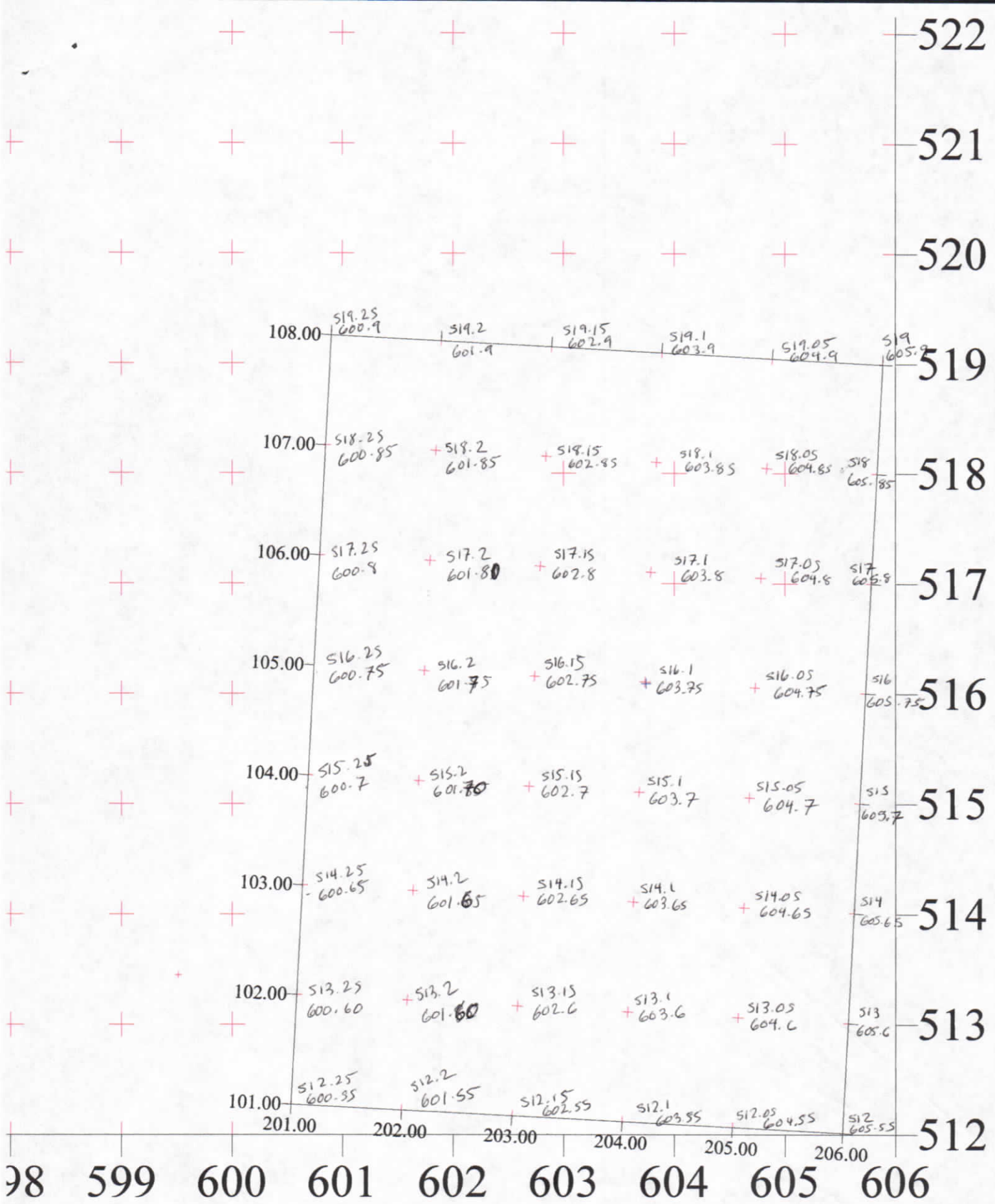

Zacpeten

Str. 605

Relationship of Present Grid with  
that of 1995

TP

7/24/96

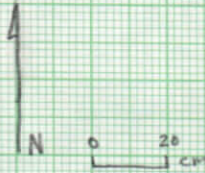

The 1995 grid is ( )

This may be off a little 8/6/96.  
Use the measurement made with the  
transit

518  
602

(106, 201)  
⊕

517  
600

516  
600

515  
600

514  
600

(102, 201)  
⊕ nail

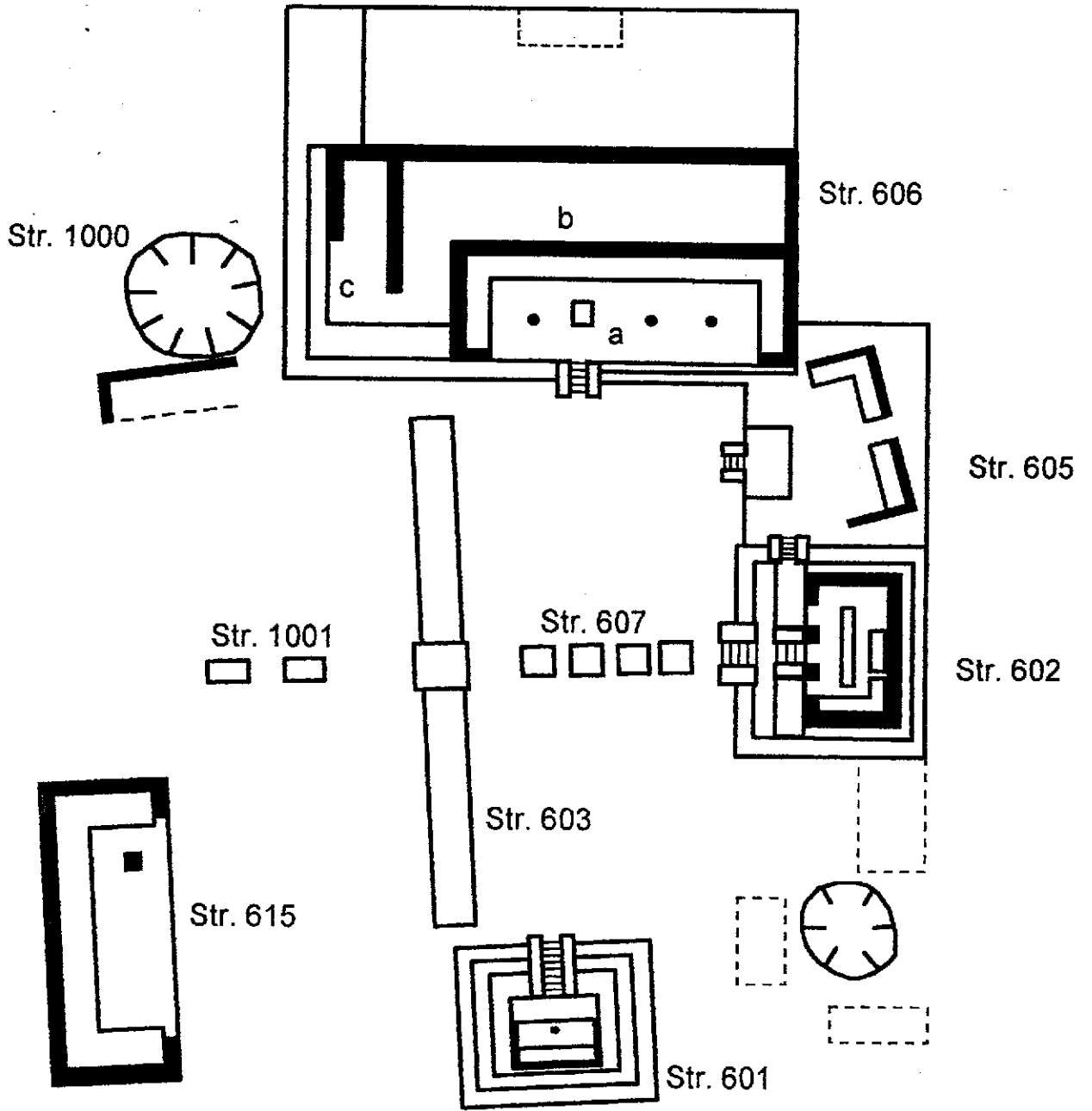

**Zacpeten, Group A**

Proyecto Maya-Colonial 1996

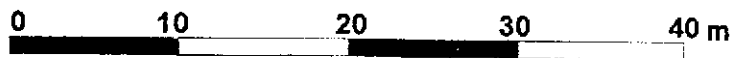

this profile is on E wall

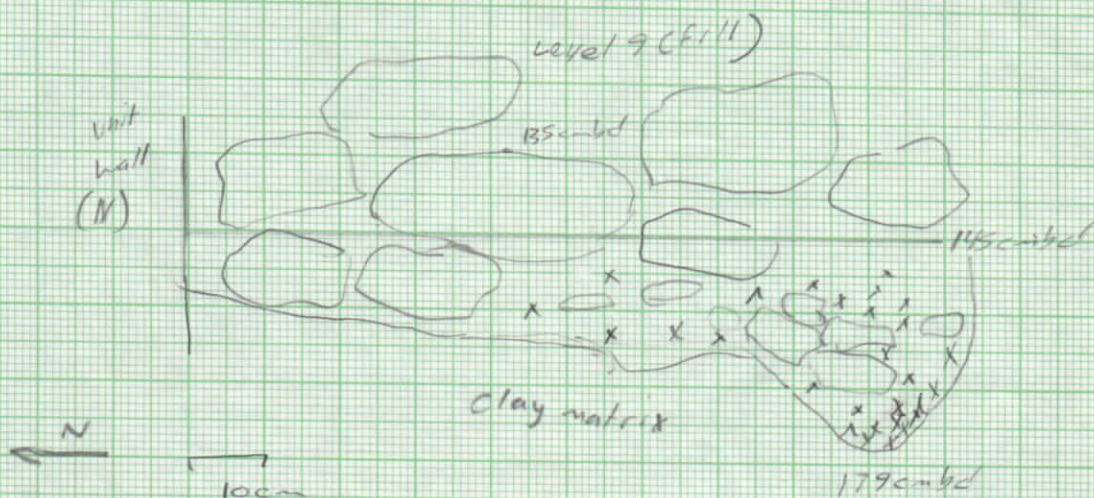

## Profile Level 10

x - wood charcoal

A layer of large cobbles which is part of the fill seems to have been placed over a layer of smaller cobbles with abundant wood charcoal. The matrix is dark brown below is a well distinguishable clayey matrix  
 \* devoid of carbon and large stones

Zacpeten  
 Str. 605, 518,  
 603  
 KRS  
 7/1/96

Zacpeten  
Str. 605  
518,603  
KS  
1/18/96

(South) Frontal view of wall (E-W)



wall is one course thick

wall is 20-40 cm thick  
thicker at base  
(no mortar)

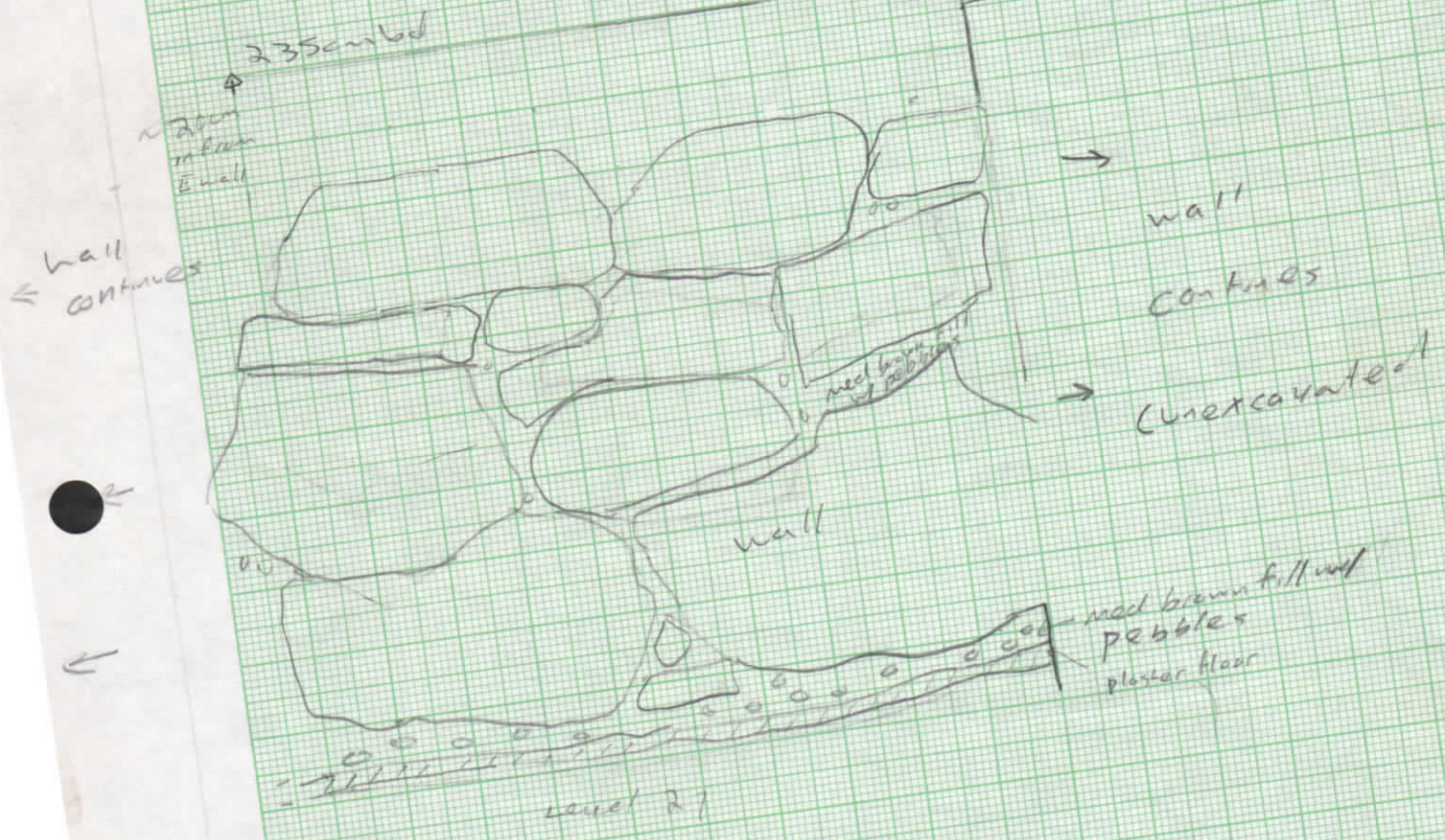

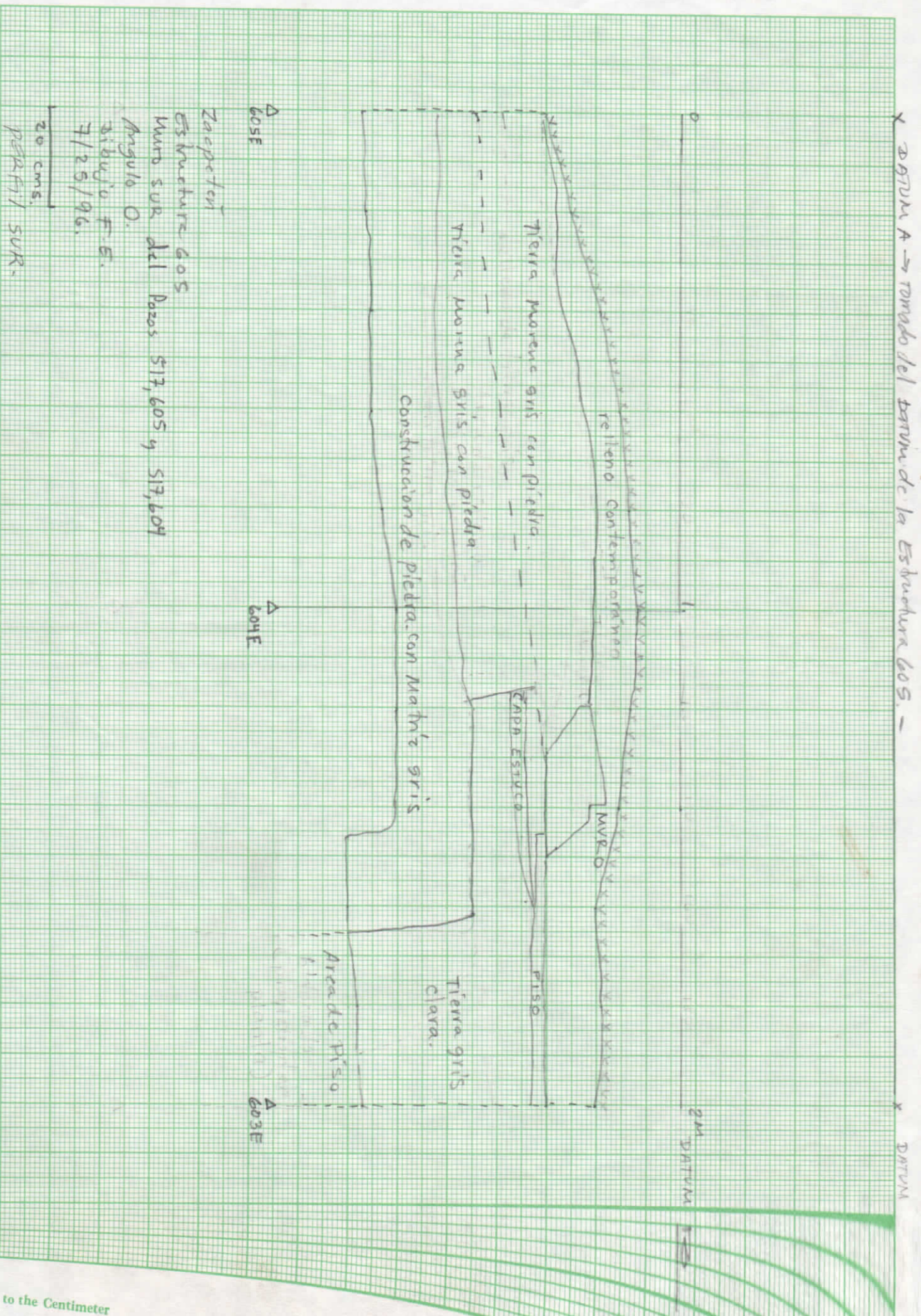



Zacpeten  
Str. 605/602  
Unit 510, 597  
Base of Level '02  
Platifact  
JP  
7/31/96

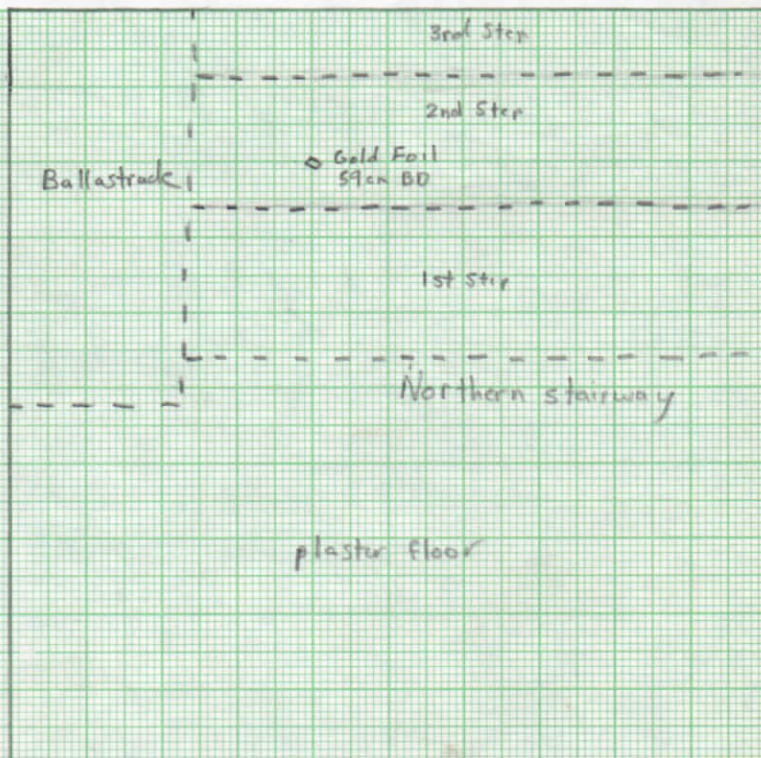
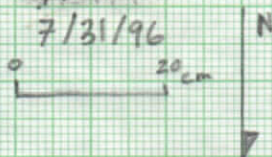

A piece of gold foil was found on the second step of the northern stairway approximately 15cm to the west of the eastern ballustrade. It was located in a layer of soil at least about 1/2 cm above the actual stone of the stairway. This seems to confirm my suspicion that a cache was deposited somewhere in this area - do not forget the red stepped vessels to the southeast.

I guess this suggests some Yucatecan connection (as does the <sup>griffin</sup> bell font nearby)

Zacpeten  
KS

7-23-96

Sta. 605

518,606

10cm



level 26

center of  
the  
518,604

top of  
Level 3b

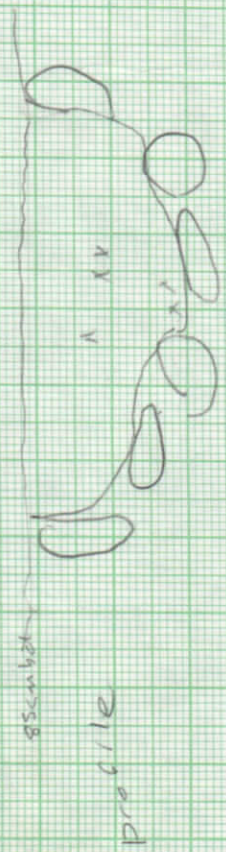
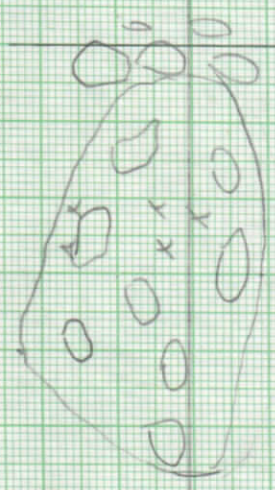

empty cache-like feature underneath  
the corner of bench (level 26)  
d. grey brown matrix w/  
charcoal and a seed (potato) sample  
taken)

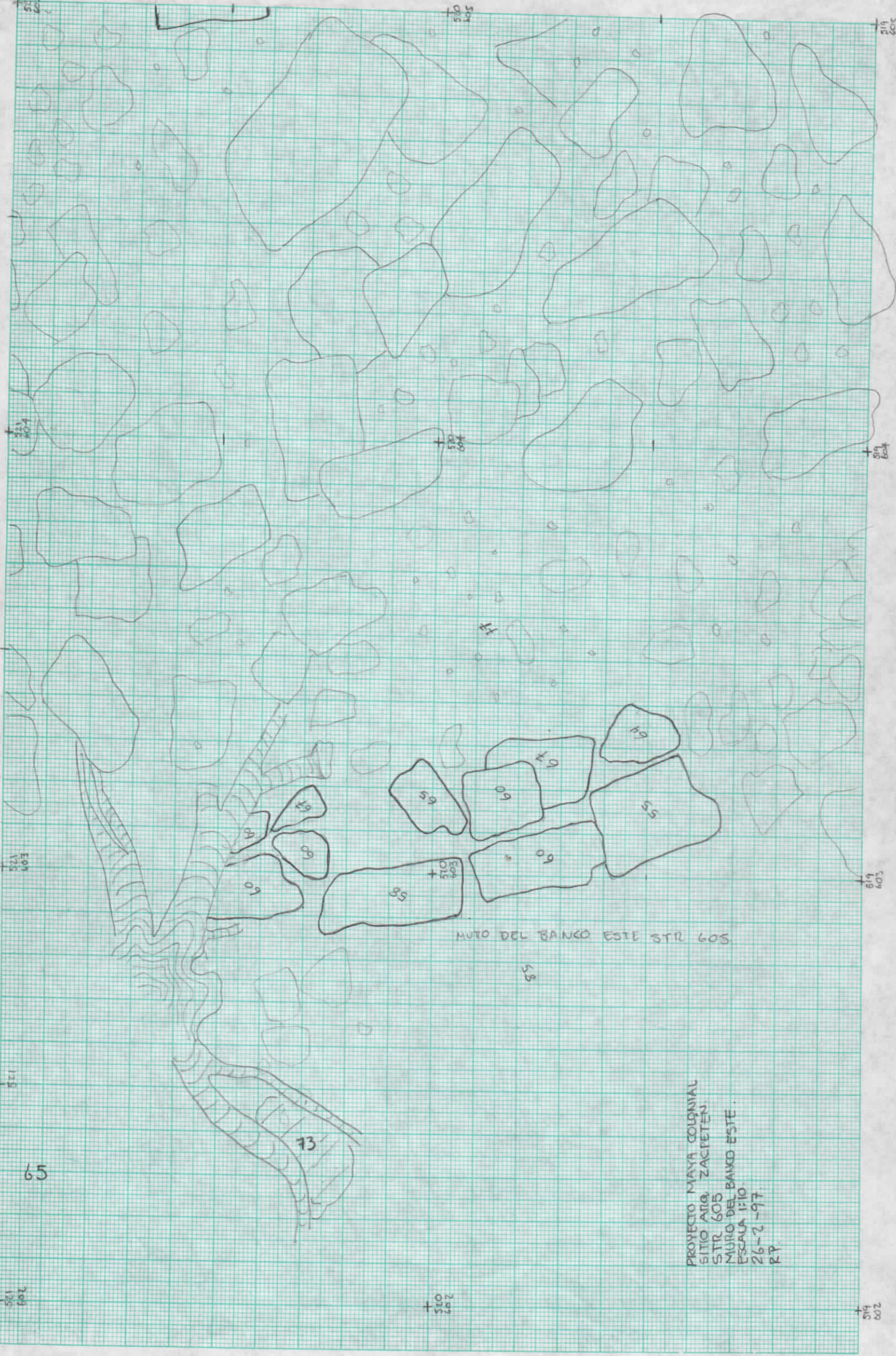

MURO DEL BANCO ESTE STR 605

PROYECTO MAYA COLONIAL  
 SITIO Arq. ZACIETEN.  
 STR 605  
 MURO DEL BANCO ESTE.  
 ESCALA 1:10  
 26-2-97  
 R.P.

65

73

58

58

79

79

59

69

55

60

60

61

62

63

64

209  
015

209  
015

209  
118

209  
018

209  
012

209  
125

125

209  
125

209  
014

209  
012

Maps  
518,606

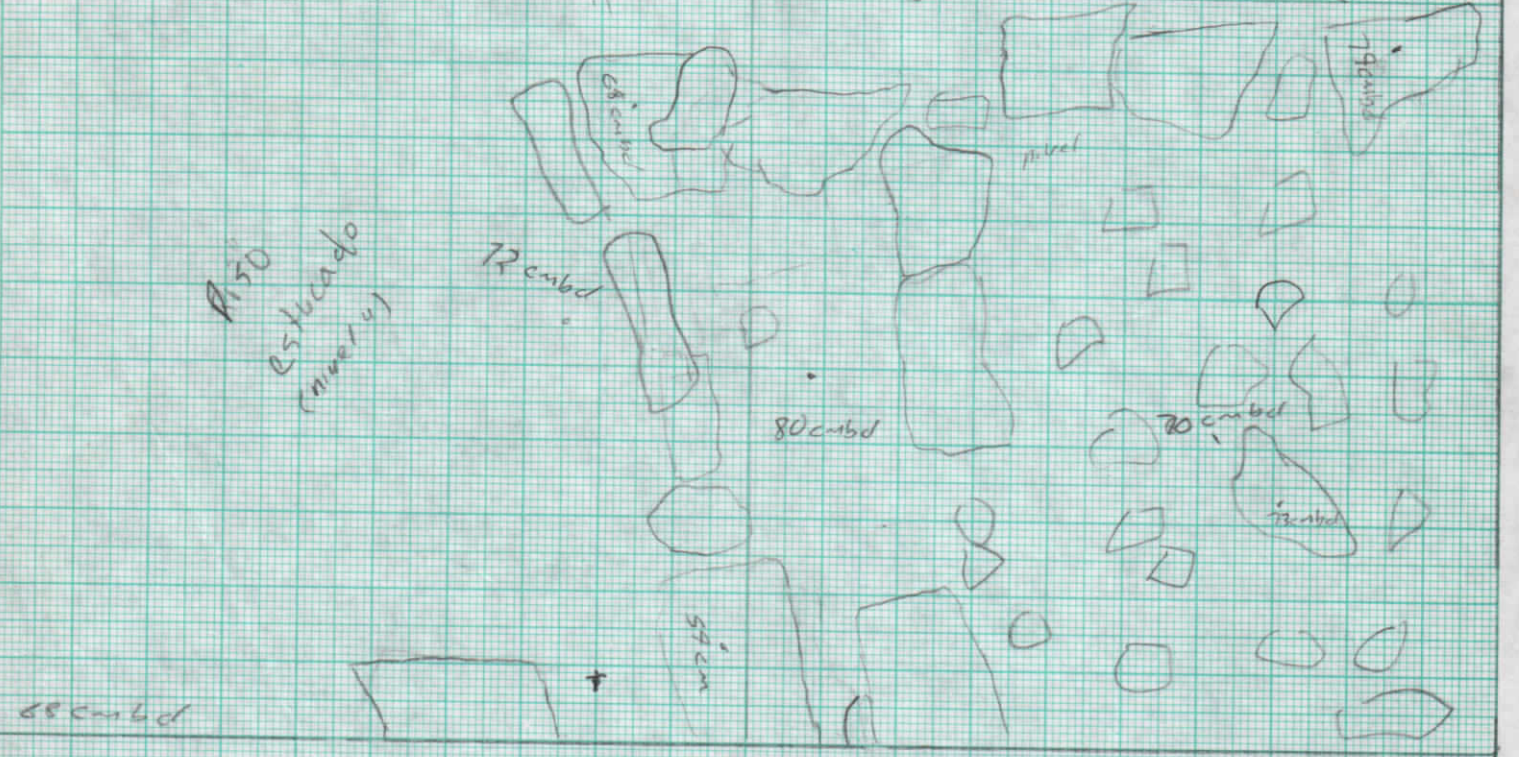
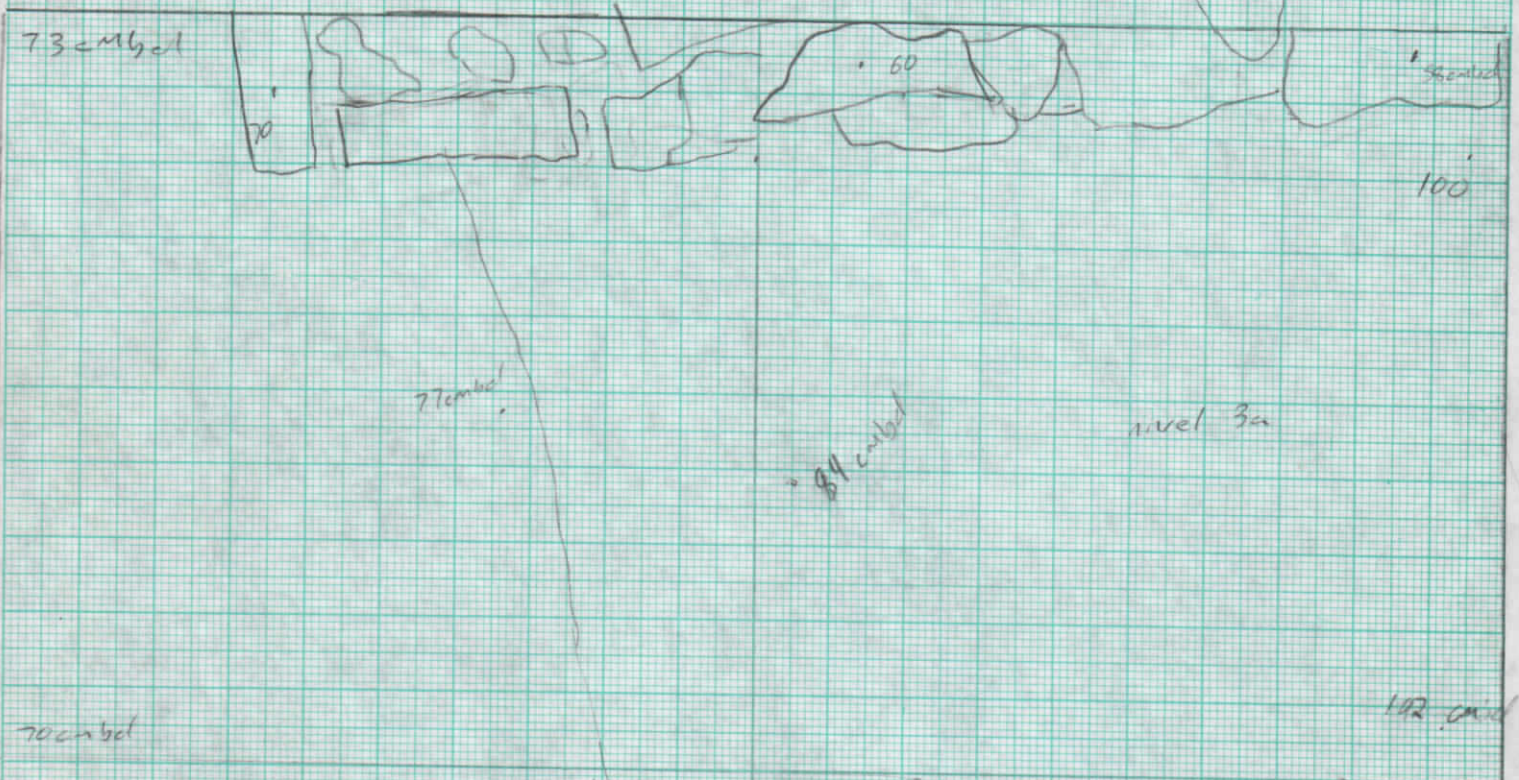

+ - 1995 cat na 1

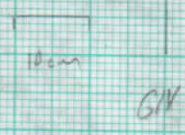

518,606  
Zacpaten  
KS  
7-22-96

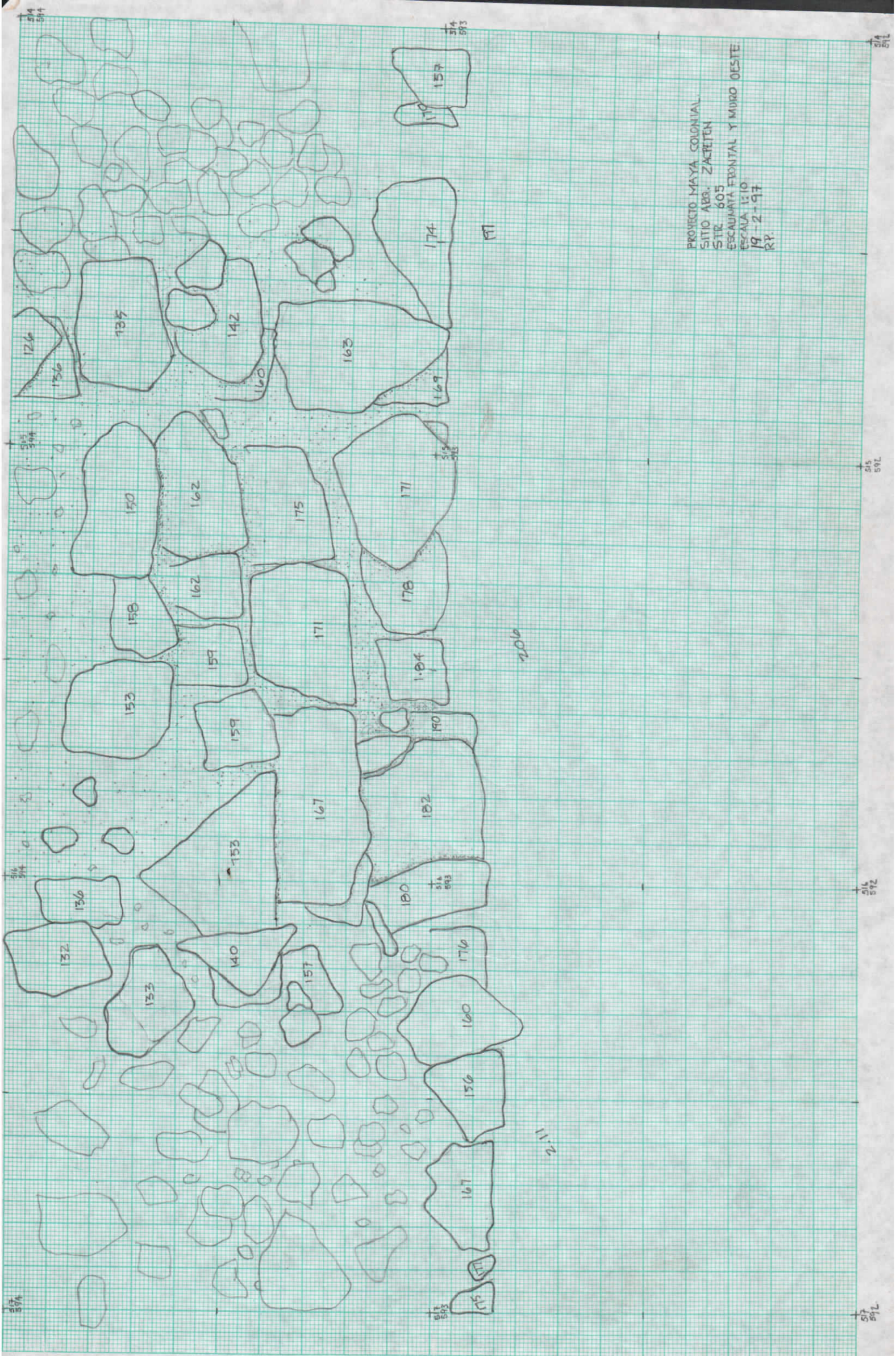

PROYECTO MAYA COLONIAL.  
 SITIO ABB. ZACATEN  
 STR. 605  
 ESCALINATA FRONTAL Y MURDO OESTE  
 ESCALA 1:10  
 19-2-97  
 RP.

514  
513  
512  
511  
510  
509  
508  
507  
506  
505  
504  
503  
502  
501  
500  
499  
498  
497  
496  
495  
494  
493  
492  
491  
490  
489  
488  
487  
486  
485  
484  
483  
482  
481  
480  
479  
478  
477  
476  
475  
474  
473  
472  
471  
470  
469  
468  
467  
466  
465  
464  
463  
462  
461  
460  
459  
458  
457  
456  
455  
454  
453  
452  
451  
450  
449  
448  
447  
446  
445  
444  
443  
442  
441  
440  
439  
438  
437  
436  
435  
434  
433  
432  
431  
430  
429  
428  
427  
426  
425  
424  
423  
422  
421  
420  
419  
418  
417  
416  
415  
414  
413  
412  
411  
410  
409  
408  
407  
406  
405  
404  
403  
402  
401  
400  
399  
398  
397  
396  
395  
394  
393  
392  
391  
390  
389  
388  
387  
386  
385  
384  
383  
382  
381  
380  
379  
378  
377  
376  
375  
374  
373  
372  
371  
370  
369  
368  
367  
366  
365  
364  
363  
362  
361  
360  
359  
358  
357  
356  
355  
354  
353  
352  
351  
350  
349  
348  
347  
346  
345  
344  
343  
342  
341  
340  
339  
338  
337  
336  
335  
334  
333  
332  
331  
330  
329  
328  
327  
326  
325  
324  
323  
322  
321  
320  
319  
318  
317  
316  
315  
314  
313  
312  
311  
310  
309  
308  
307  
306  
305  
304  
303  
302  
301  
300  
299  
298  
297  
296  
295  
294  
293  
292  
291  
290  
289  
288  
287  
286  
285  
284  
283  
282  
281  
280  
279  
278  
277  
276  
275  
274  
273  
272  
271  
270  
269  
268  
267  
266  
265  
264  
263  
262  
261  
260  
259  
258  
257  
256  
255  
254  
253  
252  
251  
250  
249  
248  
247  
246  
245  
244  
243  
242  
241  
240  
239  
238  
237  
236  
235  
234  
233  
232  
231  
230  
229  
228  
227  
226  
225  
224  
223  
222  
221  
220  
219  
218  
217  
216  
215  
214  
213  
212  
211  
210  
209  
208  
207  
206  
205  
204  
203  
202  
201  
200  
199  
198  
197  
196  
195  
194  
193  
192  
191  
190  
189  
188  
187  
186  
185  
184  
183  
182  
181  
180  
179  
178  
177  
176  
175  
174  
173  
172  
171  
170  
169  
168  
167  
166  
165  
164  
163  
162  
161  
160  
159  
158  
157  
156  
155  
154  
153  
152  
151  
150  
149  
148  
147  
146  
145  
144  
143  
142  
141  
140  
139  
138  
137  
136  
135  
134  
133  
132  
131  
130  
129  
128  
127  
126  
125  
124  
123  
122  
121  
120  
119  
118  
117  
116  
115  
114  
113  
112  
111  
110  
109  
108  
107  
106  
105  
104  
103  
102  
101  
100  
99  
98  
97  
96  
95  
94  
93  
92  
91  
90  
89  
88  
87  
86  
85  
84  
83  
82  
81  
80  
79  
78  
77  
76  
75  
74  
73  
72  
71  
70  
69  
68  
67  
66  
65  
64  
63  
62  
61  
60  
59  
58  
57  
56  
55  
54  
53  
52  
51  
50  
49  
48  
47  
46  
45  
44  
43  
42  
41  
40  
39  
38  
37  
36  
35  
34  
33  
32  
31  
30  
29  
28  
27  
26  
25  
24  
23  
22  
21  
20  
19  
18  
17  
16  
15  
14  
13  
12  
11  
10  
9  
8  
7  
6  
5  
4  
3  
2  
1  
0

PROYECTO MAYA COLONIAL 514  
SITIO ARQ. ZACIETEU 515  
STR. 605  
MUROS AL ESTE DE CAJALILMA  
ESCALA 1:20  
19-2-97  
RP

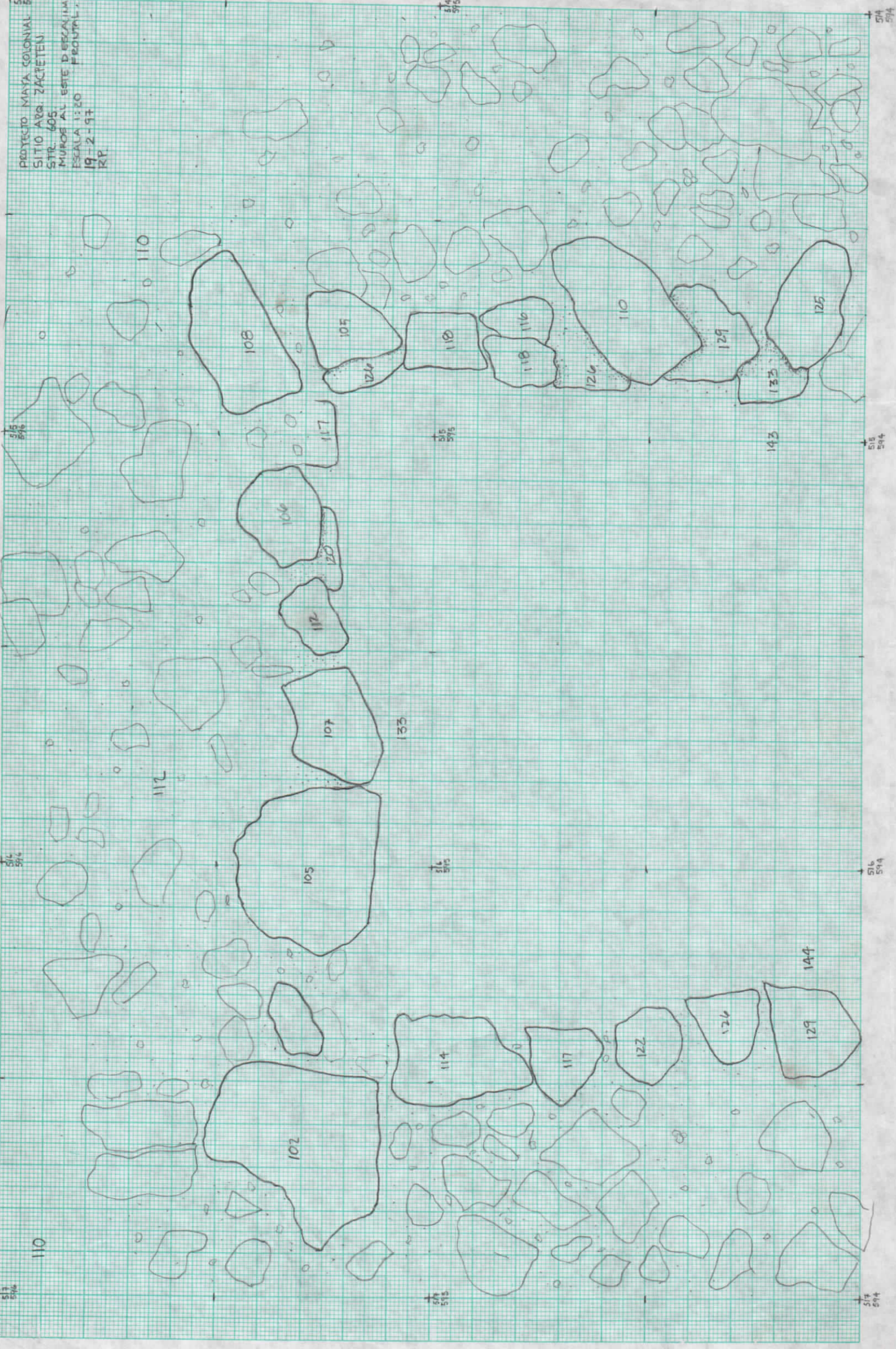

PROYECTO MAYA COLONIAL  
SITIO ARG. ZACATEEN  
CTR. 605  
LADO OESTE.  
ESCALA 1:10.  
20-2-97.  
K.P.

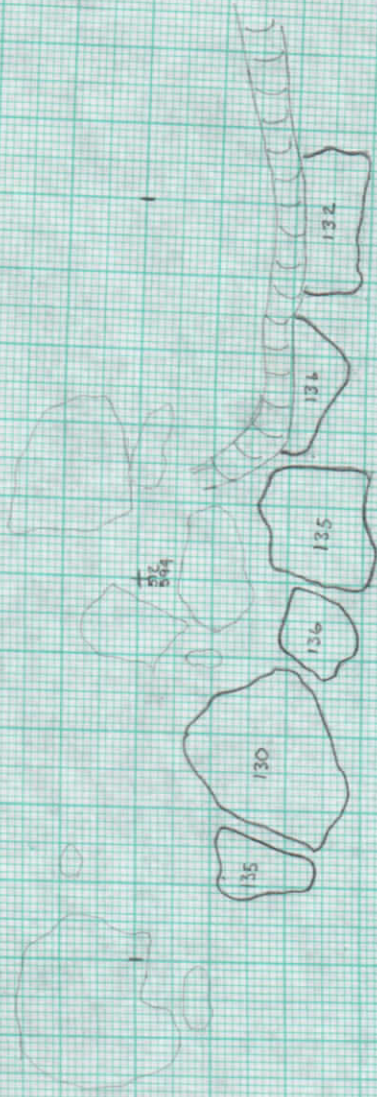

— ESTA PARTE DE LA ESTRUCTURA NO FUE EXCAVADA.  
— ESTOS DOS MUROS APARECEN EN LA SUPERFICIE.

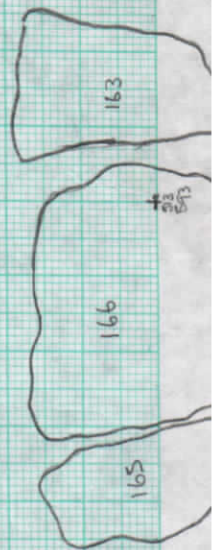

69  
70  
18  
75

PROYECTO MAYA COLONIAL  
SITIO ABO. ZACATEN  
STR 605  
Muros sur y este  
STR 607  
ESCALA 1:10  
20-2-97  
RP



STR 606

STR 605

MURO SUR

521  
598

521  
598

521  
598

521  
598

520  
597

520  
597

520  
598

520  
599

519  
598

519  
598

519  
598

519  
599



PROYECTO MAYA COLONIAL  
SITIO ATR. ZACATEEN  
STR 605  
MURO SUR DEL BANCO NORTE  
ESCALA 1:10  
20-2-97  
R.P.

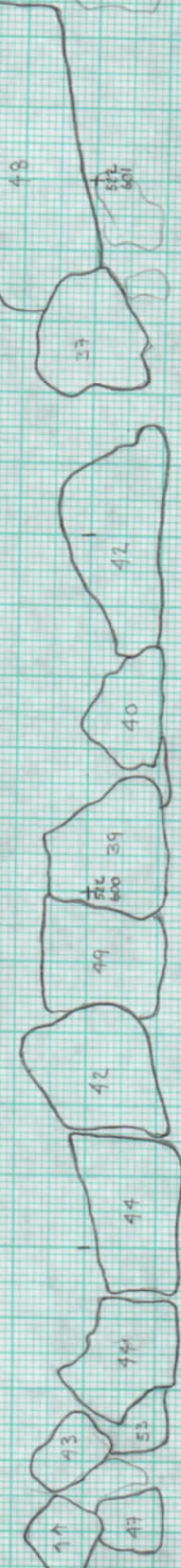
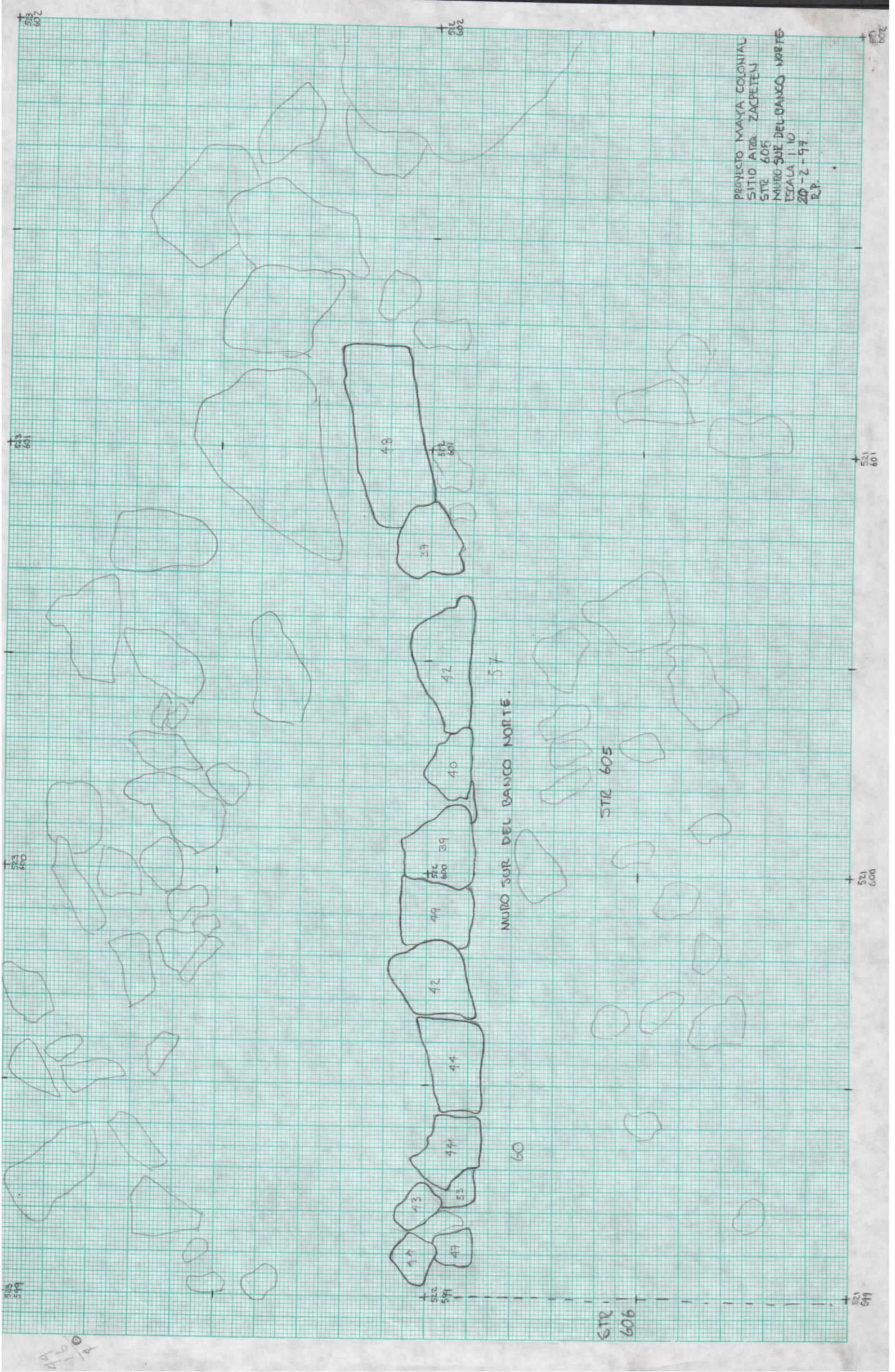

MURO SUR DEL BANCO NORTE. 57

STR 605

60

STR 606

420  
10  
R

523  
602

522  
602

523  
601

521  
601

523  
600

521  
600

524  
600

524  
600

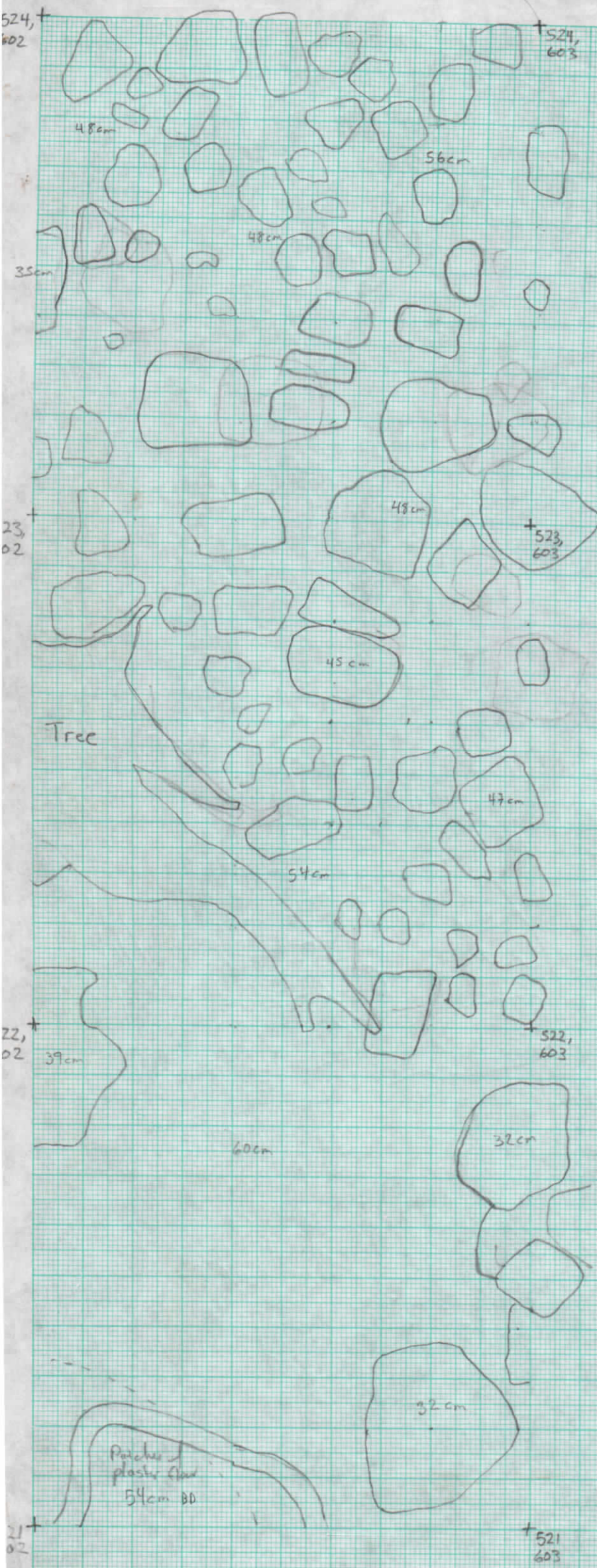

Zacpeten

Str. 605

Planview of Structure

Units 524, 603; 523, 603  
and 522, 603

TP

3/6/97

0 20 cm N

When checking the planview of Str 605, I noticed that this area was missing. This is a replacement drawing, should the drawing by Rogan Puga be recovered, it should be used instead of this one so that the entire structure is drawn by the same person.

PROYECTO MAYA COLONIAL  
SITIO ARQUEOLOGICO ZACPETEN  
ESCALINATA OESTE ESTRUCTURA 605  
ESCALA 1:100 17/2/97  
BC.

1.44 BAJO DATUM.



518-593

516-593

515-593

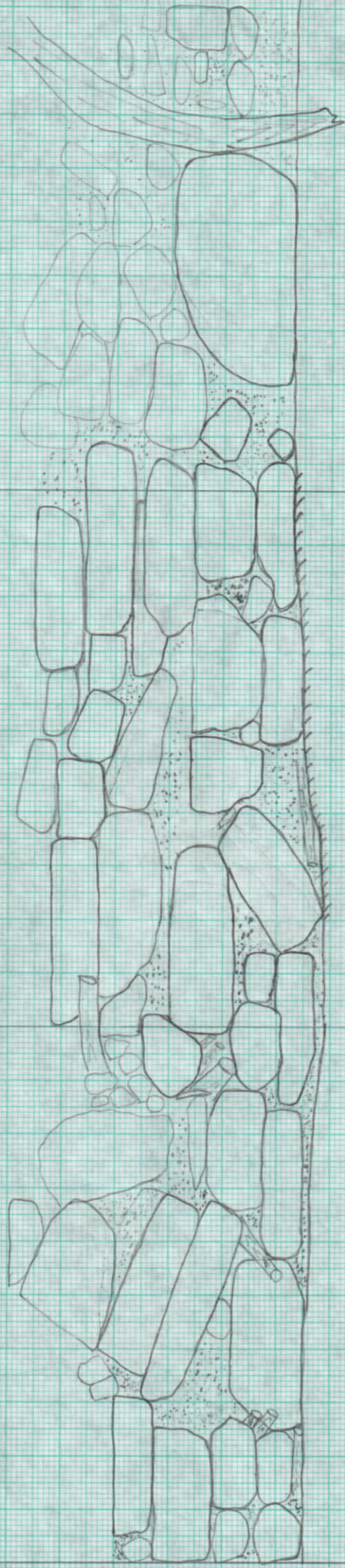

PROYECTO MAYA COLONIAL  
SITIO ARQ. ZACPETEN  
MURO ESTE (ARRIBA DE ESCALINATA).  
ESCALA 1:100 (7/12/97).  
B.C.

0.80. CM NIVEL BAJO DATUM.

