

534/593

534/594

534/595

533/593

533/595

532/592

532/594

532/596

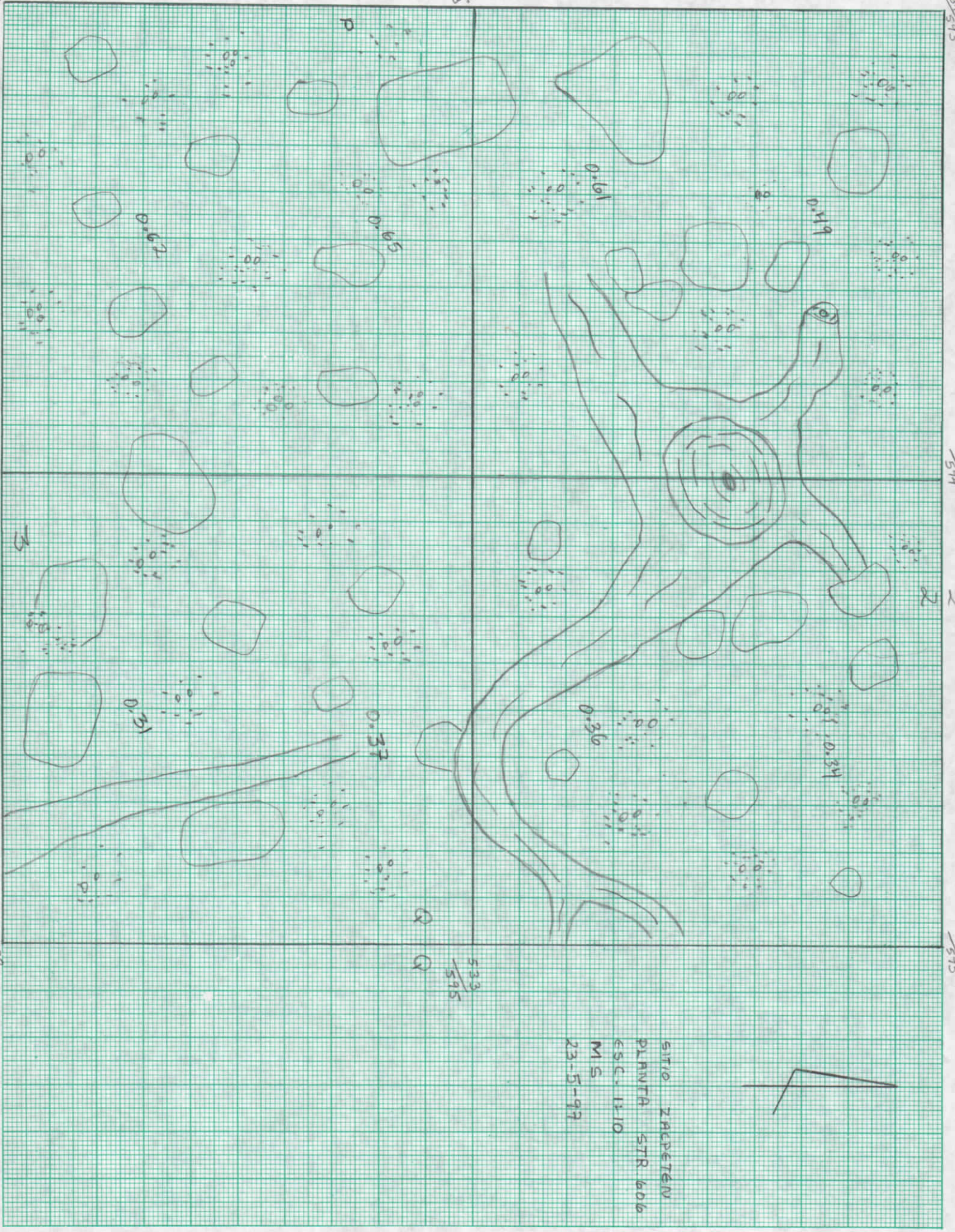

SITO ZACRETEAN  
 PLANTA STR 606  
 ESC. 1:10  
 M 5  
 23-5-99

53 2/543

53 2/591

3 3

53 2/595

53 2/593

P P

53 2/595

53 2/591

4 4

53 2/595



SITIO: ZHOPETAN  
 PIAVITA STR. 606  
 M5  
 23-5-97

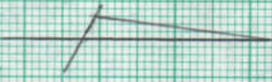

530/591

531/591

532/591

530/592

532/592

530/593

532/593

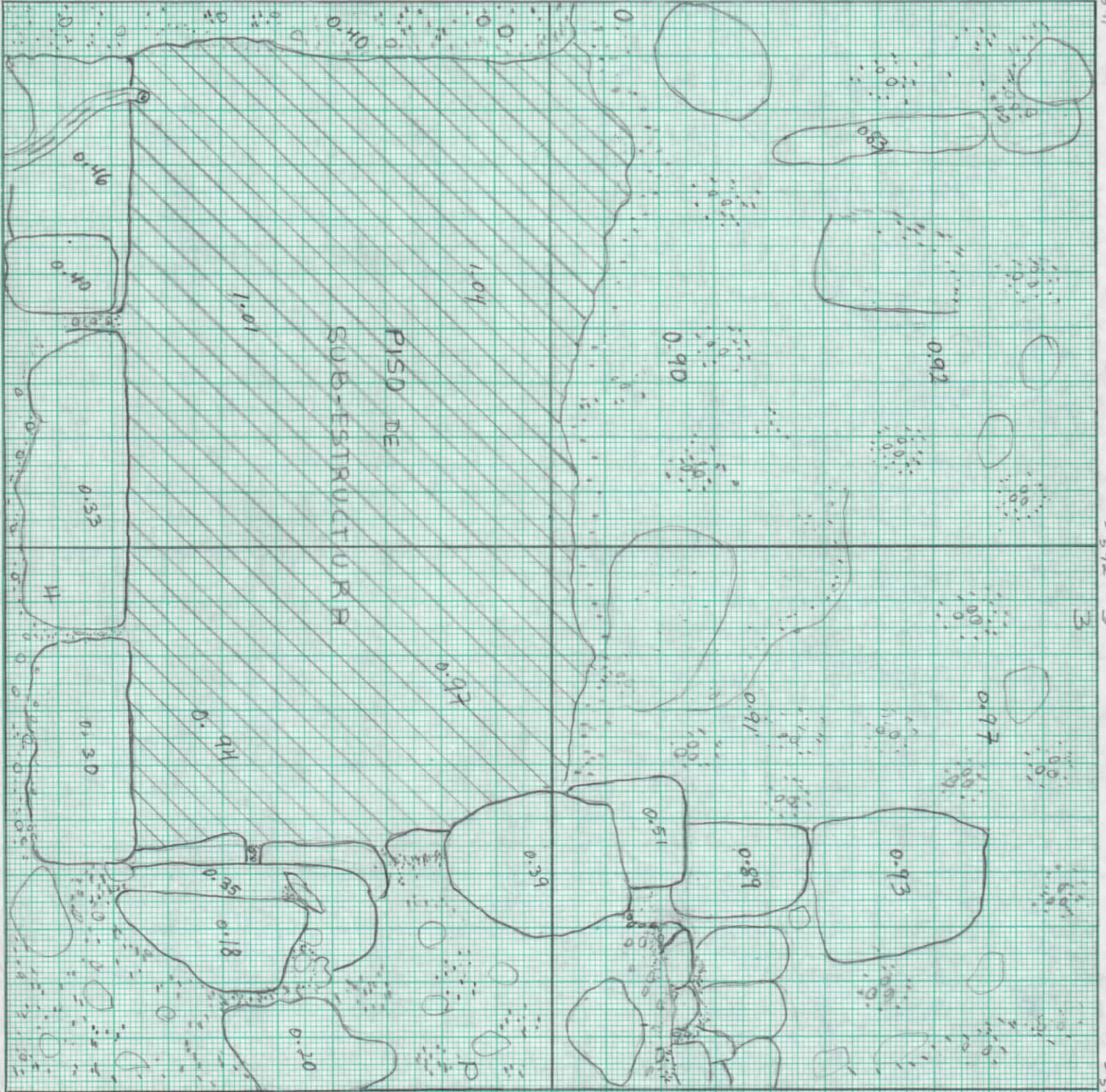

PISO DE  
SUB-ESTRUCTURA

BITI02: ZACPETEN  
PLANTA: STR. 606  
M 51  
22-5-97



531/593

P

P

4

3

3

531/591

531/592

531/593

533/591

533/593



SITIO: ZHAKPETEM  
 PLANITA STR. 6006  
 ESC. 1:10  
 M.S.  
 22-5-97

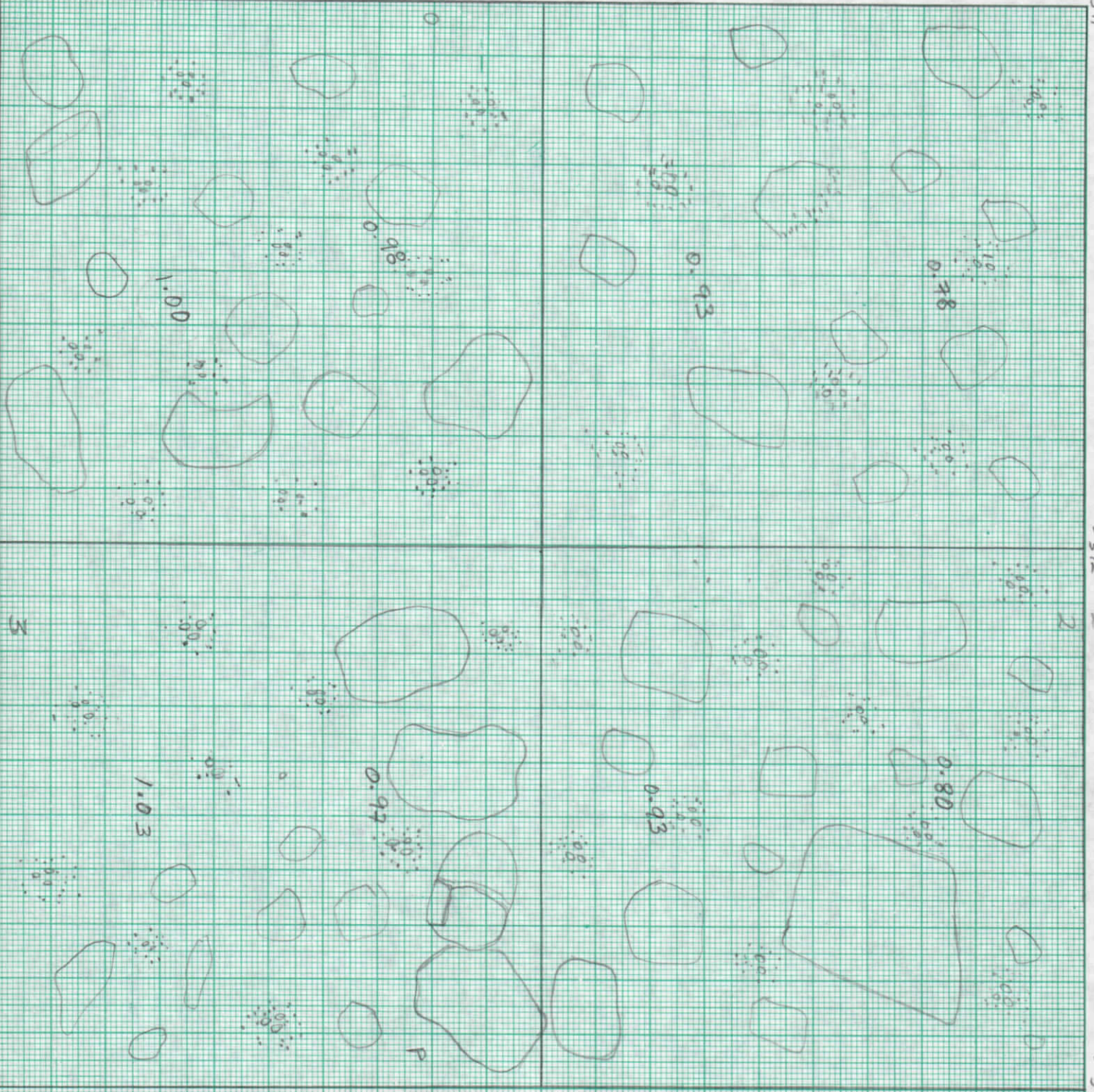

P P

532/591

532/592

532/593

3

3

3

3

530/591

530/592

1

530/593

535

535

SITIO: ZARZAPLEN  
 PLANTA STR. 606  
 ESC. 1:10  
 M S  
 22-5-97

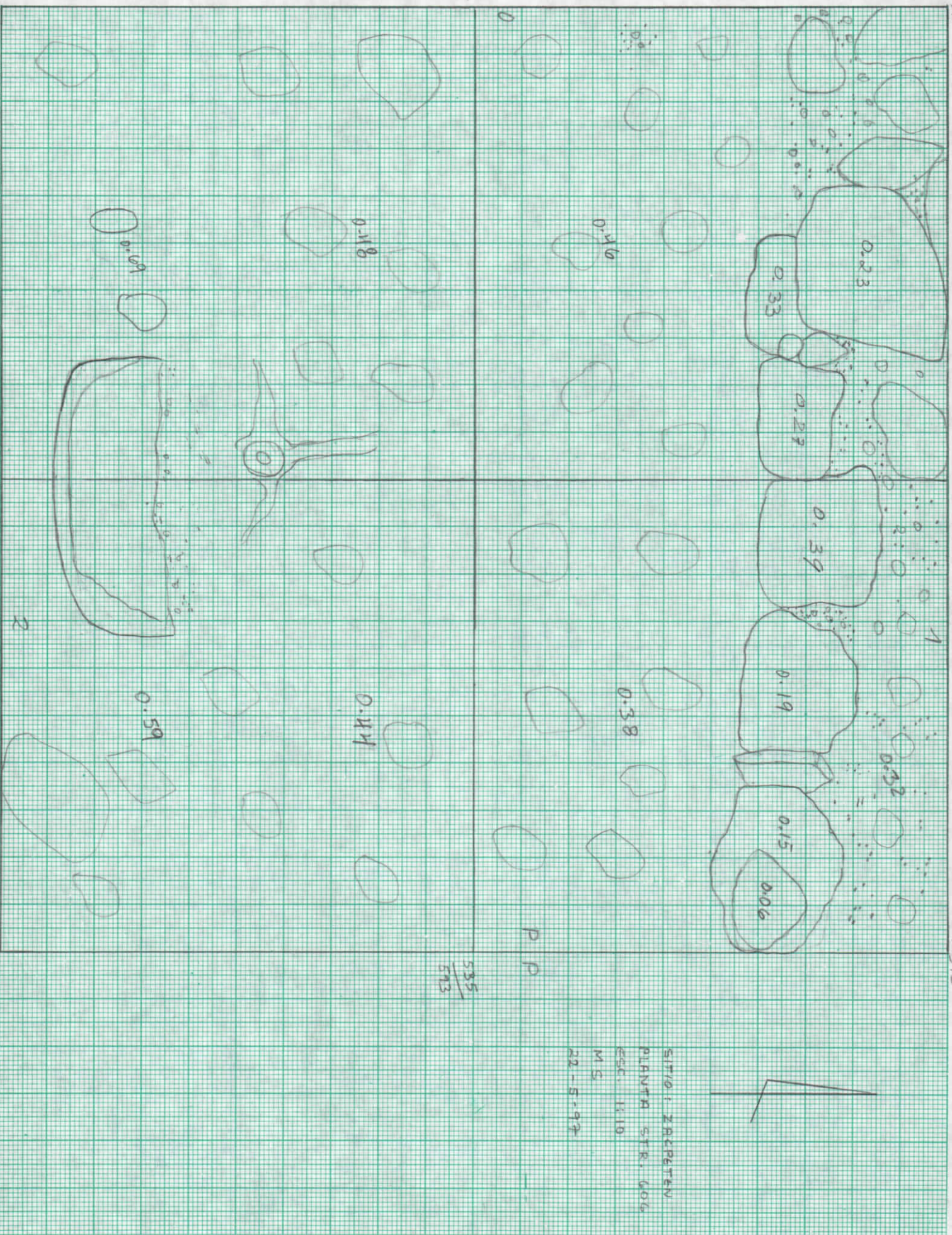

P P

534

534

2

531

531  
 593

536/591  
535/589  
534/590  
533/591

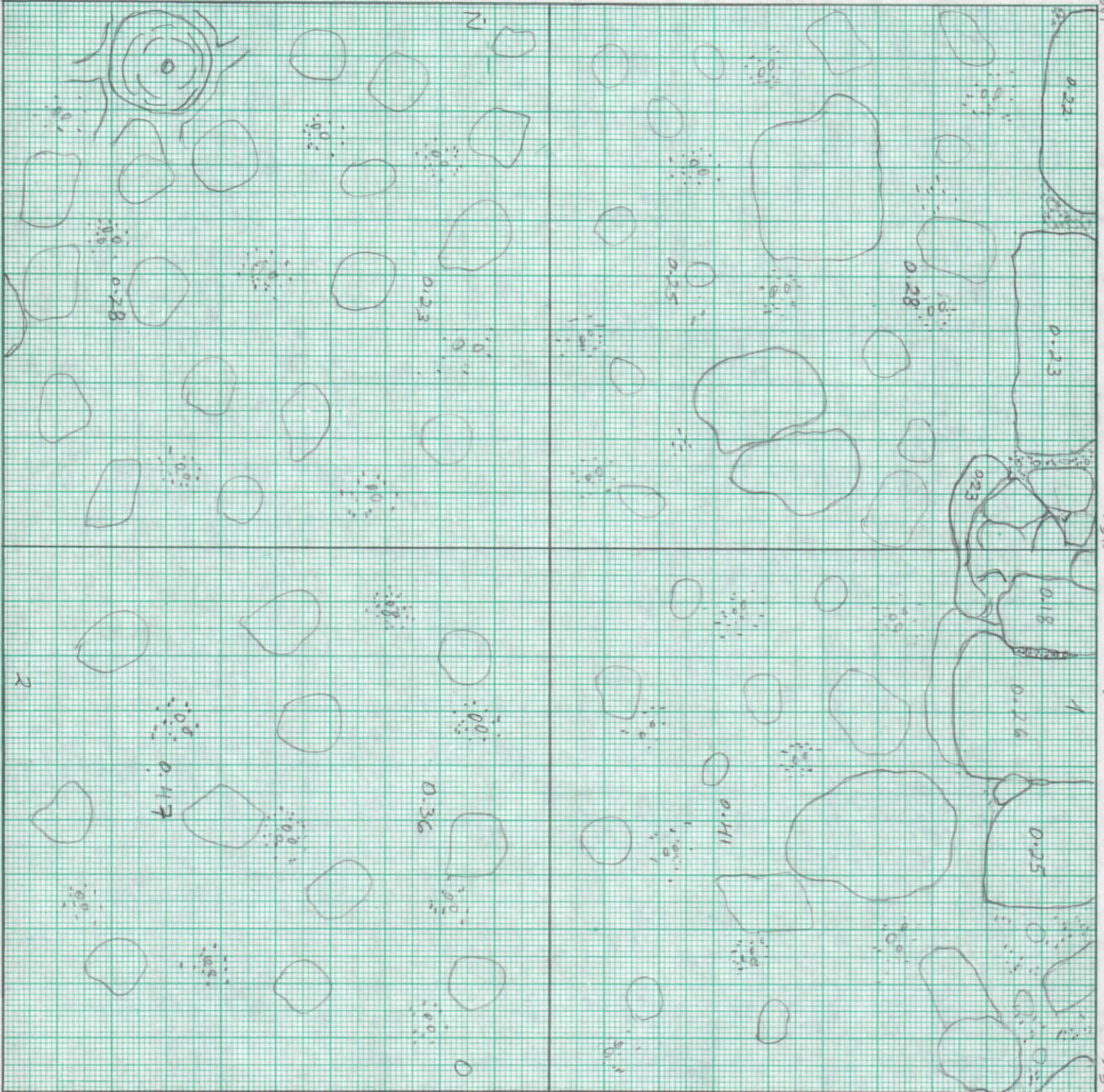

SITIO: ZACAPETEN  
PLANIA STR. 606  
ESC. 1:10  
MS  
21-5-99

536/591  
535/591  
534/590  
533/591  
1  
2  
536/591  
535/591  
534/590  
533/591

532  
524

533  
589

535  
585

532  
540

531  
545

532  
541

531  
541

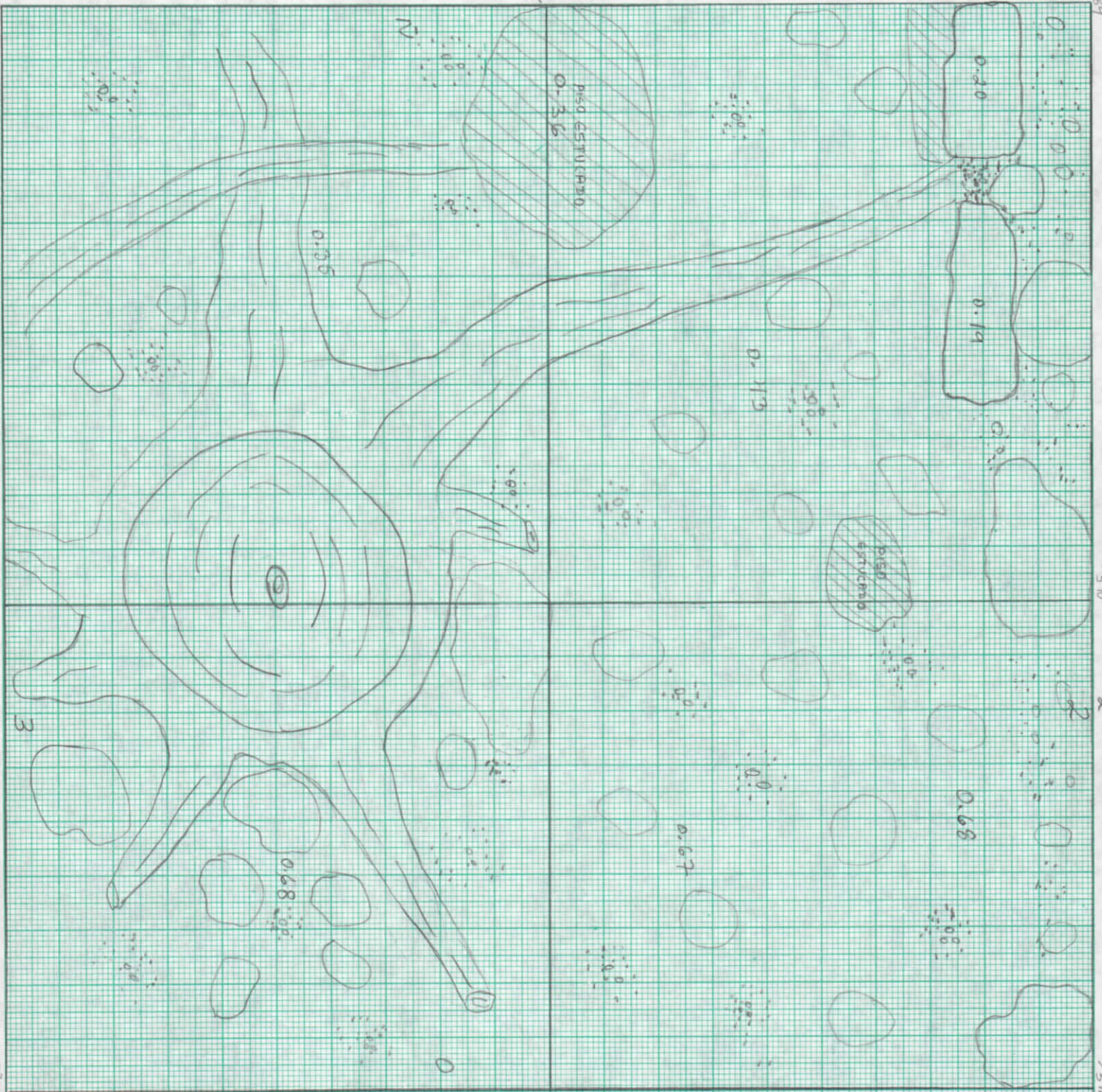

SITIO: ZACATECAN  
 PLANITA STR. 606  
 ESC. 1110  
 M.S.  
 21-5-99



530/589

530/590 3

530/591

531/589

N

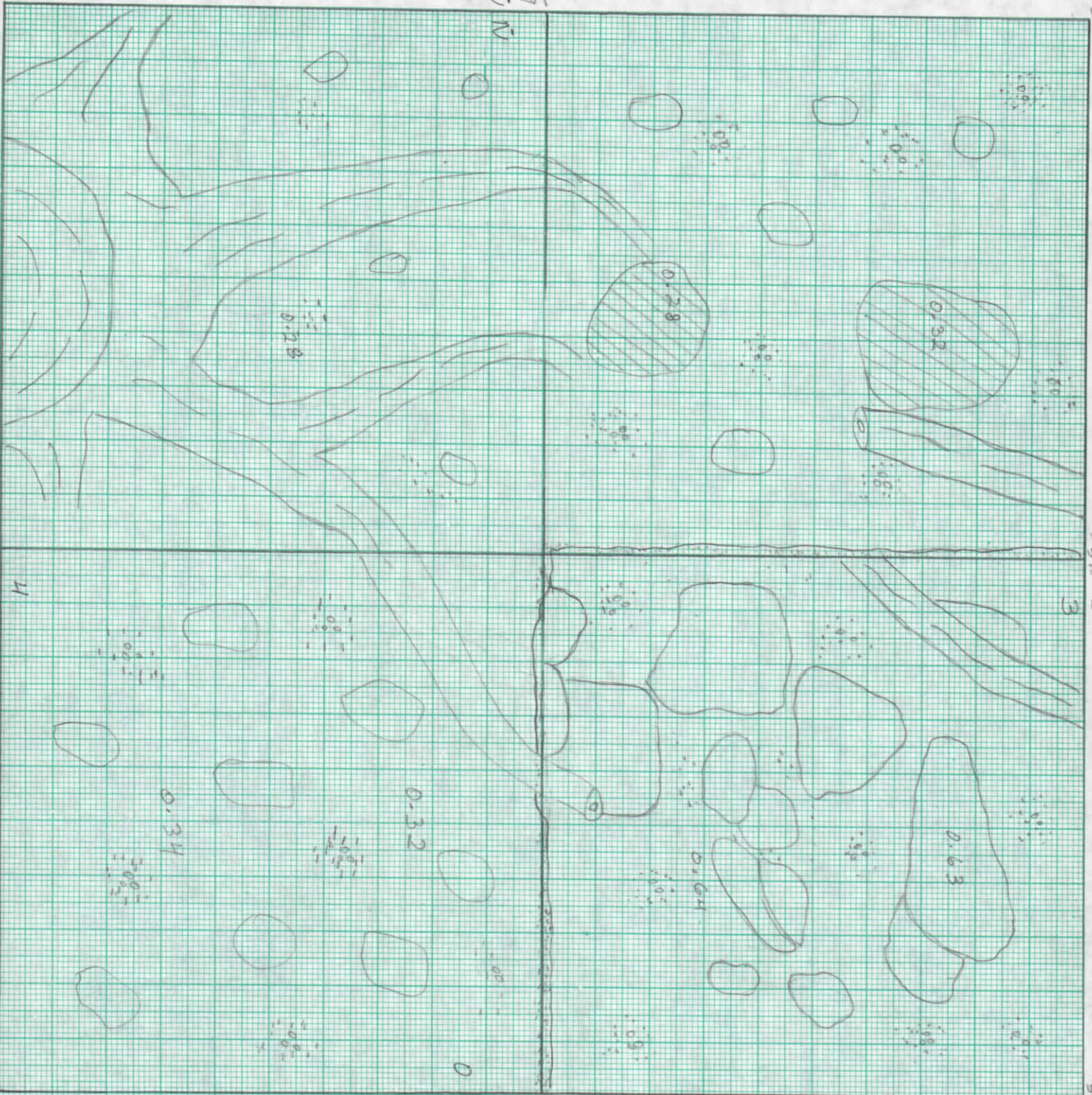

SITIO: ZACRETELN  
 PLANTA STR. 606  
 ESC. 1:10  
 MS  
 21-5-97

531/591

0 0

0.32

0.34

0.63

0.64

0.28

0.32

0.28

530/589

530/590

4

530/591



536/582

536/588 1

536/589

533/587

N

N

N

N

535/589

534/582

534/588 2

534/589

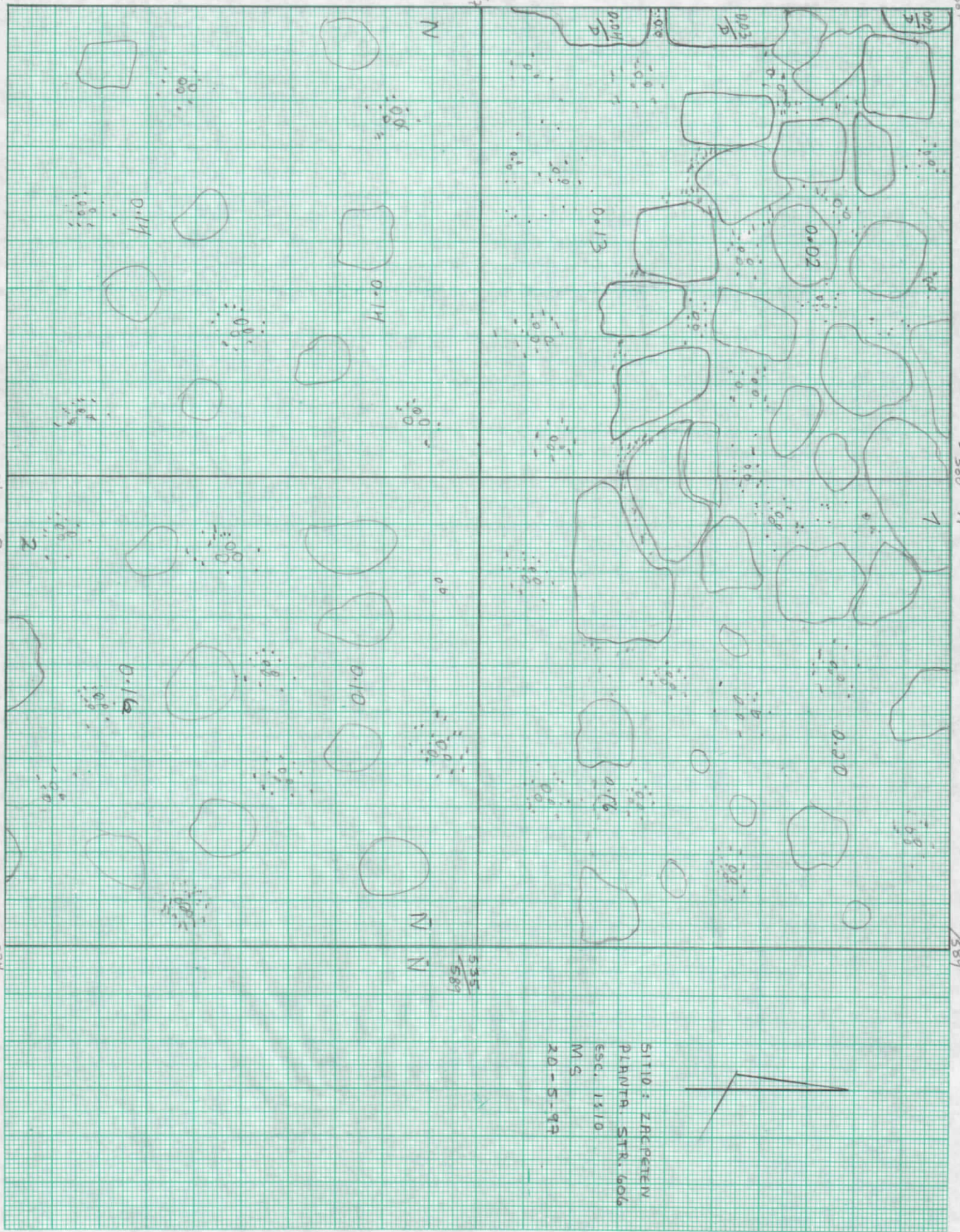

SITIO: ZRCPETEN  
 PLANTA STR. 606  
 ESC. 1x10  
 M5  
 20-5-99

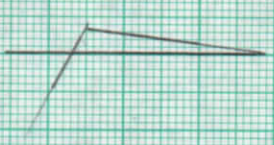

530/589

530/588

530/589

531/589

531/589

532/589

532/588

534/589

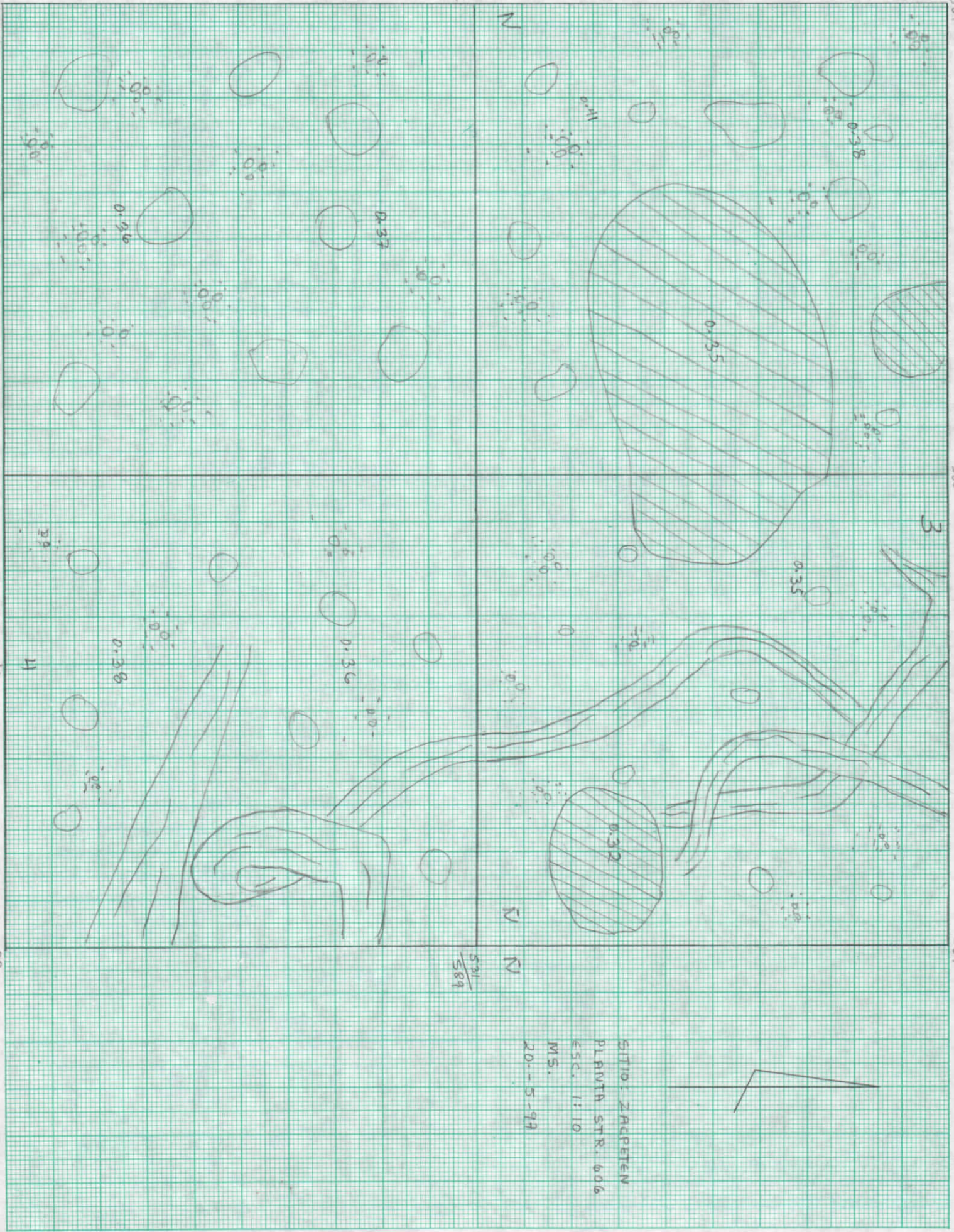

SITIO: ZACRETEN  
 PLANTA STR. 606  
 ESC. 1:10  
 M.S.  
 20-5-99

536/585

536/586

536/582

M  
535  
585

535  
587

534/585

534/586

534/587

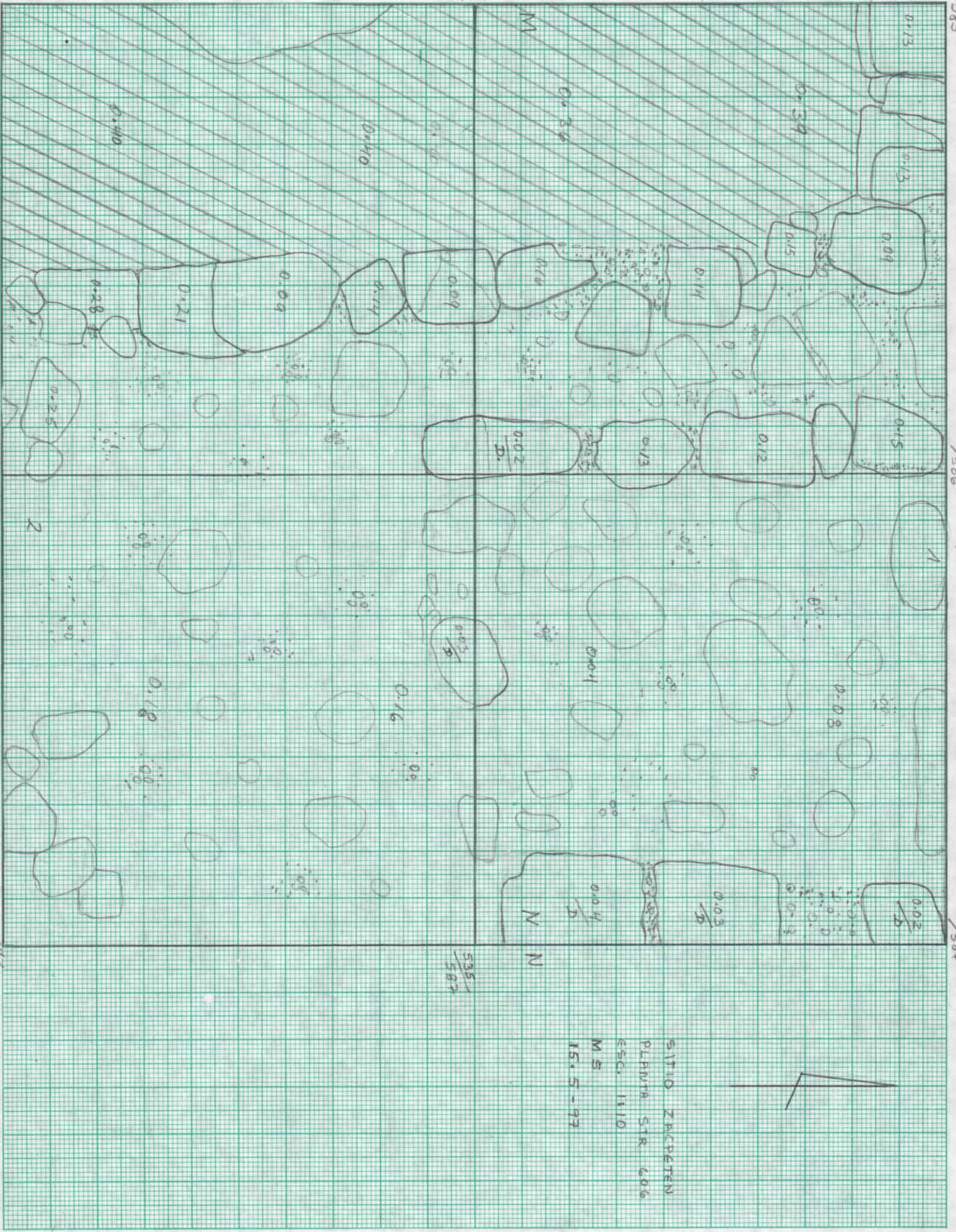

SITIO ZACRETTEN  
 PLANTA STR 606  
 ESC. 1:100  
 M S  
 15.5-93



533/585

533/586

533/587

533/585

M

M

M

M

M

M

M

M

M

M

M

M

M

M

M

M

M

M

M

M

M

M

M

M

M

M

M

M

M

M

M

M

M

M

M

N

N

N

N

N

N

N

N

N

N

N

N

N

N

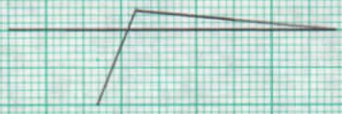
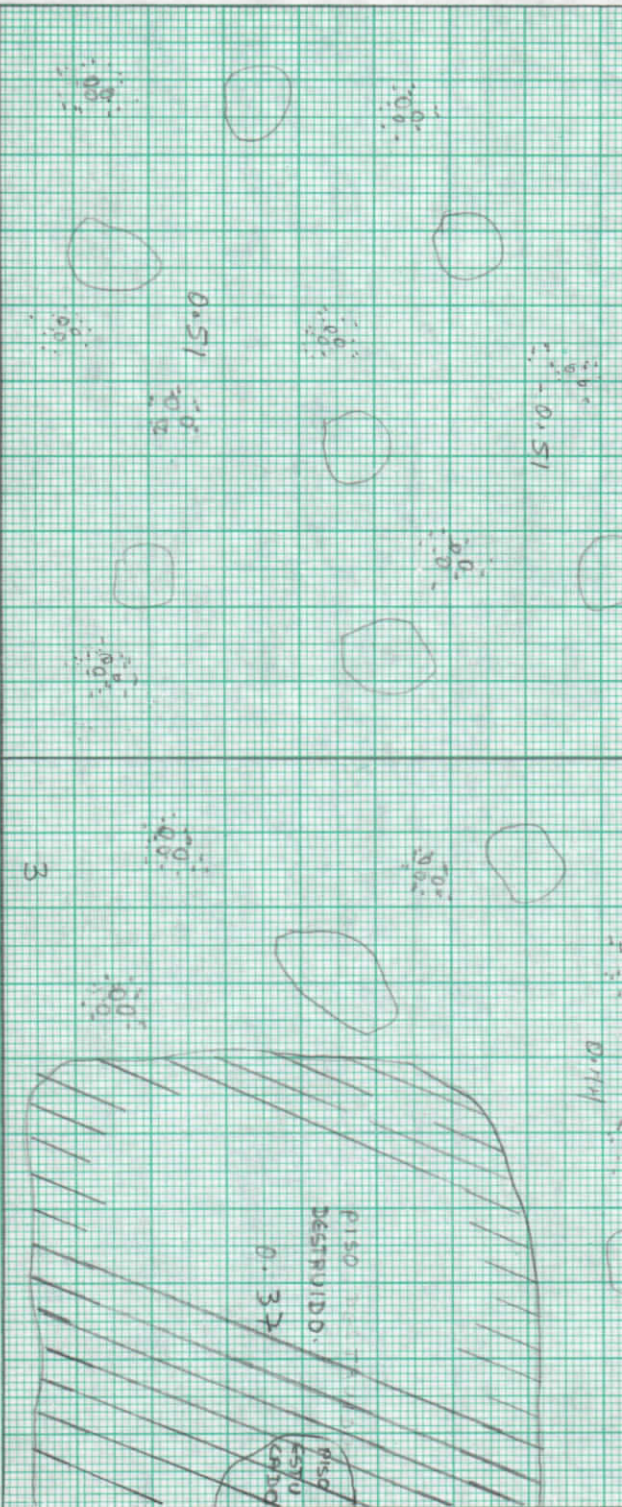
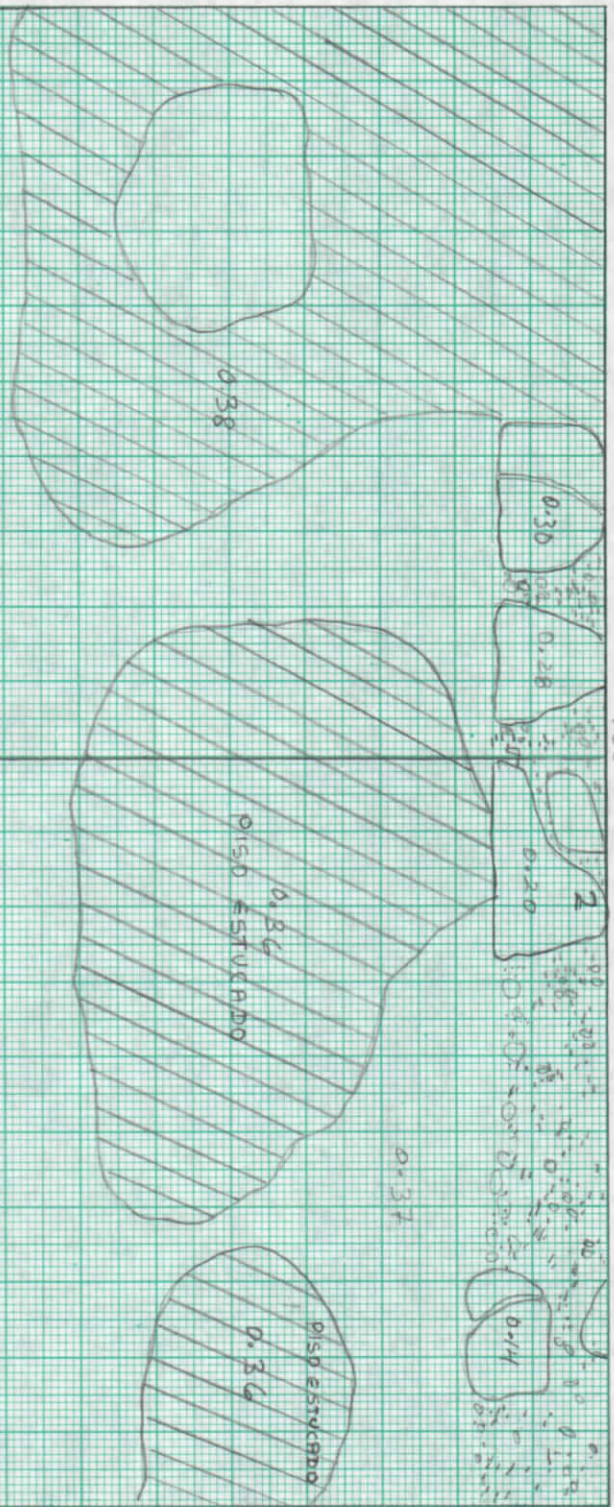

SITIO: ZARPETEN  
 PLANTA STR. 606  
 ESC. 1:10  
 MS  
 15-5-99

533/587

533/585

533/586

533/587

M

M

M

M

M

M

M

M

M

M

M

M

M

M

M

M

M

M

M

M

M

M

M

M

M

M

M

M

M

M

M

M

M

M

M

N

N

N

N

N

N

N

N

N

N

N

N

N

N

532/585

532/586

532/587

530/585

530/586

530/587

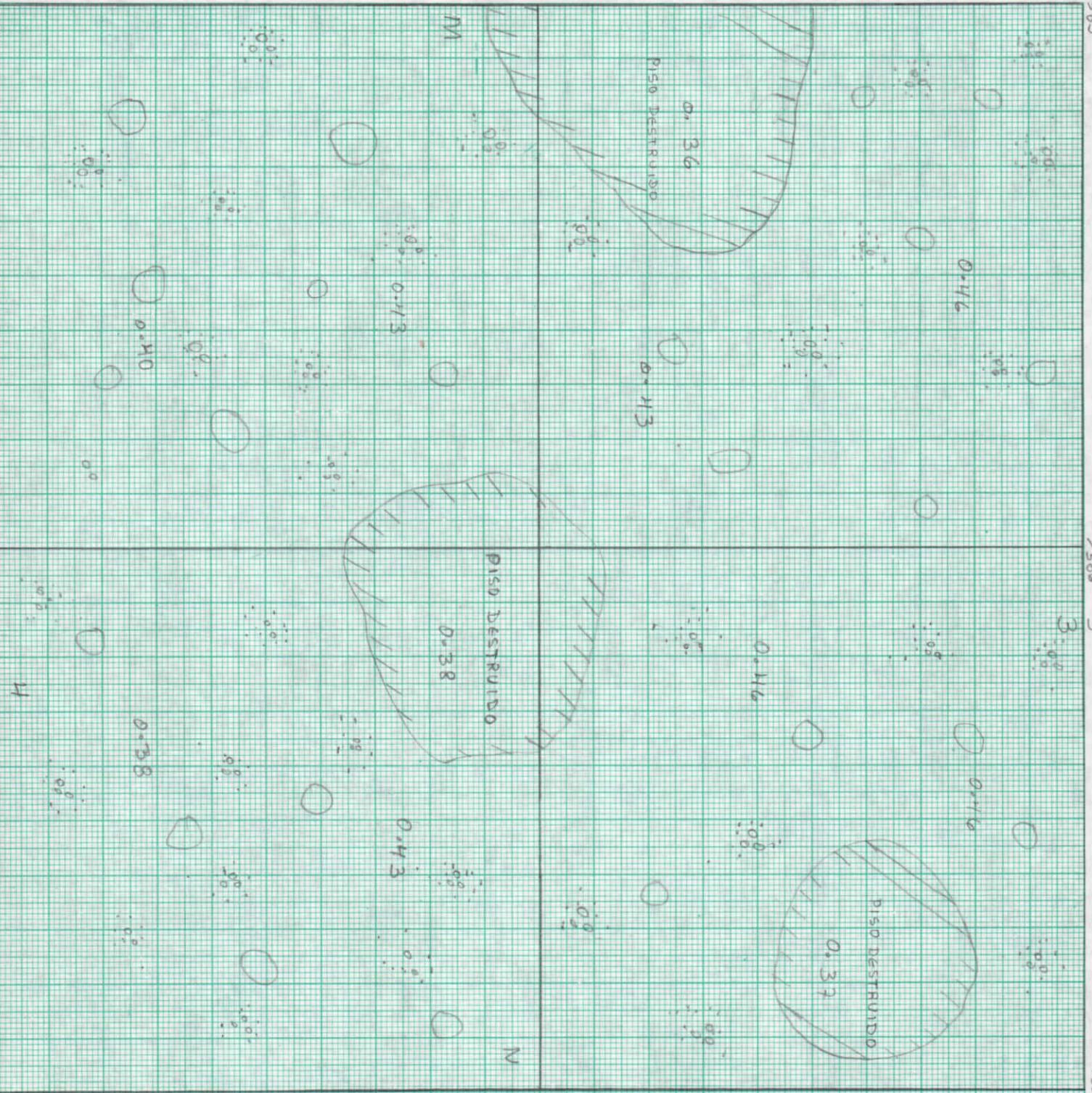

SITIO ZARZETEN  
 PLANTA STR. 606  
 ESC. 1510  
 M5  
 15.5.97

534/583

534/584

534/585

0.22  
0.20  
0.26  
0.19  
0.12  
0.12  
0.16  
0.18  
0.09

0.11

0.10

0.10

0.50  
0.58  
OVERMAN

0.10

0.10

0.38

0.39

0.11

0.39

ENTID ZACREPTEN  
PURNIRI STR. 606  
ESC. 1110  
15-5-97



M  
535  
585  
M

7

535  
583

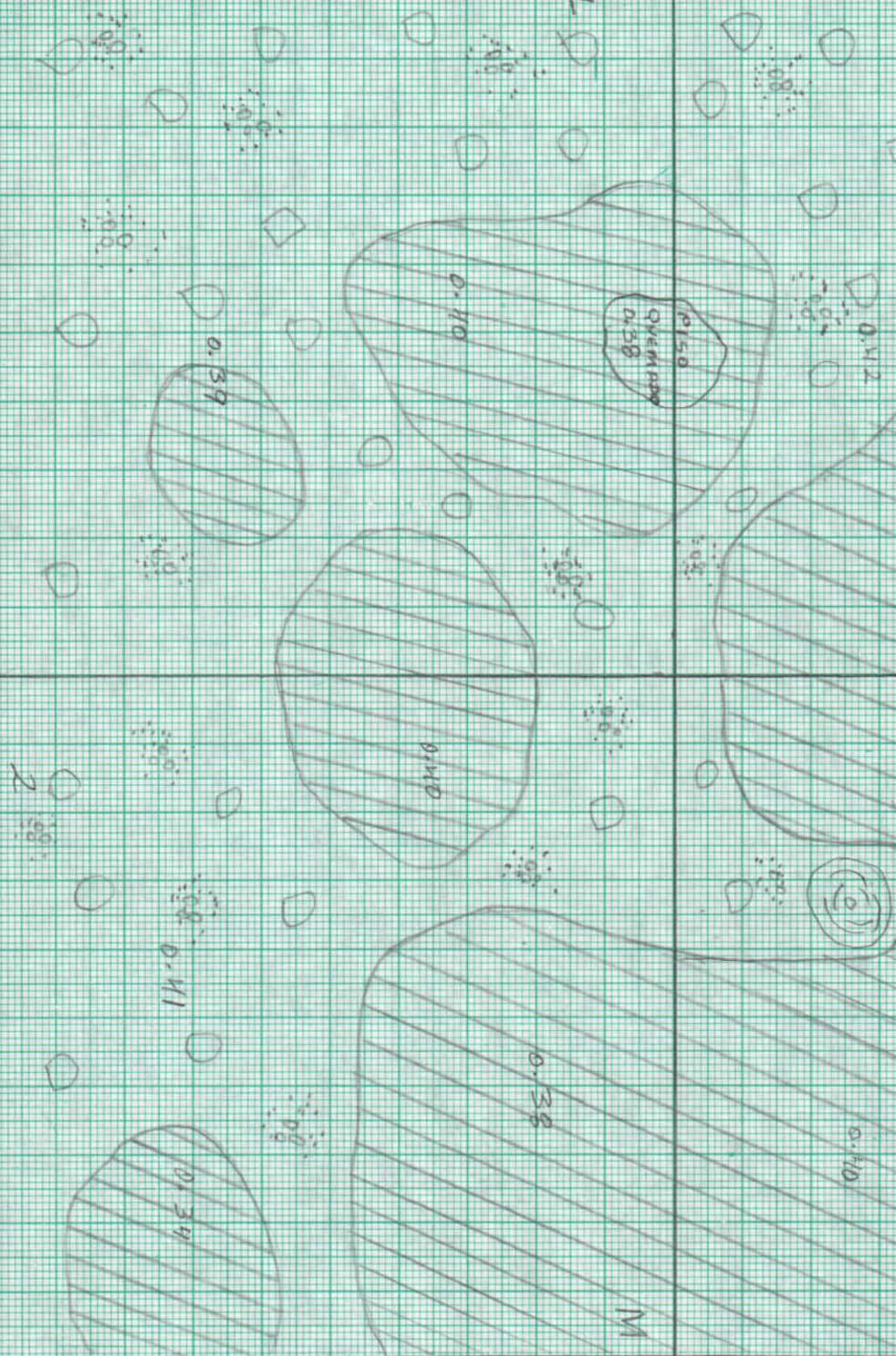

534/583

534/584

534/585

2

1

533/583

533/581

2

534/585

532/583

532/581

2

532

533

583

L

L

M

M

533  
585

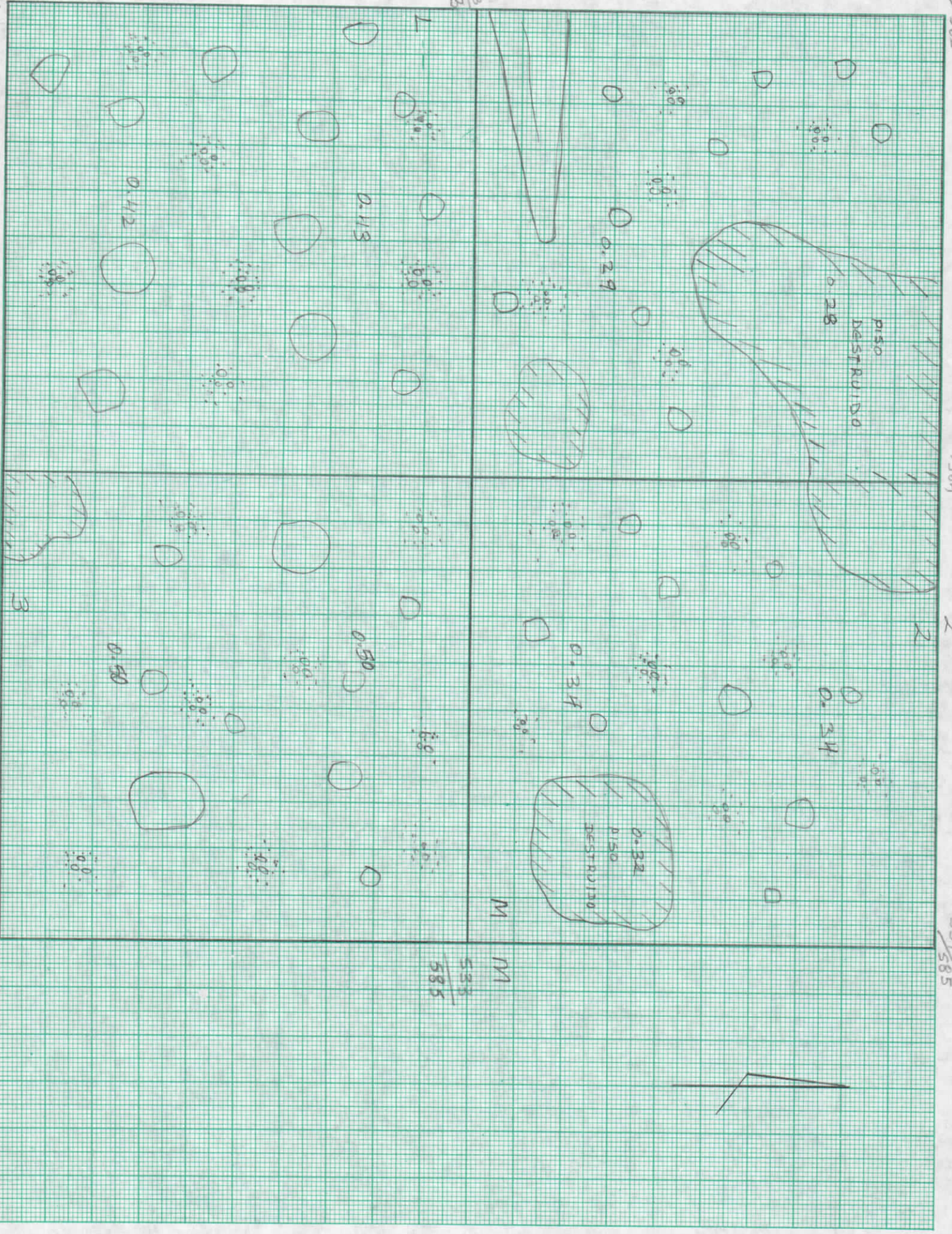

532/583

532/584

3

532/585

531/583

531/585

530/583

530/584

4

530/585

